

API NO. 35-129-23121
 OTC PROD. UNIT NO. 129-120046

Rule 165-10-3-25
 ORIGINAL
 AMENDED
 Reason Amended _____

COMPLETION REPORT
 OKLAHOMA CORPORATION COMMISSION
 Oil & Gas Conservation Division
 Post Office Box 52000
 Oklahoma City, Oklahoma 73152-2000

Form 1002A
 Rev. 2001

404-OSWG 703082013

PLEASE TYPE OR USE BLACK INK ONLY

NOTE: Attach copy of original 1002A if recompletion or reentry
 TYPE OF DRILLING OPERATION

STRAIGHT HOLE DIRECTIONAL HOLE HORIZONTAL HOLE

If directional or horizontal, see reverse for bottom hole location.

COUNTY Roger Mills	SEC 10	TWP 14N	RGE 24W
LEASE NAME B&W Leon	WELL NO. 1-10		
SHL NE SE 1/4 NW 1/4 SE 1/4			
ELEVATION Derrick Fl Ground		1850' FSL	995' FWL OF 1/4 SEC
DRLG FINISHED 10/24/06		SPUD DATE 9/22/2006	
1ST PROD DATE 12-20-06		WELL COMPLETION 2-1-07	
RECOMP DATE			

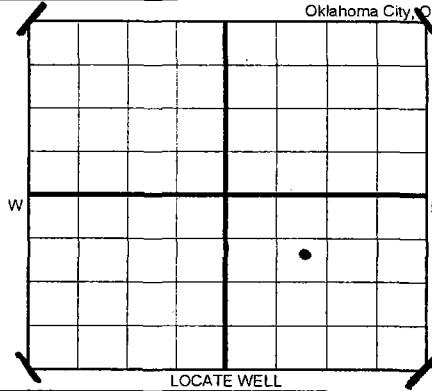

FORMATION	Oswego		
SPACING & SPACING ORDER NUMBER	640: #153835		
CLASS: Oil, Gas, Dry, Inj, Disp, Comm Disp	Oil		
PERFORATED INTERVALS	11250'-289'		
ACID/VOLUME Fracture Treated?	YES		
Fluids Amounts	2532 bbl linear gel		

OPERATOR NAME B&W Operating, L.L.C.	OTC/OCC OPERATOR NO. 21277-0
ADDRESS 100 Park Ave., Suite 1020	
CITY Oklahoma City	STATE OK
	ZIP 73102

<input checked="" type="checkbox"/> SINGLE ZONE
MULTIPLE ZONE ORDER NO.
COMMINGLED ORDER NO.
LOCATION EXCEPTION ORDER NO.
INCREASED DENSITY ORDER NO.
PENALTY

OIL OR GAS ZONES FORMATIONS	TOP	BOTTOM
Oswego	11186'	11300'

CASING & CEMENT (Form 1002C must be attached)	TYPE	SIZE	WEIGHT	GRADE	FEET	PSI	SAX	FILLUP	TOP
Conductor	20"				42'		9 sks grout		surface
Surface	9 5/8"	36#	J55	1525'		680			surface
Intermediate									
Production	5 1/2"	17#	P110	11536'		490			8050'
Liner									

PACKER @ _____ BRAND & TYPE _____ TOTAL DEPTH 12,000'

PLUG @ _____ TYPE _____

INITIAL TEST DATA	12/19/06		
INITIAL TEST DATE	12/19/06		
OIL-BBL/DAY	75 bbls		
OIL-GRAVITY (API)			
GAS-MCF/DAY	259 mcf		
GAS-OIL RATIO CU FT/BBL	3453		
WATER-BBL/DAY	16 bbls		
PUMPING OR FLOWING	flowing		
INITIAL SHUT-IN PRESSURE	2700#		
CHOKE SIZE	10/64"		
FLOW TUBING PRESSURE	770#		

A record of the formations drilled through, and pertinent remarks are presented on the reverse. I declare that I have knowledge of the contents of this report and am authorized by my organization to make this report, which was prepared by me or under my supervision and direction, with the data and facts stated herein to be true, correct, and complete to the best of my knowledge and belief.

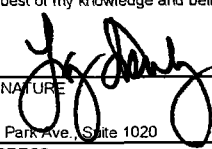
SIGNATURE  NAME (PRINT OR TYPE) Larry Fenity

100 Park Ave., Suite 1020 ADDRESS Oklahoma City OK 73102
 CITY STATE ZIP

DATE 3/1/07 PHONE NUMBER (405) 236-1807

PLEASE TYPE OR USE BLACK INK ONLY
FORMATION RECORD

Give formation names and tops, if available, or descriptions and thickness of formations drilled through. Show intervals cored or drillstem tested.

LEASE NAME B&W Leon WELL NO. 1-10

NAMES OF FORMATIONS	TOP	BOTTOM
Tonkawa	8735'	
Cottage Grove	9540'	
Cleveland	10386'	
Oswego	11186'	
Prue	11630'	

FOR COMMISSION USE ONLY	
APPROVED <u>[Signature]</u>	DISAPPROVED
	1) ITD Section
	a) No Intent to Drill on file
	1) Send warning letter _____
	2) Recommend for contempt _____
	2) Reject Codes

Were open hole logs run? yes no

Date Last log was run 6/6/06

Was CO₂ encountered? yes no at what depths?

Was H₂S encountered? yes no at what depths?

Were unusual drilling circumstances encountered? yes no
If yes, briefly explain.

Other remarks:

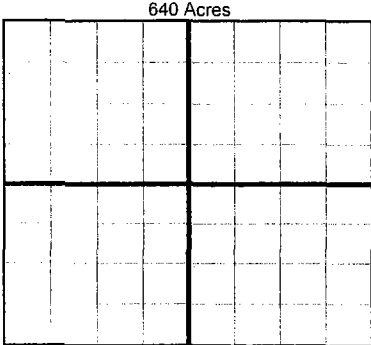

BOTTOM HOLE LOCATION

SEC	TWP	RGE	COUNTY
Spot Location	Feet From Quarter Section Lines		
1/4	1/4	1/4	1/4
Measured Total Depth	True Vertical Depth	BHL From Lease, Unit, or Property Line:	

BOTTOM HOLE LOCATION FOR HORIZONTAL HOLE: (DRAINHOLES)

DRAINHOLE #1

SEC	TWP	RGE	COUNTY
Spot Location	Feet From Quarter Section Lines		
1/4	1/4	1/4	1/4
Depth of Deviation	Radius of Turn	Direction	Total Length
Measured Total Depth	True Vertical Depth	End Pt Location From Lease, Unit or Property Line:	

If more than two drainholes are proposed, attach a separate sheet indicating the necessary information.

Direction must be slated in degrees azimuth.

Please note, the horizontal drainhole and its end point must be located within the boundaries of the lease or spacing unit.

Directional surveys are required for all drainholes and directional wells.

DRAINHOLE #2

SEC	TWP	RGE	COUNTY
Spot Location	Feet From Quarter Section Lines		
1/4	1/4	1/4	1/4
Depth of Deviation	Radius of Turn	Direction	Total Length
Measured Total Depth	True Vertical Depth	End Pt Location From Lease, Unit or Property Line:	