

Oklahoma Corporation Commission
Oil & Gas Conservation Division
Post Office Box 52000
Oklahoma City, Oklahoma 73152-2000
Rule 165: 10-3-25

Form 1002A

API No.: 35017242150000

Completion Report

Spud Date: October 24, 2010

OTC Prod. Unit No.: 017-204854

Drilling Finished Date: December 19, 2010

1st Prod Date: March 03, 2011

Completion Date: March 04, 2011

Drill Type: HORIZONTAL HOLE

Min Gas Allowable: Yes

Well Name: HAYS RANCH 1-5H

Purchaser/Measurer: CIMAREX ENERGY

Location: CANADIAN 5 11N 9W
N2 NE NE NE
200 FNL 330 FEL of 1/4 SEC
Latitude: 35.463917 Longitude: -98.167611
Derrick Elevation: 0 Ground Elevation: 1340

First Sales Date: 03/03/2011

Operator: CIMAREX ENERGY CO 21194

15 E 5TH ST STE 1000
TULSA, OK 74103-4311

Completion Type	
X	Single Zone
	Multiple Zone
	Commingled

Location Exception	
Order No	
589974	

Increased Density	
Order No	
There are no Increased Density records to display.	

Casing and Cement							
Type	Size	Weight	Grade	Feet	PSI	SAX	Top of CMT
CONDUCTOR	20			80		12	SURFACE
SURFACE	13 3/8	54.5	J-55	1515	3000	940	SURFACE
INTERMEDIATE	9 5/8	40	P-110	10900	5000	530	8680
PRODUCTION	5 1/2	23	P-110	18271	6000	1610	10300

Liner								
Type	Size	Weight	Grade	Length	PSI	SAX	Top Depth	Bottom Depth
There are no Liner records to display.								

Total Depth: 18271

Packer	
Depth	Brand & Type
There are no Packer records to display.	

Plug	
Depth	Plug Type
There are no Plug records to display.	

Initial Test Data										
Test Date	Formation	Oil BBL/Day	Oil-Gravity (API)	Gas MCF/Day	Gas-Oil Ratio Cu FT/BBL	Water BBL/Day	Pumpin or Flowing	Initial Shut-In Pressure	Choke Size	Flow Tubing Pressure
Mar 09, 2011	WOODFORD			1997		376	FLOWING		10/64	

Completion and Test Data by Producing Formation		
Formation Name: WOODFORD	Code: 319WDFD	Class: GAS
Spacing Orders		Perforated Intervals
Order No	Unit Size	From To
562652	640	12959 17991
Acid Volumes		Fracture Treatments
There are no Acid Volume records to display.		249,201 - 10 POUNDS LINEAR, 2,804,300 SLICKWATER; 209,917 - 100 POUNDS WHITE SAND, 2,281,929 - 100 POUNDS PROPSTAR

Formation	Top
TONKAWA	7588
MARCHAND LIME	8672
CLEVELAND SAND	9452
VERDIGRIS LIME	10142
RED FORK	10486
NOVI LIME	10858
CHESTER LIME	11280
WOODFORD SHALE	12940

Were open hole logs run? No

Date last log run:

Were unusual drilling circumstances encountered? No

Explanation:

Other Remarks
There are no Other Remarks.

Lateral Holes

Sec: 5 TWP: 11N RGE: 9W County: CANADIAN

SE SE SE SE

7 FSL 295 FEL of 1/4 SEC

Depth of Deviation: 12600 Radius of Turn: 479 Direction: 179 Total Length: 4959

Measured Total Depth: 18271 True Vertical Depth: 13077 End Pt. Location From Release, Unit or Property Line: 7

FOR COMMISSION USE ONLY

1110205

Status: Accepted

API NO. 017-24215
 OTC PROD. UNIT NO. 017-204854

PLEASE TYPE OR USE NOTE:
 Attach copy of original



COMMISSION
 Division
 152-2000
 PORT

RECEIVED
 APR 26 2011
 OKLAHOMA CORPORATION COMMISSION
 640 Acres

ORIGINAL
 AMENDED (Reason)

TYPE OF DRILLING OPERATION
 STRAIGHT HOLE DIRECTIONAL HOLE HORIZONTAL HOLE
 SERVICE WELL

SPUD DATE 10-24-10
 DRILG FINISHED DATE 12-19-10

If directional or horizontal, see reverse for bottom hole location.
 COUNTY Canadian SEC 5 TWP 11N RGE 9W
 LEASE NAME Hays Ranch WELL NO. 1-5H
 N2 1/4 NE 1/4 NE 1/4 NE 1/4 FNL 200 FEL 1/4 SEC 330
 ELEVATION Ground 1340 Latitude (if known) 35.463917 Longitude (if known) -98.167611
 OPERATOR NAME Cimarex Energy Co. (attn: Aricka Easterling) OTC/OCC OPERATOR N 21194-0
 ADDRESS 15 E. 5th Street, Suite 1000
 CITY Tulsa STATE OK ZIP 74103

DATE OF WELL COMPLETION 3-4-11
 1st PROD DATE 3-3-11
 RECOMP DATE N/A

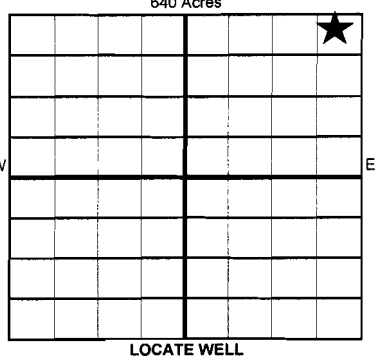

COMPLETION TYPE
 SINGLE ZONE
 MULTIPLE ZONE
 COMMINGLED
 LOCATION 578874
 EXCEPTION ORDER
 INCREASED DENSITY ORDER NO

CASING & CEMENT (Form 1002C must be attached)

TYPE	SIZE	WEIGHT	GRADE	FEET	PSI	SAX	TOP OF CMT	
CONDUCTOR	20"			80'			Surface	
SURFACE	13 3/8"	54.5#	J-55	1,515'	3000	940	Surface	
INTERMEDIATE	9 5/8"	40#	P-110	10,900'	5000	530	8,680'	
PRODUCTION	5 1/2"	23#	P-110	18,271'	6000	1610	10,300'	
LINER								
							TOTAL DEPTH	18,271'

PACKER @ _____ BRAND & TYPE _____ PLUG @ _____ TYPE _____ PLUG @ _____ TYPE _____
 PACKER @ _____ BRAND & TYPE _____ PLUG @ _____ TYPE _____ PLUG @ _____ TYPE _____

COMPLETION & TEST DATA BY PRODUCING FORMATION *319WDFD*

FORMATION	Woodford	Woodford			
SPACING & SPACING ORDER NUMBER	640/ 562652	640/ 562652			
CLASS: Oil, Gas, Dry, Inj, Disp, Comm Disp, Svc	Gas	Gas			
PERFORATED INTERVALS	12,959'-17,991'	12,959'- 17,991'			
ACID/VOLUME					
FRACTURE TREATMENT (Fluids/Prop Amounts)	249,201-10# Linear 2,804,300 - Slickwater	209,917 - 100# White Sand 2,281,929 - 100# Propstar			

Min Gas Allowable (165:10-17-7) OR Oil Allowable (165:10-13-3)
 Gas Purchaser/Measurer Cimarex Energy
 First Sales Date 3/3/2011

INITIAL TEST DATA

INITIAL TEST DATE	3/9/2011			
OIL-BBL/DAY	0			
OIL-GRAVITY (API)	0			
GAS-MCF/DAY	1997			
GAS-OIL RATIO CU FT/BBL	0			
WATER-BBL/DAY	376			
PUMPING OR FLOWING	flowing			
INITIAL SHUT-IN PRESSURE	N/A			
CHOKE SIZE	10/64			
FLOW TUBING PRESSURE	N/A			

A record of the formations drilled through, and pertinent remarks are presented on the reverse. I declare that I have knowledge of the contents of this report and am authorized by my organization to make this report, which was prepared by me or under my supervision and direction, with the data and facts stated herein to be true, correct, and complete to the best of my knowledge and belief.

Aricka Easterling
 SIGNATURE Aricka Easterling 4/21/2011 918-560-7060
 15 E. 5th Street, Suite 1000 Tulsa OK 74103
 ADDRESS CITY STA ZIP aeasterling@cmarex.com
 EMAIL ADDRESS

PLEASE TYPE OR USE BLACK INK ONLY

FORMATION RECORD

Give formation names and tops, if available, or descriptions and thickness of formations drilled through. Show intervals cored or drillstem tested.

NAMES OF FORMATIONS	TOP
Tonkawa	7,588'
Marchand LM	8,672'
Cleveland Sand	9,452'
Verdigris LM	10,142'
Red Fork	10,486'
Novi Lime	10,858'
Chester Lime	11,280'
Woodford Shale	12,940'

LEASE NAME Hays Ranch WELL NO. 1-5H

FOR COMMISSION USE ONLY	
ITD on file <input type="checkbox"/> YES <input type="checkbox"/> NO	
APPROVED _____ DISAPPROVED _____	2) Reject Codes

Were open hole logs run? ___ yes no

Date Last log was run _____

Was CO₂ encountered? ___ yes no at what depths? _____

Was H₂S encountered? ___ yes no at what depths? _____

Were unusual drilling circumstances encountered? ___ yes no
If yes, briefly explain below _____

Other remarks:

640 Acres

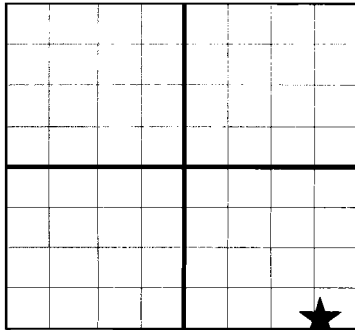

If more than three drainholes are proposed, attach a separate sheet indicating the necessary information.

Direction must be stated in degrees azimuth. Please note, the horizontal drainhole and its end point must be located within the boundaries of the lease or spacing unit

Directional surveys are required for all drainholes and directional wells.

640 Acres

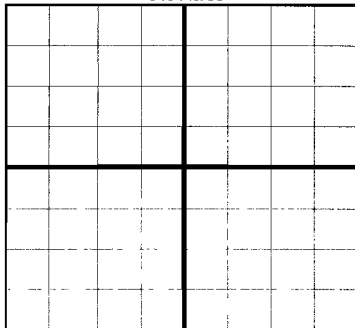

BOTTOM HOLE LOCATION FOR DIRECTIONAL HOLE

SEC	TWP	RGE	COUNTY				
Spot Location	1/4	1/4	1/4	1/4	Feet From 1/4 Sec Lines	FSL	FWL
Measured Total Depth	True Vertical Depth		BHL From Lease, Unit, or Property Line:				

BOTTOM HOLE LOCATION FOR HORIZONTAL HOLE: (LATERALS)

LATERAL #1 *per Final LE order*

SEC	TWP	RGE	COUNTY			
5	11N	9W	Canadian			
Spot Location	SE 1/4	SE 1/4	SE 1/4	Feet From 1/4 Sec Lines	FSL	FEL
Depth of Deviation	12,600'	Radius of Turn	479'	Direction	180.31	Total Length
Measured Total Depth	True Vertical Depth		BHL From Lease, Unit, or Property Line:			
	18,271'		13,077'		78' 7	4959'

LATERAL #2

SEC	TWP	RGE	COUNTY				
Spot Location	1/4	1/4	1/4	1/4	Feet From 1/4 Sec Lines	FSL	FWL
Depth of Deviation	Radius of Turn		Direction				Total Length
Measured Total Depth	True Vertical Depth		BHL From Lease, Unit, or Property Line:				

LATERAL #3

SEC	TWP	RGE	COUNTY				
Spot Location	1/4	1/4	1/4	1/4	Feet From 1/4 Sec Lines	FSL	FWL
Depth of Deviation	Radius of Turn		Direction				Total Length
Measured Total Depth	True Vertical Depth		BHL From Lease, Unit, or Property Line:				