

Oklahoma Corporation Commission
 Oil & Gas Conservation Division
 Post Office Box 52000
 Oklahoma City, Oklahoma 73152-2000
 Rule 165: 10-3-25

Form 1002A

API No.: 35073252200000

Completion Report

Spud Date: December 21, 2015

OTC Prod. Unit No.: 073-217329

Drilling Finished Date: February 22, 2016

1st Prod Date: March 23, 2016

Completion Date: March 22, 2016

Drill Type: HORIZONTAL HOLE

Min Gas Allowable: Yes

Well Name: PEARL 1H-17X

Purchaser/Measurer: NEWFIELD

Location: KINGFISHER 17 16N 7W
 NE NW NW NW
 270 FNL 331 FWL of 1/4 SEC
 Latitude: 35.87034 Longitude: -97.97627
 Derrick Elevation: 1097 Ground Elevation: 1073

First Sales Date: 03/23/2016

Operator: NEWFIELD EXPLORATION MID-CON INC 20944

1 WILLIAMS CTR STE 1900
 TULSA, OK 74172-0162

Completion Type	
X	Single Zone
	Multiple Zone
	Commingled

Location Exception	
Order No	
	642840
	652618

Increased Density	
Order No	
There are no Increased Density records to display.	

Casing and Cement							
Type	Size	Weight	Grade	Feet	PSI	SAX	Top of CMT
SURFACE	13 3/8	40	J-55	1524		765	SURFACE
PRODUCTION	5 1/2	20	P-110	18363	1000	2340	16313

Liner								
Type	Size	Weight	Grade	Length	PSI	SAX	Top Depth	Bottom Depth
There are no Liner records to display.								

Total Depth: 18363

Packer	
Depth	Brand & Type
There are no Packer records to display.	

Plug	
Depth	Plug Type
There are no Plug records to display.	

Initial Test Data										
Test Date	Formation	Oil BBL/Day	Oil-Gravity (API)	Gas MCF/Day	Gas-Oil Ratio Cu FT/BBL	Water BBL/Day	Pumpin or Flowing	Initial Shut-In Pressure	Choke Size	Flow Tubing Pressure
Apr 09, 2016	MISSISSIPPIAN(EX CHESTER)	1373	42	2878	2096	878	FLOWING	900	28	

Completion and Test Data by Producing Formation																
Formation Name: MISSISSIPPIAN(EX CHESTER)	Code: 359MSNLC	Class: OIL														
<table border="1"> <thead> <tr> <th colspan="2">Spacing Orders</th> </tr> <tr> <th>Order No</th> <th>Unit Size</th> </tr> </thead> <tbody> <tr> <td>642257</td> <td>640</td> </tr> <tr> <td>642839</td> <td>MULTIUNIT</td> </tr> </tbody> </table>		Spacing Orders		Order No	Unit Size	642257	640	642839	MULTIUNIT	<table border="1"> <thead> <tr> <th colspan="2">Perforated Intervals</th> </tr> <tr> <th>From</th> <th>To</th> </tr> </thead> <tbody> <tr> <td>8150</td> <td>18268</td> </tr> </tbody> </table>	Perforated Intervals		From	To	8150	18268
Spacing Orders																
Order No	Unit Size															
642257	640															
642839	MULTIUNIT															
Perforated Intervals																
From	To															
8150	18268															
<table border="1"> <thead> <tr> <th colspan="1">Acid Volumes</th> </tr> </thead> <tbody> <tr> <td>30,800 GALLONS 15% HCL</td> </tr> </tbody> </table>		Acid Volumes	30,800 GALLONS 15% HCL	<table border="1"> <thead> <tr> <th colspan="1">Fracture Treatments</th> </tr> </thead> <tbody> <tr> <td>16,747,540 # PROPPANT 59,800 BLW</td> </tr> </tbody> </table>	Fracture Treatments	16,747,540 # PROPPANT 59,800 BLW										
Acid Volumes																
30,800 GALLONS 15% HCL																
Fracture Treatments																
16,747,540 # PROPPANT 59,800 BLW																

Formation	Top
MISSISSIPPIAN	7980
CHESTER	7600
ATOKA	7500

Were open hole logs run? No

Date last log run:

Were unusual drilling circumstances encountered? No

Explanation:

Other Remarks
IRREGULAR SECTION.

Lateral Holes
Sec: 20 TWP: 16N RGE: 7W County: KINGFISHER
SE SW SW SW
87 FSL 469 FWL of 1/4 SEC
Depth of Deviation: 2249 Radius of Turn: 7419 Direction: 360 Total Length: 10150
Measured Total Depth: 18363 True Vertical Depth: 8156 End Pt. Location From Release, Unit or Property Line: 87

FOR COMMISSION USE ONLY
Status: Accepted
1133093

Well Location Plat

M & M Land Surveying, Inc.

520 "E" Street NW. Ardmore, OK. 73401
 Office 580-226-0446 Mobile 580-221-4999 Fax 580-226-7158

Company Name: Newfield Exploration Mid-Continent, Inc. Lease Name: Pearl #1H-17X
 Section 17 Township 16 North Range 7 West County Kingfisher Oklahoma
 Surface Location 270' FNL - 331' FWL Elevation 1073' Good Location? Yes Topography _____

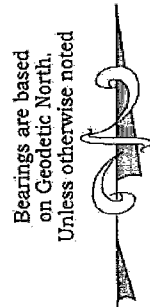
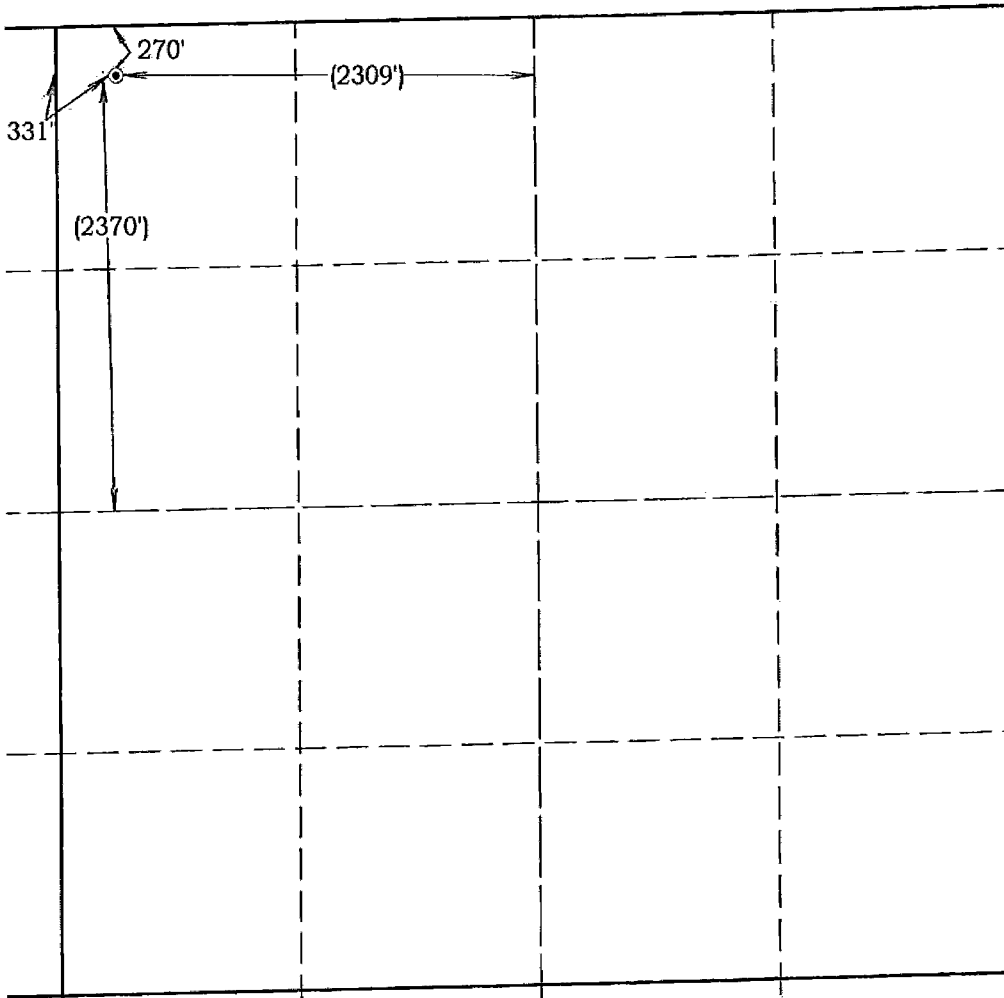

Scale: 1" = 1000'
 Invoice #15409
 Date 10/8/15
 Elevations of Proposed Pad Corners
 NW/C - N/A
 NE/C - N/A
 SE/C - N/A
 SW/C - N/A

Coordinates were derived from GPS RTK methods and are only accurate within ±10 feet

Location GPS NAD 27 Oklahoma North
 Surface Location
 Latitude: 35.87030°
 Longitude: 97.97594°
 Y= 316,796'
 X = 2,007,130'

Location NAD 83 Oklahoma North
 Surface Location
 Latitude: 35.87034°
 Longitude: 97.97627°
 Y= 316,819'
 X = 1,975,531'

Best Accessibility to Location From the North

Distance & Direction From From the Jct. of U.S. #81 and S.H. #33, go 0.7 miles North on US. #81, then 2.5 miles West on county road to the Northwest corner of section 17.
 Highway or Town _____

CERTIFICATE:

I, D. Harry McClintick, a Registered Land Surveyor in the state of Oklahoma, do hereby certify that the above described Well Location was surveyed and staked on the ground as shown.

D. Harry McClintick
 D. Harry McClintick, R.P.L.S. # 1367, CA # 3093

This location has been staked according to the best official survey records available to us, but its accuracy is not guaranteed. Please review this plat and notify us immediately of any discrepancy.

The distances shown in parenthesis () are calculated distances based on the quarter section being 2640' and have not been measured.

