

Oklahoma Corporation Commission
Oil & Gas Conservation Division
Post Office Box 52000
Oklahoma City, Oklahoma 73152-2000
Rule 165: 10-3-25

Form 1002A

API No.: 35151235140002

Completion Report

Spud Date: September 21, 2011

OTC Prod. Unit No.:

Drilling Finished Date: November 10, 2011

Amended

1st Prod Date:

Amend Reason: RECOMPLETION

Completion Date: November 28, 2011

Recomplete Date: August 02, 2016

Drill Type: DIRECTIONAL HOLE

SERVICE WELL

Well Name: CAMPBELL 36-27-13 SWD 1

Purchaser/Measurer:

Location: WOODS 36 27N 13W
N2 NW NW SW
2440 FSL 330 FWL of 1/4 SEC
Derrick Elevation: 1463 Ground Elevation: 1445

First Sales Date:

Operator: CHESAPEAKE OPERATING LLC 17441
PO BOX 18496
6100 N WESTERN AVE
OKLAHOMA CITY, OK 73154-0496

Completion Type	
X	Single Zone
	Multiple Zone
	Commingled

Location Exception
Order No
There are no Location Exception records to display.

Increased Density
Order No
There are no Increased Density records to display.

Casing and Cement							
Type	Size	Weight	Grade	Feet	PSI	SAX	Top of CMT
SURFACE	13 3/8	54.5	J-55	1016		1040	SURFACE
PRODUCTION	9 5/8	40	K-55	6750		790	5850

Liner								
Type	Size	Weight	Grade	Length	PSI	SAX	Top Depth	Bottom Depth
There are no Liner records to display.								

Total Depth: 9055

Packer	
Depth	Brand & Type
6375	ULTRAPAK
6705	BAKER FA-1

Plug	
Depth	Plug Type
6671	CEMENT
6675	CIBP
8059	CEMENT

Initial Test Data										
Test Date	Formation	Oil BBL/Day	Oil-Gravity (API)	Gas MCF/Day	Gas-Oil Ratio Cu FT/BBL	Water BBL/Day	Pumpin or Flowing	Initial Shut-In Pressure	Choke Size	Flow Tubing Pressure
There are no Initial Data records to display.										

Completion and Test Data by Producing Formation										
Formation Name: SIMPSON			Code: 202SMPS				Class: DISP			
Spacing Orders					Perforated Intervals					
Order No		Unit Size			From			To		
There are no Spacing Order records to display.					6428			6597		
Acid Volumes					Fracture Treatments					
3,000 GALLONS 10% ACID					There are no Fracture Treatments records to display.					

Formation	Top
SIMPSON	6422
ARBUCKLE	6701

Were open hole logs run? Yes
Date last log run: October 17, 2011
Were unusual drilling circumstances encountered? No
Explanation:

Other Remarks
UIC APPLICATION NUMBER 1701060044 (MODIFICATION OF CURRENT UIC PERMIT NUMBER 1400560067)

Bottom Holes
Sec: 36 TWP: 27N RGE: 13W County: WOODS NW NW SE SW 1205 FSL 1476 FEL of 1/4 SEC Depth of Deviation: 0 Radius of Turn: 0 Direction: 0 Total Length: 0 Measured Total Depth: 9055 True Vertical Depth: 8078 End Pt. Location From Release, Unit or Property Line: 1205

FOR COMMISSION USE ONLY	
Status: Accepted	1134311

API NO. 151-23514
 OTC PROD.
 UNIT NO. N/A

PLEASE TYPE OR USE BLACK INK ONLY
 NOTE:
 Attach copy of original 1002A if recompletion or reentry.

OKLAHOMA CORPORATION COMMISSION
 Oil & Gas Conservation Division
 Post Office Box 52000
 Oklahoma City, Oklahoma 73152-2000
 Rule 165:10-3-25

Form 1002A
 Rev. 2009
RECEIVED
 630921

AUG 29 2016

ORIGINAL
 AMENDED
 Reason Amended **Recompletion**

COMPLETION REPORT

OKLAHOMA CORPORATION COMMISSION

TYPE OF DRILLING OPERATION
 STRAIGHT HOLE SERVICE WELL
 DIRECTIONAL HOLE
 HORIZONTAL HOLE

SPUD DATE 9/21/2011
 DRLG FINISHED DATE 11/10/2011
 DATE OF WELL COMPLETION 11/28/2011
 1ST PROD DATE N/A
 WORKOVER DATE 8/2/2016

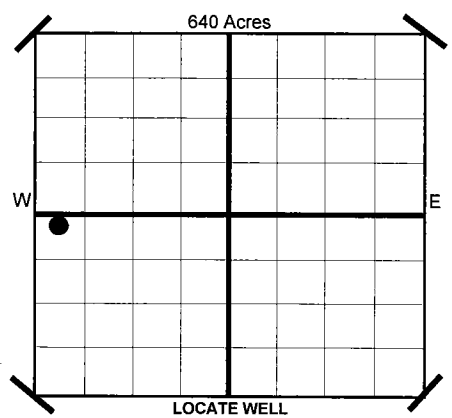

COUNTY Woods SEC 36 TWP 27N RGE 13W
 LEASE NAME Campbell 36-27-13 SWD WELL NO 1
 SHL N2 1/4 NW 1/4 NW 1/4 SW 1/4 FSL 2,440 FWL OF 1/4 SEC 330
 ELEVATION Derrick Fl 1,463 Ground 1,445 Latitude (if Known)
 OPERATOR NAME CHESAPEAKE OPERATING, L.L.C. OTC/OCC OPERATOR NO. 17441
 ADDRESS P.O. BOX 18496
 CITY OKLAHOMA CITY STATE OK ZIP 73154

COMPLETION TYPE
 SINGLE ZONE
 MULTIPLE ZONE
 COMMINGLED
 LOCATION EXCEPTION ORDER NO. N/A
 INCREASED DENSITY ORDER NO. N/A

CASING & CEMENT (Form 1002C must be attached)								
TYPE	SIZE	WEIGHT	GRADE	FEET	PSI	SAX	TOP	
CONDUCTOR								
SURFACE	13-3/8"	54.5#	J-55	1,016		1,040	Surface	
INTERMEDIATE								
PRODUCTION	9-5/8"	40#	K-55	6,750		790	5,850	
LINER								
							TOTAL DEPTH	9,055

PACKER @ 6,375 BRAND & TYPE UltraPak PLUG @ 6,671 TYPE Cement PLUG @ 6,675 TYPE CIBP
 PACKER @ 6,705 BRAND & TYPE Baker FA-1 PLUG @ TYPE PLUG @ 8,059 TYPE Cement

COMPLETION & TEST DATA BY PRODUCING FORMATION

FORMATION	SPACING & SPACING ORDER NUMBER	CLASS: Oil, Gas, Dry, Inj. Disp, Comm Disp, Svc	PERFORATED INTERVALS	ACID/VOLUME	FRACTURE TREATMENT (Fluids/Prop Amounts)
Simpson	N/A	Disposal	6428 - 6597	3,000 gals 10% acid	
					202 SIMPS
					NO FRAC

Minimum Gas Allowable (165:10-17-7) Gas Purchaser/Measurer
 OR 1st Sales Date
 Oil Allowable (165:10-13-3)

INITIAL TEST DATA

INITIAL TEST DATE	
OIL-BBL/DAY	
OIL-GRAVITY (API)	
GAS-MCF/DAY	
GAS-OIL RATIO CU FT/BBL	
WATER-BBL/DAY	
PUMPING OR FLOWING	
INITIAL SHUT-IN PRESSURE	
CHOKE SIZE	
FLOW TUBING PRESSURE	

AS SUBMITTED

A record of the formations drilled through, and pertinent remarks are presented on the reverse. I declare that I have knowledge of the contents of this report and am authorized by my organization to make this report, which was prepared by me or under my supervision and direction, with the data and facts stated herein to be true, correct, and complete to the best of my knowledge and belief.

SIGNATURE: *Jeff Bull* NAME (PRINT OR TYPE): JEFF BULL - REGULATORY MANAGER DATE: 8/25/2016 PHONE NUMBER: 405-848-8000
 ADDRESS: P.O. BOX 18496 CITY: OKLAHOMA CITY STATE: OK ZIP: 73154 EMAIL ADDRESS: juanita.cooper@chk.com

PLEASE TYPE OR USE BLACK INK ONLY
FORMATION RECORD

Give formation names and tops, if available, or descriptions and thickness of formations drilled through. Show intervals cored or drillstem tested.

LEASE NAME Campbell 36-27-13 SWD

WELL NO. 1

NAMES OF FORMATIONS	TOP
Simpson	6,422
Arbuckle	6,701

FOR COMMISSION USE ONLY

ITD on file YES NO

APPROVED _____ DISAPPROVED _____

2) Reject Codes

Were open hole logs run? yes no

Date Last log was run 10/17/2011

Was CO₂ encountered? yes no at what depths?

Was H₂S encountered? yes no at what depths?

Were unusual drilling circumstances encountered? yes no
If yes, briefly explain.

Other remarks: UIC Application No. 1701060044 (modification of current UIC Permit No. 1400560067)

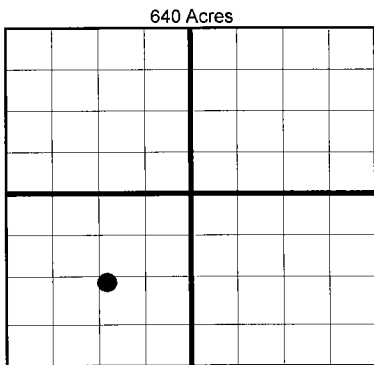

BOTTOM HOLE LOCATION FOR DIRECTIONAL HOLE

SEC	TWP	RGE	COUNTY			
36	27N	13W	Woods			
Spot Location		NW 1/4		SE 1/4	SW 1/4	
Measured Total Depth		True Vertical Depth		BHL From Lease, Unit, or Property Line:		
9,055		8,078		1,205		

BOTTOM HOLE LOCATION FOR HORIZONTAL HOLE: (LATERALS)

LATERAL #1

SEC	TWP	RGE	COUNTY			
Spot Location		1/4		1/4	1/4	1/4
Depth of Deviation		Radius of Turn		Direction		Total Length
Measured Total Depth		True Vertical Depth		BHL From Lease, Unit, or Property Line:		

LATERAL #2

SEC	TWP	RGE	COUNTY			
Spot Location		1/4		1/4	1/4	1/4
Depth of Deviation		Radius of Turn		Direction		Total Length
Measured Total Depth		True Vertical Depth		BHL From Lease, Unit, or Property Line:		

LATERAL #3

SEC	TWP	RGE	COUNTY			
Spot Location		1/4		1/4	1/4	1/4
Depth of Deviation		Radius of Turn		Direction		Total Length
Measured Total Depth		True Vertical Depth		BHL From Lease, Unit, or Property Line:		

If more than three drainholes are proposed, attach a separate sheet indicating the necessary information.

Direction must be stated in degrees azimuth. Please note, the horizontal drainhole and its end point must be located within the boundaries of the lease or spacing unit.

Directional surveys are required for all drainholes and directional wells.

