

OKLAHOMA CORPORATION COMMISSION
OIL & GAS CONSERVATION DIVISION
P.O. BOX 52000
OKLAHOMA CITY, OK 73152-2000
(Rule 165:10-3-1)

API NUMBER: 117 23683 A

Approval Date: 12/05/2016
Expiration Date: 06/05/2017

Straight Hole Oil & Gas

Amend reason: ADD FORMATION

AMEND PERMIT TO DRILL

WELL LOCATION: Sec: 19 Twp: 21N Rge: 8E County: PAWNEE
SPOT LOCATION: SW NE NW NE FEET FROM QUARTER: FROM NORTH FROM EAST
SECTION LINES: 561 1690

Lease Name: JL MILLER Well No: 33 Well will be 561 feet from nearest unit or lease boundary.

Operator Name: MID-CON ENERGY OPERATING LLC Telephone: 9187437575; 9187437 OTC/OCC Number: 23271 0

MID-CON ENERGY OPERATING LLC
2431 E 61ST ST STE 850
TULSA, OK 74136-1236

LARRY AND TERESA MORPHEW
1014 S UNDERWOOD
YALE OK 74085

Formation(s) (Permit Valid for Listed Formations Only):

Name	Depth	Name	Depth
1 LAYTON	1150	6 PRUE	1875
2 CHECKERBOARD	1405	7 SKINNER	2015
3 CLEVELAND	1495	8 PINK LIME	2045
4 BIG LIME	1700	9 BARTLESVILLE	2110
5 OSWEGO	1805	10	

Spacing Orders: 609199

Location Exception Orders:

Increased Density Orders:

Pending CD Numbers:

Special Orders:

Total Depth: 2250

Ground Elevation: 780

Surface Casing: 150

Depth to base of Treatable Water-Bearing FM: 100

Under Federal Jurisdiction: No

Fresh Water Supply Well Drilled: No

Surface Water used to Drill: Yes

PIT 1 INFORMATION

Type of Pit System: ON SITE

Type of Mud System: WATER BASED

Chlorides Max: 5000 Average: 3000

Is depth to top of ground water greater than 10ft below base of pit? Y

Within 1 mile of municipal water well? N

Wellhead Protection Area? N

Pit is located in a Hydrologically Sensitive Area.

Category of Pit: 1B

Liner required for Category: 1B

Pit Location is AP/TE DEPOSIT

Pit Location Formation: TERRACE

Approved Method for disposal of Drilling Fluids:

A. Evaporation/dewater and backfilling of reserve pit.

H. SOIL COMPACTED PIT, NOTIFY DISTRICT PRIOR TO TESTING SOIL PIT LINER

Notes:

This permit does not address the right of entry or settlement of surface damages.
The duration of this permit is SIX MONTHS, except as otherwise provided by Rule 165: 10-3-1.
Rule 165: 10-3-4 (c) (7) (e) - The Operator shall give 24 Hours notice by telephone to the appropriate District Office of the Conservation Division as to when Surface Casing will be run.

117 23683 JL MILLER 33

Category	Description
HYDRAULIC FRACTURING	12/1/2016 - G71 - OCC 165:10-3-10 REQUIRES: 1) THE CHEMICAL DISCLOSURE OF HYDRAULIC FRACTURING INGREDIENTS FOR ALL WELLS BE REPORTED TO FRACFOCUS USING THE FOLLOWING LINK HTTP://FRACFOCUS.ORG/ WITH NOTICE GIVEN 48 HOURS IN ADVANCE OF FRACTURING TO THE LOCAL OCC DISTRICT OFFICE; AND, 2) PRIOR TO COMMENCEMENT OF FRACTURING OPERATIONS FOR HORIZONTAL WELLS, NOTICE ALSO GIVEN FIVE BUSINESS DAYS IN ADVANCE TO OFFSET OPERATORS WITH WELLS COMPLETED IN THE SAME COMMON SOURCE OF SUPPLY WITHIN 1/2 MILE.
SPACING - 609199	12/5/2016 - G64 - (UNIT) E2 & E2 SW4 19-21N-8E EST CLEVELAND FIELD UNIT FOR TOP CGGV TO BASE ABCK

This permit does not address the right of entry or settlement of surface damages.
The duration of this permit is SIX MONTHS, except as otherwise provided by Rule 165: 10-3-1.
Rule 165: 10-3-4 (c) (7) (e) - The Operator shall give 24 Hours notice by telephone to the appropriate District Office of the Conservation Division as to when Surface Casing will be run.

WELL LOCATION FOR: MidCon Energy

R-8-E

API: 117 23683

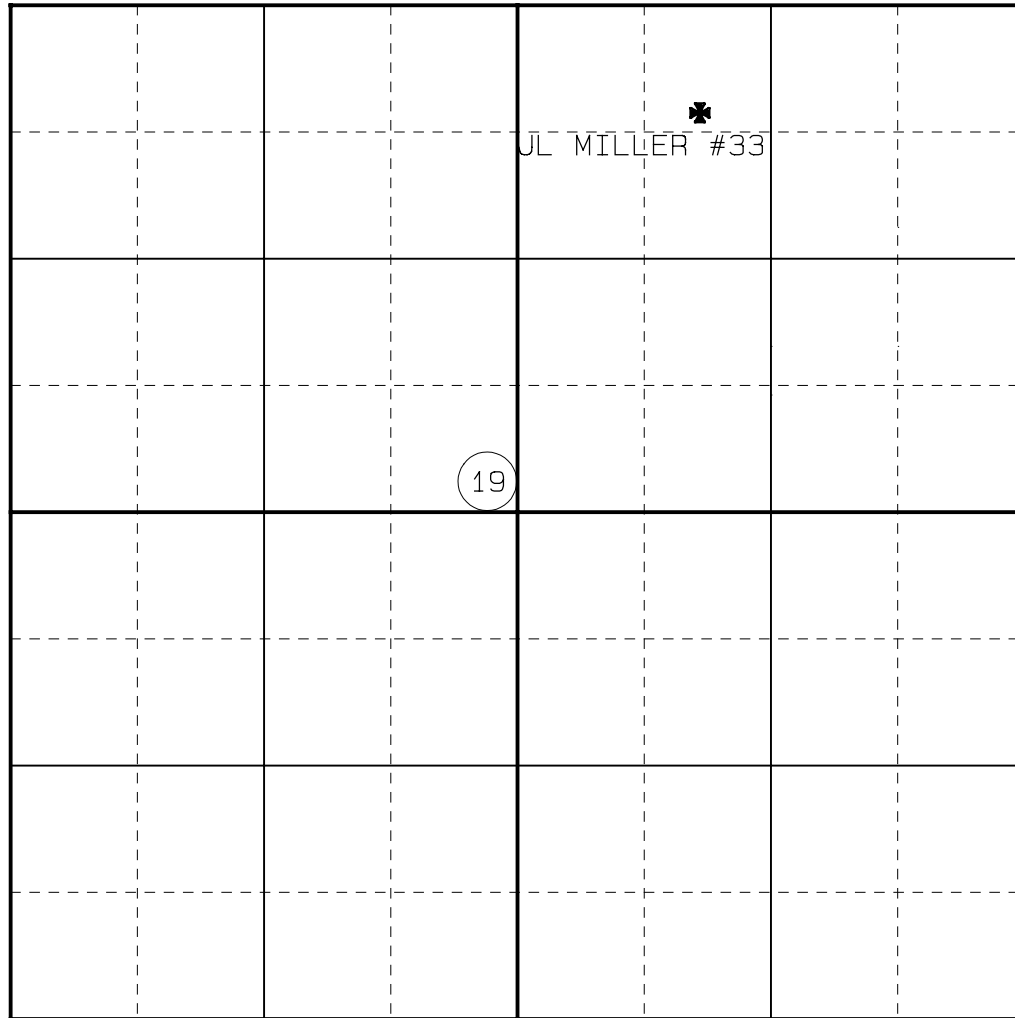

JL MILLER #33
1690' F.E.L. #
561' F.N.L. NE/4
SEC 19-T21N-R8E
ELEV 775'

DUE CARE AND DILIGENCE HAVE BEEN EXERCISED IN THE STAKING OF THIS WELL LOCATION ON THE GROUND ACCORDING TO THE BEST OFFICIAL RECORDS AND MAPS AVAILABLE TO US.

PLEASE REVIEW THIS PLAT AND NOTIFY US IMMEDIATELY OF ANY DISCREPANCY

PENNCO LAND SURVEYING
P.O. BOX 52, SAPULPA, OK, 74067
(918) 367-2942; penncosurveying@yahoo.com
CA# 2074

DATE OF LAST SITE VISIT:
DATE OF REVISIONS: