

Oklahoma Corporation Commission
Oil & Gas Conservation Division
Post Office Box 52000
Oklahoma City, Oklahoma 73152-2000
Rule 165: 10-3-25

Form 1002A

API No.: 35151244840000

Completion Report

Spud Date: October 27, 2016

OTC Prod. Unit No.: 151-218328

Drilling Finished Date: November 07, 2016

1st Prod Date: January 20, 2017

Completion Date: January 19, 2017

Drill Type: HORIZONTAL HOLE

Min Gas Allowable: Yes

Well Name: MERIDETH 2615 1H-08 A

Purchaser/Measurer: SEMGAS

Location: WOODS 17 26N 15W
NE NW NW NW
130 FNL 650 FWL of 1/4 SEC
Derrick Elevation: 0 Ground Elevation: 1754

First Sales Date: 01/27/2017

Operator: MIDSTATES PETROLEUM COMPANY LLC 23079

321 S BOSTON AVE STE 1000
TULSA, OK 74103-3322

Completion Type		Location Exception		Increased Density	
X	Single Zone	Order No		Order No	
	Multiple Zone	660958		There are no Increased Density records to display.	
	Commingled				

Casing and Cement							
Type	Size	Weight	Grade	Feet	PSI	SAX	Top of CMT
SURFACE	9 5/8	36	J-55	1234		575	SURFACE
PRODUCTION	7	26	P-110	6664		310	2614

Liner								
Type	Size	Weight	Grade	Length	PSI	SAX	Top Depth	Bottom Depth
LINER	4.5	11.6	P-110	5189	0	575	6418	11607

Total Depth: 11607

Packer	
Depth	Brand & Type
There are no Packer records to display.	

Plug	
Depth	Plug Type
There are no Plug records to display.	

Initial Test Data										
Test Date	Formation	Oil BBL/Day	Oil-Gravity (API)	Gas MCF/Day	Gas-Oil Ratio Cu FT/BBL	Water BBL/Day	Pumpin or Flowing	Initial Shut-In Pressure	Choke Size	Flow Tubing Pressure
Feb 13, 2017	MISSISSIPPI LIME	25	33	813	32520	5398	PUMPING	143	64/64	250

Completion and Test Data by Producing Formation

Formation Name: MISSISSIPPI LIME

Code: 351MSSLM

Class: GAS

Spacing Orders

Order No	Unit Size
76536	640

Perforated Intervals

From	To
6709	11508

Acid Volumes

5,359 BARRELS 15% GELLED AND RET ACID, 805 BARRELS 15% HCL

Fracture Treatments

102,262 BARRELS SLICK WATER, 179,748 POUNDS ROCK SALT

Formation	Top
HEEBNER SHALE	4701
ENDICOTT	4728
TONKAWA	5077
AVANT	5373
COTTAGE GROVE	5411
HOGSHOOTER	5544
OSWEGO	5654
CHEROKEE	5766
MISSISSIPPI	6008

Were open hole logs run? No

Date last log run:

Were unusual drilling circumstances encountered? No

Explanation:

Other Remarks

There are no Other Remarks.

Lateral Holes

Sec: 8 TWP: 26N RGE: 15W County: WOODS

NW NE NW NW

166 FNL 667 FWL of 1/4 SEC

Depth of Deviation: 7376 Radius of Turn: 1725 Direction: 359 Total Length: 4944

Measured Total Depth: 11607 True Vertical Depth: 6175 End Pt. Location From Release, Unit or Property Line: 166

FOR COMMISSION USE ONLY

1136057

Status: Accepted

RECEIVED

Form 1002A Rev. 2009

FEB 24 2017

OKLAHOMA CORPORATION COMMISSION

API NO. 151 24484
OTC PROD. UNIT NO. 151 218328

PLEASE TYPE OR USE BLACK INK ONLY
NOTE:

Attach copy of original 1002A if recompletion or reentry.

OKLAHOMA CORPORATION COMMISSION
Oil & Gas Conservation Division
Post Office Box 52000
Oklahoma City, Oklahoma 73152-2000
Rule 165:10-3-25

COMPLETION REPORT

ORIGINAL
AMENDED (Reason)

TYPE OF DRILLING OPERATION
STRAIGHT HOLE
DIRECTIONAL HOLE
HORIZONTAL HOLE

SPUD DATE 10/27/2016
DRLG FINISHED DATE 11/07/2016
DATE OF WELL COMPLETION 01/19/2017
1st PROD DATE 01/20/2017
RECOMP DATE
ELEVATION N Derrick Ground 1754
Latitude (if known)
Longitude (if known)
OPERATOR NAME Midstates Petroleum Company LLC
OTC/OCC OPERATOR NO. 23079
ADDRESS 321 South Boston, Suite 1000
CITY Tulsa STATE OK ZIP 74103

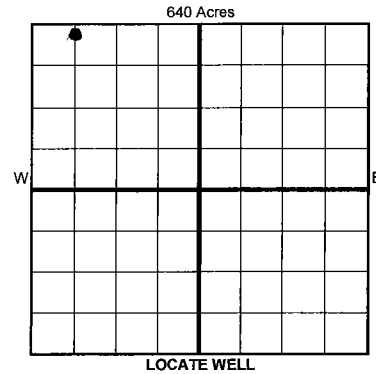

COUNTY Woods SEC 17 TWP 26N RGE 15W
LEASE NAME Merideth 2615
WELL NO. 1H-08 A
NE 1/4 NW 1/4 NW 1/4 NW 1/4 1/4 OF 1/4 SEC 130N FWL OF 1/4 SEC 650
OPERATOR NAME Midstates Petroleum Company LLC
ADDRESS 321 South Boston, Suite 1000
CITY Tulsa STATE OK ZIP 74103

COMPLETION TYPE
SINGLE ZONE
MULTIPLE ZONE
COMMINGLED
EXCEPTION ORDER
INCREASED DENSITY ORDER NO.

Table with columns: TYPE, SIZE, WEIGHT, GRADE, FEET, PSI, SAX, TOP OF CMT. Rows include CONDUCTOR, SURFACE, INTERMEDIATE, PRODUCTION, LINER, and TOTAL DEPTH.

PACKER @ BRAND & TYPE PLUG @ TYPE PLUG @ TYPE
PACKER @ BRAND & TYPE PLUG @ TYPE PLUG @ TYPE

COMPLETION & TEST DATA BY PRODUCING FORMATION 351 MESSLM

Table with columns: FORMATION, SPACING & SPACING ORDER NUMBER, CLASS, PERFORATED INTERVALS, ACID/VOLUME, FRACTURE TREATMENT. Includes handwritten notes like 'Reported To Frac Focus'.

Min Gas Allowable (165:10-17-7) Gas Purchaser/Measurer SemGas
OR First Sales Date 01/27/2017
Oil Allowable (165:10-13-3)

Table with columns: INITIAL TEST DATE, OIL-BBL/DAY, OIL-GRAVITY (API), GAS-MCF/DAY, GAS-OIL RATIO CU FT/BBL, WATER-BBL/DAY, PUMPING OR FLOWING, INITIAL SHUT-IN PRESSURE, CHOKE SIZE, FLOW TUBING PRESSURE.

AS SUBMITTED

A record of the formations drilled through and pertinent remarks are presented on the reverse. I declare that I have knowledge of the contents of this report and am authorized by my organization to make this report which was prepared by me or under my supervision and direction, with the data and facts stated herein to be true, correct, and complete to the best of my knowledge and belief.
Signature: Chelce Rouse
Date: 01/25/2017
Phone Number: 918-947-4647
Address: 321 South Boston, Suite 1000 Tulsa, OK 74103
Email: chelce.rouse@midstatespetroleum.com

PLEASE TYPE OR USE BLACK INK ONLY
FORMATION RECORD

Give formation names and tops, if available, or descriptions and thickness of formations drilled through. Show intervals cored or drillstem tested.

LEASE NAME Merideth 2615

WELL NO. 1H-08 A

NAMES OF FORMATIONS	TOP
HEEBNER SHALE	4,701
ENDICOTT	4,728
TONKAWA	5,077
AVANT	5,373
COTTAGE GROVE	5,411
HOGSHOOTER	5,544
OSWEGO	5,654
CHEROKEE	5,766
MISSISSIPPI	6,008

FOR COMMISSION USE ONLY

ITD on file YES NO

APPROVED _____ DISAPPROVED _____

2) Reject Codes _____

Were open hole logs run? yes no

Date Last log was run N/A

Was CO₂ encountered? yes no at what depths? _____

Was H₂S encountered? yes no at what depths? _____

Were unusual drilling circumstances encountered? yes no

If yes, briefly explain below _____

Other remarks:

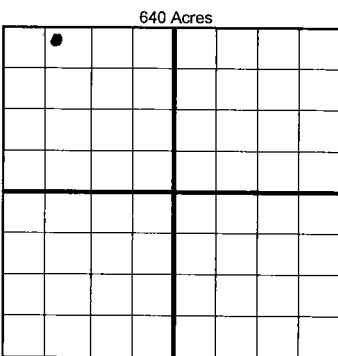

If more than three drainholes are proposed, attach a separate sheet indicating the necessary information.

Direction must be stated in degrees azimuth. Please note, the horizontal drainhole and its end point must be located within the boundaries of the lease or spacing unit.

Directional surveys are required for all drainholes and directional wells.

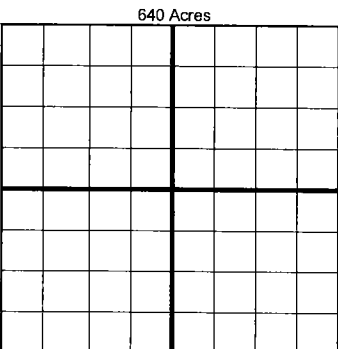

BOTTOM HOLE LOCATION FOR DIRECTIONAL HOLE

SEC	TWP	RGE	COUNTY
Spot Location			
1/4	1/4	1/4	1/4
Measured Total Depth	True Vertical Depth	BHL From Lease, Unit, or Property Line:	

BOTTOM HOLE LOCATION FOR HORIZONTAL HOLE: (LATERALS)

LATERAL #1

SEC 08 TWP 26N RGE 15W COUNTY Woods

Spot Location 22 NW 1/4 22 NE 1/4 NW 1/4 NW 1/4 Feet From 1/4 Sec Lines 166 FNL FSL 165N FWL 668 667

Depth of Deviation 7,376 Radius of Turn 1,725 Direction 359 Total Length 4,944

Measured Total Depth 11,607' True Vertical Depth 6,175' BHL From Lease, Unit, or Property Line: 185 166

LATERAL #2

SEC	TWP	RGE	COUNTY
Spot Location			
1/4	1/4	1/4	1/4
Depth of Deviation	Radius of Turn	Direction	Total Length
Measured Total Depth	True Vertical Depth	BHL From Lease, Unit, or Property Line:	

LATERAL #3

SEC	TWP	RGE	COUNTY
Spot Location			
1/4	1/4	1/4	1/4
Depth of Deviation	Radius of Turn	Direction	Total Length
Measured Total Depth	True Vertical Depth	BHL From Lease, Unit, or Property Line:	

