

Oklahoma Corporation Commission
 Oil & Gas Conservation Division
 Post Office Box 52000
 Oklahoma City, Oklahoma 73152-2000
 Rule 165: 10-3-25

Form 1002A

API No.: 35019261830000

Completion Report

Spud Date: September 01, 2015

OTC Prod. Unit No.: 019-218288

Drilling Finished Date: December 27, 2015

1st Prod Date: January 26, 2017

Completion Date: January 26, 2017

Drill Type: HORIZONTAL HOLE

Min Gas Allowable: Yes

Well Name: PAGE 6-15H10

Purchaser/Measurer: CROSS TIMBERS ENERGY

Location: CARTER 15 4S 3E
 SW SW NE NE
 1080 FNL 1170 FEL of 1/4 SEC
 Derrick Elevation: 0 Ground Elevation: 714

First Sales Date: 01/26/2017

Operator: XTO ENERGY INC 21003

810 HOUSTON ST
 FORT WORTH, TX 76102-6203

Completion Type	
X	Single Zone
	Multiple Zone
	Commingled

Location Exception	
Order No	
661618	

Increased Density	
Order No	
643853	

Casing and Cement							
Type	Size	Weight	Grade	Feet	PSI	SAX	Top of CMT
CONDUCTOR	20	131	J-55	103			SURFACE
SURFACE	9 5/8	36	J-55	1987		510	SURFACE
PRODUCTION	5 1/2	23	P-110	17743		1930	9300

Liner								
Type	Size	Weight	Grade	Length	PSI	SAX	Top Depth	Bottom Depth
There are no Liner records to display.								

Total Depth: 17755

Packer	
Depth	Brand & Type
There are no Packer records to display.	

Plug	
Depth	Plug Type
There are no Plug records to display.	

Initial Test Data

Test Date	Formation	Oil BBL/Day	Oil-Gravity (API)	Gas MCF/Day	Gas-Oil Ratio Cu FT/BBL	Water BBL/Day	Pumpin or Flowing	Initial Shut-In Pressure	Choke Size	Flow Tubing Pressure
Feb 14, 2017	WOODFORD	100	51	1100	11000	2336	FLOWING	3250	24/64	1900

Completion and Test Data by Producing Formation

Formation Name: WOODFORD

Code: 319WDFD

Class: OIL

Spacing Orders

Order No	Unit Size
262751	640

Perforated Intervals

From	To
12620	17599

Acid Volumes

80,640 GALLONS

Fracture Treatments

40 STAGES - 392,491 BTW, 1,252,440 POUNDS 100 MESH, 8,438,034 POUNDS 40/70

Formation	Top
WOODFORD	12434

Were open hole logs run? No

Date last log run:

Were unusual drilling circumstances encountered? No

Explanation:

Other Remarks

IRREGULAR SECTION

Lateral Holes

Sec: 10 TWP: 4S RGE: 3E County: CARTER

NW NE NE NE

39 FNL 362 FEL of 1/4 SEC

Depth of Deviation: 11800 Radius of Turn: 563 Direction: 7 Total Length: 5070

Measured Total Depth: 17755 True Vertical Depth: 11308 End Pt. Location From Release, Unit or Property Line: 39

FOR COMMISSION USE ONLY

1136045

Status: Accepted

API NO. 019-26183
 OTC PROD. UNIT NO. 019-218288

PLEASE TYPE OR USE BLACK INK ONLY
 NOTE:

Attach copy of original 1002A if recompletion or reentry.

OKLAHOMA CORPORATION COMMISSION
 Oil & Gas Conservation Division
 Post Office Box 52000
 Oklahoma City, Oklahoma 73152-2000
 Rule 165:10-3-25

RECEIVED

Form 1002A
 Rev. 2009

FEB 22 2017

OKLAHOMA CORPORATION COMMISSION

ORIGINAL
 AMENDED (Reason)

COMPLETION REPORT

TYPE OF DRILLING OPERATION

STRAIGHT HOLE DIRECTIONAL HOLE HORIZONTAL HOLE
 SERVICE WELL

If directional or horizontal, see reverse for bottom hole location.

COUNTY	Carter	SEC	15	TWP	4S	RGE	3E	SPUD DATE	9/1/2015	
LEASE NAME	Page 6-15H10 →			WELL NO.	6-15H10			DRLG FINISHED DATE	12/27/2015	
SW 1/4 SW 1/4 NE 1/4 NE 1/4	FNL OF 1/4 SEC 1080'		FEL OF 1/4 SEC 1170'		DATE OF WELL COMPLETION		1/26/2017		DATE OF WELL COMPLETION	1/26/2017
ELEVATION N Derrick	Ground	714'	Latitude (if known)	34.213296°N		Longitude (if known)	96.972270°W			
OPERATOR NAME	XTO Energy Inc.			OTC/OCC OPERATOR NO.	21003					
ADDRESS	210 Park Avenue, Suite 2350									
CITY	Oklahoma City	STATE	Oklahoma	ZIP	73102					

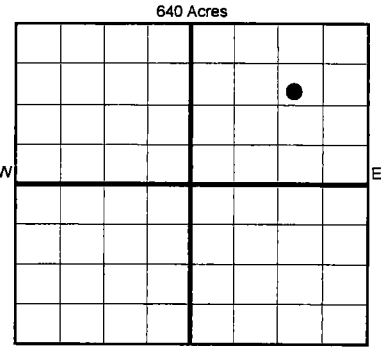

COMPLETION TYPE

<input checked="" type="checkbox"/> SINGLE ZONE
<input type="checkbox"/> MULTIPLE ZONE
Application Date
<input type="checkbox"/> COMMINGLED
Application Date
LOCATION
EXCEPTION ORDER
INCREASED DENSITY
ORDER NO.

661618FD
643853

643853

CASING & CEMENT (Form 1002C must be attached)

TYPE	SIZE	WEIGHT	GRADE	FEET	PSI	SAX	TOP OF CMT
CONDUCTOR	20"	131	J-55	103		510	Surface
SURFACE	9 5/8"	36	J-55	1987		520	Surface
INTERMEDIATE						1930	
PRODUCTION	5 1/2"	23	P-110	17,743		1055	9300'
LINER							
TOTAL DEPTH							17,755'

Per 1002C

PACKER @ _____ BRAND & TYPE _____ PLUG @ _____ TYPE _____ PLUG @ _____ TYPE _____
 PACKER @ _____ BRAND & TYPE _____ PLUG @ _____ TYPE _____ PLUG @ _____ TYPE _____

COMPLETION & TEST DATA BY PRODUCING FORMATION 319 WDFD

FORMATION	Woodford								
SPACING & SPACING ORDER NUMBER	640: 262751								Reported to Frac Fovus
CLASS: Oil, Gas, Dry, Inj, Disp, Comm Disp, Svc	Oil								
PERFORATED INTERVALS	40 Stages								
	12620-17599'								
ACID/VOLUME	80,640								
FRACTURE TREATMENT (Fluids/Prop Amounts)	392,491 BTW								
	1252,440# 100 Mesh								
	8,438,034# 40/70								

Min Gas Allowable (165:10-17-7) OR Gas Purchaser/Measurer Cross Timbers Energy
 Oil Allowable (165:10-13-3) First Sales Date 1/26/2017

INITIAL TEST DATA

INITIAL TEST DATE	2/14/2017				
OIL-BBL/DAY	100				
OIL-GRAVITY (API)	51				
GAS-MCF/DAY	1100				
GAS-OIL RATIO CU FT/BBL	11000				
WATER-BBL/DAY	2336				
PUMPING OR FLOWING	Flowing				
INITIAL SHUT-IN PRESSURE	3250				
CHOKE SIZE	24/64"				
FLOW TUBING PRESSURE	1900				

AS SUBMITTED

A record of the formations drilled through, and pertinent remarks are presented on the reverse. I declare that I have knowledge of the contents of this report and am authorized by my organization to make this report, which was prepared by me or under my supervision and direction, with the data and facts stated herein to be true, correct, and complete to the best of my knowledge and belief.

Debbie Waggoner
 SIGNATURE NAME (PRINT OR TYPE) DATE 2/17/2017 PHONE NUMBER 405-319-3243

210 Park Avenue, Suite 2350 Oklahoma City Ok 73102
 ADDRESS CITY STATE ZIP EMAIL ADDRESS debbie_waggoner@xtoenergy.com

PLEASE TYPE OR USE BLACK INK ONLY
FORMATION RECORD

Give formation names and tops, if available, or descriptions and thickness of formations drilled through. Show intervals cored or drillstem tested.

LEASE NAME _____ PAGE _____ WELL NO. 6-15H10

NAMES OF FORMATIONS	TOP
WOODFORD	12434' MD

FOR COMMISSION USE ONLY

ITD on file YES NO

APPROVED _____ DISAPPROVED _____

2) Reject Codes

Were open hole logs run? yes no

Date Last log was run _____

Was CO₂ encountered? yes no at what depths? _____

Was H₂S encountered? yes no at what depths? _____

Were unusual drilling circumstances encountered? yes no
If yes, briefly explain below _____

Other remarks: Irregular Section

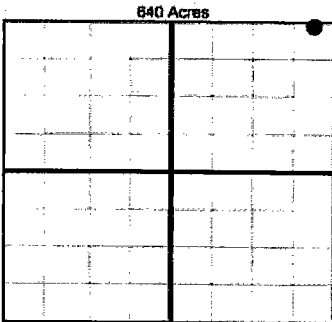

If more than three drainholes are proposed, attach a separate sheet indicating the necessary information.

Direction must be stated in degrees azimuth. Please note, the horizontal drainhole and its end point must be located within the boundaries of the lease or spacing unit.

Directional surveys are required for all drainholes and directional wells.

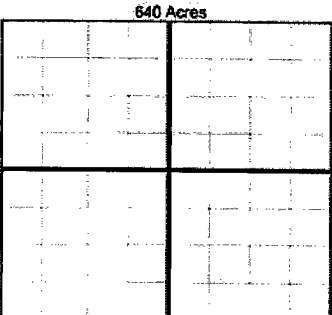

BOTTOM HOLE LOCATION FOR DIRECTIONAL HOLE

SEC	TWP	RGE	COUNTY				
Spot Location	1/4	1/4	1/4	1/4	Feet From 1/4 Sec Lines	FSL	FWL
Measured Total Depth	True Vertical Depth		BHL From Lease, Unit, or Property Line:				

BOTTOM HOLE LOCATION FOR HORIZONTAL HOLE: (LATERALS)

LATERAL #1

SEC	TWP	RGE	COUNTY				
SEC 10	TWP 4S	RGE 3E	COUNTY	Carter			
Spot Location	NW 1/4	NE 1/4	NE 1/4	NE 1/4	Feet From 1/4 Sec Lines	FNL 39'	FEL 362'
Depth of Deviation	11,800'		Radius of Turn	563.4	Direction	7.3	Total Length 5070.0'
Measured Total Depth	17755'		True Vertical Depth	11308'	BHL From Lease, Unit, or Property Line: 39' FNL & 362' FEL		

LATERAL #2

SEC	TWP	RGE	COUNTY				
Spot Location	1/4	1/4	1/4	1/4	Feet From 1/4 Sec Lines	FSL	FWL
Depth of Deviation	Radius of Turn		Direction		Total Length		
Measured Total Depth	True Vertical Depth		BHL From Lease, Unit, or Property Line:				

LATERAL #3

SEC	TWP	RGE	COUNTY				
Spot Location	1/4	1/4	1/4	1/4	Feet From 1/4 Sec Lines	FSL	FWL
Depth of Deviation	Radius of Turn		Direction		Total Length		
Measured Total Depth	True Vertical Depth		BHL From Lease, Unit, or Property Line:				