

OKLAHOMA CORPORATION COMMISSION
OIL & GAS CONSERVATION DIVISION
P.O. BOX 52000
OKLAHOMA CITY, OK 73152-2000
(Rule 165:10-3-1)

API NUMBER: 063 24660

Approval Date: 03/17/2017
Expiration Date: 09/17/2017

Horizontal Hole Oil & Gas

PERMIT TO DRILL

WELL LOCATION: Sec: 15 Twp: 7N Rge: 10E County: HUGHES
SPOT LOCATION: SW NE SW SE FEET FROM QUARTER: FROM SOUTH FROM EAST
SECTION LINES: 873 1776

Lease Name: REBA Well No: 4-22/27H Well will be 873 feet from nearest unit or lease boundary.
Operator Name: TRINITY OPERATING (USG) LLC Telephone: 7133741573 OTC/OCC Number: 23879 0

TRINITY OPERATING (USG) LLC
601 TRAVIS ST STE 1900
HOUSTON, TX 77002-3253

KEVIN & PATTY NOLEN
3326 N. 381 RD.
HOLDENVILLE OK 74848

Formation(s) (Permit Valid for Listed Formations Only):

Name	Depth	Name	Depth
1 WOODFORD	4890	6	
2		7	
3		8	
4		9	
5		10	

Spacing Orders: 660934 Location Exception Orders: 660935 Increased Density Orders: 660031
636104
630886
647111

Pending CD Numbers:

Special Orders:

Total Depth: 13990 Ground Elevation: 885 Surface Casing: 550 Depth to base of Treatable Water-Bearing FM: 500

Under Federal Jurisdiction: No Fresh Water Supply Well Drilled: No Surface Water used to Drill: No

PIT 1 INFORMATION

Type of Pit System: ON SITE
Type of Mud System: AIR

Is depth to top of ground water greater than 10ft below base of pit? Y
Within 1 mile of municipal water well? Y
Wellhead Protection Area? Y
Pit is located in a Hydrologically Sensitive Area.

Category of Pit: 4

Liner not required for Category: 4

Pit Location is BED AQUIFER

Pit Location Formation: CALVIN

Mud System Change to Water-Based or Oil-Based Mud Requires an Amended Intent (Form 1000).

Approved Method for disposal of Drilling Fluids:

A. Evaporation/dewater and backfilling of reserve pit.

E. Haul to Commercial pit facility: Sec. 19 Twn. 8N Rng. 5E Cnty. 125 Order No: 274874

H. SEE MEMO

This permit does not address the right of entry or settlement of surface damages.
The duration of this permit is SIX MONTHS, except as otherwise provided by Rule 165: 10-3-1.
Rule 165: 10-3-4 (c) (7) (e) - The Operator shall give 24 Hours notice by telephone to the appropriate District Office of the Conservation Division as to when Surface Casing will be run.

PIT 2 INFORMATION

Type of Pit System: ON SITE
Type of Mud System: WATER BASED
Chlorides Max: 8000 Average: 5000
Is depth to top of ground water greater than 10ft below base of pit? Y
Within 1 mile of municipal water well? Y
Wellhead Protection Area? Y
Pit is located in a Hydrologically Sensitive Area.

Category of Pit: 1A
Liner required for Category: 1A
Pit Location is BED AQUIFER
Pit Location Formation: CALVIN

PIT 3 INFORMATION

Type of Pit System: ON SITE
Type of Mud System: OIL BASED
Chlorides Max: 300000 Average: 200000
Is depth to top of ground water greater than 10ft below base of pit? Y
Within 1 mile of municipal water well? Y
Wellhead Protection Area? Y
Pit is located in a Hydrologically Sensitive Area.

Category of Pit: 3
Liner required for Category: 3
Pit Location is BED AQUIFER
Pit Location Formation: CALVIN

HORIZONTAL HOLE 1

Sec 27 Twp 7N Rge 10E County HUGHES
Spot Location of End Point: NE SE NW SE
Feet From: SOUTH 1/4 Section Line: 1690
Feet From: EAST 1/4 Section Line: 1634
Depth of Deviation: 4446
Radius of Turn: 573
Direction: 178
Total Length: 8644
Measured Total Depth: 13990
True Vertical Depth: 5008
End Point Location from Lease,
Unit, or Property Line: 1634

Notes:

Table with 2 columns: Category, Description. Row 1: HYDRAULIC FRACTURING, 3/16/2017 - G71 - OCC 165:10-3-10 REQUIRES: 1) THE CHEMICAL DISCLOSURE OF HYDRAULIC FRACTURING INGREDIENTS FOR ALL WELLS BE REPORTED TO FRACFOCUS USING THE FOLLOWING LINK HTTP://FRACFOCUS.ORG/ WITH NOTICE GIVEN 48 HOURS IN ADVANCE OF FRACTURING TO THE LOCAL OCC DISTRICT OFFICE; AND, 2) PRIOR TO COMMENCEMENT OF FRACTURING OPERATIONS FOR HORIZONTAL WELLS, NOTICE ALSO GIVEN FIVE BUSINESS DAYS IN ADVANCE TO OFFSET OPERATORS WITH WELLS COMPLETED IN THE SAME COMMON SOURCE OF SUPPLY WITHIN 1/2 MILE

This permit does not address the right of entry or settlement of surface damages.
The duration of this permit is SIX MONTHS, except as otherwise provided by Rule 165: 10-3-1.
Rule 165: 10-3-4 (c) (7) (e) - The Operator shall give 24 Hours notice by telephone to the appropriate District Office of the Conservation Division as to when Surface Casing will be run.

Category	Description
INCREASED DENSITY - 660031	3/17/2017 - G75 - 22-7N-10E X636104 WDFD 4 WELLS TRINITY OP. (USG), LLC 1-19-2017
LOCATION EXCEPTION - 660935	3/17/2017 - G75 - (I.O.) 22 & 27-7N-10E X636104 WDFD 22-7N-10E X630886 WDFD 27-7N-10E ** COMPL. INT. (22-7N-10E) NCT 165' FNL, NCT 0' FSL, NCT 1580' FEL COMPL. INT. (27-7N-10E) NCT 0' FNL, NCT 1645' FSL, NCT 1580' FEL TRINITY OP. (USG), LLC 2-10-2017 ** S/B X630886/647111 WDFD 27-7N-10E; TO BE CORRECTED AT HEARING FOR FINAL ORDER LOCATION EXCEPTION PER ATTORNEY FOR OPERATOR
MEMO	3/16/2017 - G71 - PIT 2 & 3 - CONCRETE-LINED PIT PER OPERATOR REQUEST; PIT 3 - OBM TO VENDOR, OBM CUTTINGS PER DISTRICT
PUBLIC WATER SUPPLY WELLS	3/16/2017 - G71 - MOSS SCHOOL, 2 PWS/WPA, NE4 22-7N-10E
SPACING - 630886	3/17/2017 - G75 - (640)(HOR) 27-7N-10E VAC OTHERS EXT 626818 WDFD, OTHERS COMPL. INT. NLT 165' FNL & FSL, NLT 330' FEL & FWL
SPACING - 636104	3/17/2017 - G75 - (640)(HOR) 22-7N-10E EXT 630886 WDFD, OTHERS COMPL. INT. NLT 165' FNL & FSL, NLT 330' FEL & FWL (COEXIST SP. ORDER # 540216 WDFD)
SPACING - 647111	3/17/2017 - G75 - MOD 630886 TO VAC 519790 WDFD NW4 27-7N-10E
SPACING - 660934	3/17/2017 - G75 - (I.O.) 22 & 27-7N-10E EST MULTIUNIT HORIZONTAL WELL X636104 WDFD 22-7N-10E X630886 WDFD 27-7N-10E ** 59% 22-7N-10E 41% 27-7N-10E TRINITY OP. (USG), LLC 2-10-2017 ** S/B X630886/647111 WDFD 27-7N-10E; TO BE CORRECTED AT HEARING FOR FINAL ORDER PER ATTORNEY FOR OPERATOR

This permit does not address the right of entry or settlement of surface damages.
The duration of this permit is SIX MONTHS, except as otherwise provided by Rule 165: 10-3-1.
Rule 165: 10-3-4 (c) (7) (e) - The Operator shall give 24 Hours notice by telephone to the appropriate District
Office of the Conservation Division as to when Surface Casing will be run.



Well Location Plat

S.H.L. Sec. 15-7N-10E I.M.
B.H.L. Sec. 27-7N-10E I.M.

Operator : TRINITY OPERATING

Lease Name and No. : REBA #4-22-27H

Footage : 873' FSL - 1776' FEL GR. ELEVATION : 885' Good Site? YES

Section : 15 Township : 7N Range : 10E I.M.

County : Hughes State of Oklahoma

Alternate Loc. : N/A

Terrain at Loc. : Location fell in open pasture with an existing fence to the West & an existing pipeline to the East.

API 063-24660

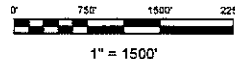

Accessibility : From the West.

Directions : From the junction of U.S. Highway 270 & U.S. Highway 75 in Horntown, OK, go 1.0 mile South on Hwy 270/75, go 1.0 mile East on "E1340 Rd." to proposed location in the Southeast Quarter of Section 15-7N-10E.

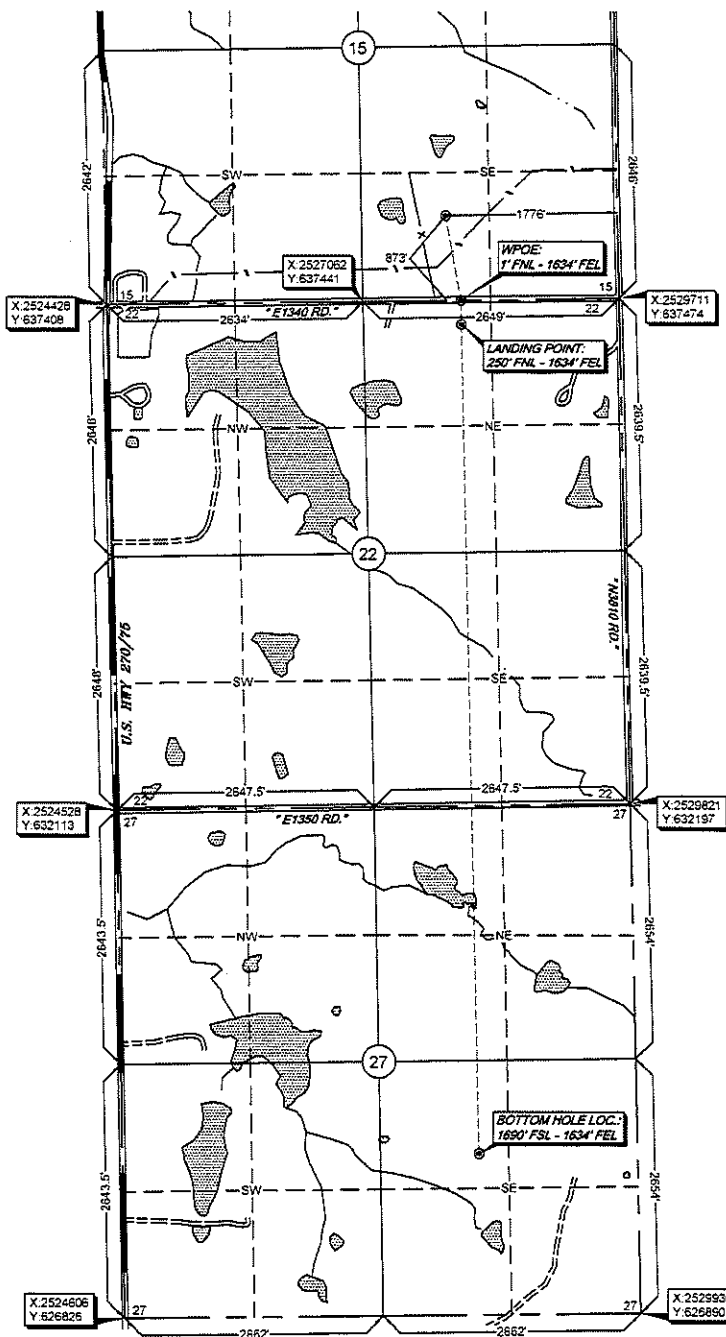

GPS DATUM NAD 27 OK SOUTH ZONE	
Surface Hole Loc.:	
Lat: 35°04'28.88"N	Lon: 96°14'08.30"W
X: 2527919	Y: 638325
WPOE:	
Lat: 35°04'20.23"N	Lon: 96°14'06.58"W
X: 2528077	Y: 637453
Landing Point:	
Lat: 35°04'17.76"N	Lon: 96°14'06.57"W
X: 2528082	Y: 637204
Bottom Hole Loc.:	
Lat: 35°02'52.25"N	Lon: 96°14'06.24"W
X: 2528261	Y: 628560

Please note that this location was staked on the ground under the supervision of a Licensed Professional Land Surveyor, but the accuracy of this survey is not guaranteed. Please contact Arkoma Surveying and Mapping promptly if any inaccuracy is determined. GPS data is observed from RTK - GPS.

NOTE: X and Y data shown hereon for Section Corners may NOT have been surveyed on-the-ground, and further, does NOT represent a true boundary survey.

Quarter Section distances may be assumed from a Government Survey Plat or assumed at a proportionate distance from opposing section corners, or occupation thereof, and may not have been measured on-the-ground, and further, does not represent a true boundary survey.

survey and plat by:
Arkoma Surveying and Mapping, PLLC
P.O. Box 238 Wilburton, OK 74578
Ph. 918-465-5711 Fax 918-465-5030
Certificate of Authorization No. 5348
Expires June 30, 2018

Invoice #6676-A-A
Date Staked : 10/26/16 By: H.S.
Date Drawn : 10/31/16 By: K.M.
Add Drill Plan : 03/06/17 By: K.M.

Certification:
This is to certify that this Well Location Plat represents the results of a survey made on the ground performed under the supervision of the undersigned.

LANCE G. MATHIS
03/08/17
OK LPLS 1664

