

Oklahoma Corporation Commission  
 Oil & Gas Conservation Division  
 Post Office Box 52000  
 Oklahoma City, Oklahoma 73152-2000  
 Rule 165: 10-3-25

Form 1002A

API No.: 35027214930000

**Completion Report**

Spud Date: December 19, 2016

OTC Prod. Unit No.:

Drilling Finished Date: December 29, 2016

1st Prod Date:

Completion Date: February 09, 2017

**Drill Type: STRAIGHT HOLE**

Well Name: BARBOUR 2-34

Purchaser/Measurer:

Location: CLEVELAND 34 8N 2W  
 NE SE NW NE  
 900 FNL 1600 FEL of 1/4 SEC  
 Derrick Elevation: 1200 Ground Elevation: 1184

First Sales Date:

Operator: OKLAND OIL COMPANY 7910

110 N ROBINSON AVE STE 400  
 OKLAHOMA CITY, OK 73102-9022

Completion Type	
X	Single Zone
	Multiple Zone
	Commingled

Location Exception
Order No
657909

Increased Density
Order No
There are no Increased Density records to display.

Casing and Cement							
Type	Size	Weight	Grade	Feet	PSI	SAX	Top of CMT
CONDUCTOR	16	65	H-40	40		108	SURFACE
SURFACE	9.625	36	J-55	850		335	SURFACE
PRODUCTION	5.5	17.0	N-80	7674	3000	215	6746

Liner								
Type	Size	Weight	Grade	Length	PSI	SAX	Top Depth	Bottom Depth
There are no Liner records to display.								

**Total Depth: 7685**

Packer	
Depth	Brand & Type
There are no Packer records to display.	

Plug	
Depth	Plug Type
There are no Plug records to display.	

Initial Test Data

Test Date	Formation	Oil BBL/Day	Oil-Gravity (API)	Gas MCF/Day	Gas-Oil Ratio Cu FT/BBL	Water BBL/Day	Pumpin or Flowing	Initial Shut-In Pressure	Choke Size	Flow Tubing Pressure
Feb 09, 2017	HUNTON					105	SWAB			

**Completion and Test Data by Producing Formation**

Formation Name: HUNTON

Code: 269HNTN

Class: DRY

**Spacing Orders**

Order No	Unit Size
218620	80

**Perforated Intervals**

From	To
7310	7384

**Acid Volumes**

2,866 BARRELS 20%
-------------------

**Fracture Treatments**

4,923 BSW, 50,400 POUNDS SAND
-------------------------------

Formation	Top
FIRST DEESE	6740
SECOND DEESE	6815
THIRD DEESE	6956
HART	7040
OSBORN (5TH DEESE)	7114
BASAL PENNSYLVANIAN	7202
HUNTON	7310

Were open hole logs run? Yes

Date last log run: December 27, 2016

Were unusual drilling circumstances encountered? No

Explanation:

**Other Remarks**

There are no Other Remarks.

**FOR COMMISSION USE ONLY**

1136082

Status: Accepted

RECEIVED

Form 1002A Rev. 2009

MAR 02 2017

OKLAHOMA CORPORATION COMMISSION

API NO. 027-21493

PLEASE TYPE OR USE BLACK INK ONLY

OKLAHOMA CORPORATION COMMISSION Oil & Gas Conservation Division Post Office Box 52000 Oklahoma City, Oklahoma 73152-2000 Rule 165:10-3-25

NOTE: Attach copy of original 1002A if recompletion or reentry.

ORIGINAL AMENDED (Reason)

COMPLETION REPORT

TYPE OF DRILLING OPERATION STRAIGHT HOLE DIRECTIONAL HOLE HORIZONTAL HOLE SERVICE WELL

SPUD DATE 12/19/2016 DRLG FINISHED DATE 12/29/2016

If directional or horizontal, see reverse for bottom hole location.

Form with fields: COUNTY CLEVELAND, SEC 34, TWP 8N, RGE 2W, LEASE NAME BARBOUR, WELL NO. 2-34, DATE OF WELL COMPLETION 02/09/2017, 1st PROD DATE, RECOMP DATE, OPERATOR NAME OKLAND OIL COMPANY, ADDRESS 110 N. ROBINSON STE #400, CITY OKLAHOMA CITY, STATE OK, ZIP 73102

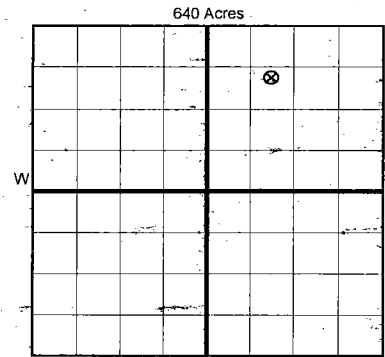

LOCATE WELL

COMPLETION TYPE

Form with fields: SINGLE ZONE, MULTIPLE ZONE, LOCATION EXCEPTION ORDER INCREASED DENSITY ORDER NO. 657909

CASING & CEMENT (Form 1002C must be attached)

Table with columns: TYPE, SIZE, WEIGHT, GRADE, FEET, PSI, SAX, TOP OF CMT. Rows include CONDUCTOR, SURFACE, INTERMEDIATE, PRODUCTION, LINER.

PACKER @ BRAND & TYPE PLUG @ TYPE PLUG @ TYPE PLUG @ TYPE

TOTAL DEPTH 7,685

COMPLETION & TEST DATA BY PRODUCING FORMATION 269 HNTN

Table with columns: FORMATION, SPACING & SPACING ORDER NUMBER, CLASS, PERFORATED INTERVALS, ACID/VOLUME, FRACTURE TREATMENT. Includes handwritten note 'Reported to Frac Focus'.

Min Gas Allowable (165:10-17-7)

Gas Purchaser/Measurer

OR

First Sales Date

INITIAL TEST DATA

Oil Allowable (165:10-13-3)

Table with columns: INITIAL TEST DATE, OIL-BBL/DAY, GAS-MCF/DAY, WATER-BBL/DAY, PUMPING OR FLOWING, INITIAL SHUT-IN PRESSURE, CHOKER SIZE, FLOW TUBING PRESSURE. Includes 'AS SUBMITTED' stamp.

A record of the formation drilled through and pertinent remarks are presented on the reverse. I declare that I have knowledge of the contents of this report and am authorized by my organization to make this report...

Signature and contact information: MARK WELLS, 3/1/2017, 405.236.3046, 110 N. ROBINSON #400, OKLAHOMA CITY, OK, 73102, mwells@oklandoil.com

PLEASE TYPE OR USE BLACK INK ONLY  
FORMATION RECORD

Give formation names and tops, if available, or descriptions and thickness of formations drilled through. Show intervals cored or drillstem tested.

LEASE NAME

BARBOUR

WELL NO.

2-34

NAMES OF FORMATIONS	TOP
FIRST DEESE	6,740
SECOND DEESE	6,815
THIRD DEESE	6956
HART	7,040
OSBORNE (5TH DEESE)	7,114
BASAL PENNSYLVANIAN	7,202
HUNTON	7,310

FOR COMMISSION USE ONLY

ITD on file  YES  NO

APPROVED \_\_\_\_\_ DISAPPROVED \_\_\_\_\_

2) Reject Codes \_\_\_\_\_  
\_\_\_\_\_  
\_\_\_\_\_  
\_\_\_\_\_

Were open hole logs run?  yes  no

Date Last log was run 12/27/2016

Was CO<sub>2</sub> encountered?  yes  no at what depths? \_\_\_\_\_

Was H<sub>2</sub>S encountered?  yes  no at what depths? \_\_\_\_\_

Were unusual drilling circumstances encountered?  yes  no  
if yes, briefly explain below \_\_\_\_\_

Other remarks: \_\_\_\_\_  
\_\_\_\_\_  
\_\_\_\_\_  
\_\_\_\_\_

640 Acres

If more than three drainholes are proposed, attach a separate sheet indicating the necessary information.

Direction must be stated in degrees azimuth. Please note, the horizontal drainhole and its end point must be located within the boundaries of the lease or spacing unit.

Directional surveys are required for all drainholes and directional wells.

640 Acres

BOTTOM HOLE LOCATION FOR DIRECTIONAL HOLE

SEC	TWP	RGE	COUNTY							
Spot Location				1/4	1/4	1/4	1/4	Feet From 1/4 Sec Lines	FSL	FWL
Measured Total Depth				True Vertical Depth		BHL From Lease, Unit, or Property Line:				

BOTTOM HOLE LOCATION FOR HORIZONTAL HOLE: (LATERALS)

LATERAL #1

SEC	TWP	RGE	COUNTY							
Spot Location				1/4	1/4	1/4	1/4	Feet From 1/4 Sec Lines	FSL	FWL
Depth of Deviation				Radius of Turn		Direction		Total Length		
Measured Total Depth				True Vertical Depth		BHL From Lease, Unit, or Property Line:				

LATERAL #2

SEC	TWP	RGE	COUNTY							
Spot Location				1/4	1/4	1/4	1/4	Feet From 1/4 Sec Lines	FSL	FWL
Depth of Deviation				Radius of Turn		Direction		Total Length		
Measured Total Depth				True Vertical Depth		BHL From Lease, Unit, or Property Line:				

LATERAL #3

SEC	TWP	RGE	COUNTY							
Spot Location				1/4	1/4	1/4	1/4	Feet From 1/4 Sec Lines	FSL	FWL
Depth of Deviation				Radius of Turn		Direction		Total Length		
Measured Total Depth				True Vertical Depth		BHL From Lease, Unit, or Property Line:				