

Oklahoma Corporation Commission
Oil & Gas Conservation Division
Post Office Box 52000
Oklahoma City, Oklahoma 73152-2000
Rule 165: 10-3-25

Form 1002A

API No.: 35019262260000

Completion Report

Spud Date: August 01, 2016

OTC Prod. Unit No.:

Drilling Finished Date: August 27, 2016

1st Prod Date: December 27, 2016

Completion Date: October 03, 2016

Drill Type: STRAIGHT HOLE

Well Name: KEITH 1-26

Purchaser/Measurer:

Location: CARTER 26 2S 2W
SW NE NW NE
2145 FSL 825 FWL of 1/4 SEC
Derrick Elevation: 0 Ground Elevation: 910

First Sales Date:

Operator: WILDHORSE OPERATING COMPANY 20720
PO BOX 1604
301 W MAIN ST STE 550
ARDMORE, OK 73402-1604

Completion Type	
<input type="checkbox"/>	Single Zone
<input type="checkbox"/>	Multiple Zone
<input checked="" type="checkbox"/>	Commingled

Location Exception
Order No
There are no Location Exception records to display.

Increased Density
Order No
There are no Increased Density records to display.

Casing and Cement							
Type	Size	Weight	Grade	Feet	PSI	SAX	Top of CMT
PRODUCTION	5.5	15.5	A	887		270	SURFACE

Liner								
Type	Size	Weight	Grade	Length	PSI	SAX	Top Depth	Bottom Depth
There are no Liner records to display.								

Total Depth: 887

Packer	
Depth	Brand & Type
There are no Packer records to display.	

Plug	
Depth	Plug Type
There are no Plug records to display.	

Initial Test Data										
Test Date	Formation	Oil BBL/Day	Oil-Gravity (API)	Gas MCF/Day	Gas-Oil Ratio Cu FT/BBL	Water BBL/Day	Pumpin or Flowing	Initial Shut-In Pressure	Choke Size	Flow Tubing Pressure
Dec 27, 2016	CISCO-DEESE	2	18				PUMPING			

Completion and Test Data by Producing Formation

Formation Name: CISCO

Code: 406CSCO

Class: OIL

Spacing Orders

Order No	Unit Size
There are no Spacing Order records to display.	

Perforated Intervals

From	To
535	541

Acid Volumes

There are no Acid Volume records to display.
--

Fracture Treatments

335 BARRELS GEL SW, 10,500 POUNDS 12/20

Formation Name: DEESE

Code: 404DEESS

Class: OIL

Spacing Orders

Order No	Unit Size
There are no Spacing Order records to display.	

Perforated Intervals

From	To
798	814

Acid Volumes

There are no Acid Volume records to display.
--

Fracture Treatments

345 BARRELS GEL SW, 15,700 POUNDS 12/20

Formation Name: CISCO-DEESE

Code:

Class: OIL

Formation	Top
CISCO	468
DEESE	560

Were open hole logs run? Yes

Date last log run: August 27, 2016

Were unusual drilling circumstances encountered? No

Explanation:

Other Remarks

There are no Other Remarks.

FOR COMMISSION USE ONLY

1135886

Status: Accepted

RECEIVED

Form 1002A Rev. 2009

FEB 09 2017

OKLAHOMA CORPORATION COMMISSION

API NO: 019-26226
OTC PROD. UNIT NO.

PLEASE TYPE OR USE BLACK INK ONLY
NOTE:

Attach copy of original 1002A if recompletion or reentry.

OKLAHOMA CORPORATION COMMISSION
Oil & Gas Conservation Division
Post Office Box 52000
Oklahoma City, Oklahoma 73152-2000
Rule 165:10-3-25

COMPLETION REPORT

ORIGINAL
 AMENDED (Reason)

TYPE OF DRILLING OPERATION

STRAIGHT HOLE DIRECTIONAL HOLE HORIZONTAL HOLE
 SERVICE WELL

If directional or horizontal, see reverse for bottom hole location.

COUNTY CARTER SEC 26 TWP 2S RGE 2W
LEASE NAME KEITH WELL NO. 1-26
SW 1/4 NE 1/4 NW 1/4 NE 1/4 FSL OF 1/4 SEC 2,145' FWL OF 1/4 SEC 825'
ELEVATIO Ground 910' Latitude (if known)
OPERATOR NAME WILDHORSE OPERATING COMPANY OTC/OCC OPERATOR NO. 20720
ADDRESS PO BOX 1604
CITY ARDMORE STATE OK ZIP 73402

SPUD DATE 08/01/16
DRLG FINISHED DATE 08/27/16
DATE OF WELL COMPLETION 10/3/16
1st PROD DATE 12/27/16
RECOMP DATE
Longitude (if known)

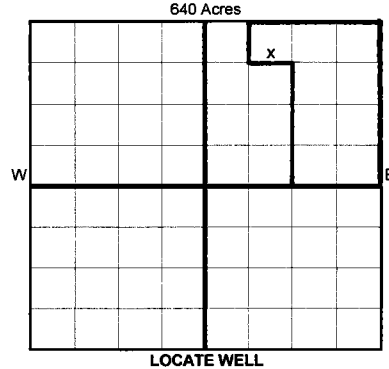

COMPLETION TYPE

SINGLE ZONE
 MULTIPLE ZONE Application Date
 COMMINGLED Application Date
LOCATION
EXCEPTION ORDER
INCREASED DENSITY
ORDER NO.

CASING & CEMENT (Form 1002C must be attached)

TYPE	SIZE	WEIGHT	GRADE	FEET	PSI	SAX	TOP OF CMT
CONDUCTOR							
SURFACE							
INTERMEDIATE							
PRODUCTION	5.5	15.5#	A	887.25'		270	Surface
LINER							
							TOTAL DEPTH 887.25'

PACKER @ _____ BRAND & TYPE _____ PLUG @ _____ TYPE _____ PLUG @ _____ TYPE _____
PACKER @ _____ BRAND & TYPE _____ PLUG @ _____ TYPE _____ PLUG @ _____ TYPE _____

COMPLETION & TEST DATA BY PRODUCING FORMATION *406 CSCO / 404 DEESS*

FORMATION	CISCO	DEESE		
SPACING & SPACING ORDER NUMBER	NONE	NONE		
CLASS: Oil, Gas, Dry, Inj, Disp, Comm Disp, Svc	OIL	OIL		
PERFORATED INTERVALS	535' - 541'	798' - 814'		
ACID/VOLUME	NONE	NONE		
FRACTURE TREATMENT (Fluids/Prop Amounts)	335BBIs GEL SW 10,500# 12-20	345BBIs GEL SW 15,700# 12-20		

Min Gas Allowable (165:10-17-7) OR Gas Purchaser/Measurer First Sales Date
 Oil Allowable (165:10-13-3)

INITIAL TEST DATA

INITIAL TEST DATE	12/27/2016
OIL-BBL/DAY	2
OIL-GRAVITY (API)	18
GAS-MCF/DAY	0
GAS-OIL RATIO CU FT/BBL	
WATER-BBL/DAY	NONE
PUMPING OR FLOWING	PUMP
INITIAL SHUT-IN PRESSURE	
CHOKE SIZE	
FLOW TUBING PRESSURE	

AS SUBMITTED

*CBL shows bond to surface
OKN*

A record of the formations drilled through, and pertinent remarks are presented on the reverse. I declare that I have knowledge of the contents of this report and am authorized by my organization to make the report, which was prepared by me or under my supervision and direction, with the data and facts stated herein to be true, correct, and complete to the best of my knowledge and belief.

SIGNATURE: *[Signature]* NAME (PRINT OR TYPE): S. NEIL SISSON DATE: 2/6/2017 PHONE NUMBER: 580-223-0936
ADDRESS: PO BOX 1604 CITY: ARDMORE STATE: OK ZIP: 73402 EMAIL ADDRESS: wildhorse@swbell.net

PLEASE TYPE OR USE BLACK INK ONLY
FORMATION RECORD

Give formation names and tops, if available, or descriptions and thickness of formations drilled through. Show intervals cored or drillstem tested.

LEASE NAME KEITH WELL NO. 1-26

NAMES OF FORMATIONS	TOP
CISCO	468'
DEESE	560'

FOR COMMISSION USE ONLY

ITD on file YES NO

APPROVED _____ DISAPPROVED _____

2) Reject Codes

Were open hole logs run? yes no

Date Last log was run 8/27/2016

Was CO₂ encountered? yes no at what depths? _____

Was H₂S encountered? yes no at what depths? _____

Were unusual drilling circumstances encountered? yes no
If yes, briefly explain below

Other remarks:

640 Acres

If more than three drainholes are proposed, attach a separate sheet indicating the necessary information.

Direction must be stated in degrees azimuth. Please note, the horizontal drainhole and its end point must be located within the boundaries of the lease or spacing unit.

Directional surveys are required for all drainholes and directional wells.

640 Acres

BOTTOM HOLE LOCATION FOR DIRECTIONAL HOLE

SEC	TWP	RGE	COUNTY							
Spot Location				1/4	1/4	1/4	1/4	Feet From 1/4 Sec Lines	FSL	FWL
Measured Total Depth				True Vertical Depth		BHL From Lease, Unit, or Property Line:				

BOTTOM HOLE LOCATION FOR HORIZONTAL HOLE: (LATERALS)

LATERAL #1

SEC	TWP	RGE	COUNTY							
Spot Location				1/4	1/4	1/4	1/4	Feet From 1/4 Sec Lines	FSL	FWL
Depth of Deviation				Radius of Turn		Direction		Total Length		
Measured Total Depth				True Vertical Depth		BHL From Lease, Unit, or Property Line:				

LATERAL #2

SEC	TWP	RGE	COUNTY							
Spot Location				1/4	1/4	1/4	1/4	Feet From 1/4 Sec Lines	FSL	FWL
Depth of Deviation				Radius of Turn		Direction		Total Length		
Measured Total Depth				True Vertical Depth		BHL From Lease, Unit, or Property Line:				

LATERAL #3

SEC	TWP	RGE	COUNTY							
Spot Location				1/4	1/4	1/4	1/4	Feet From 1/4 Sec Lines	FSL	FWL
Depth of Deviation				Radius of Turn		Direction		Total Length		
Measured Total Depth				True Vertical Depth		BHL From Lease, Unit, or Property Line:				