

OKLAHOMA CORPORATION COMMISSION  
OIL & GAS CONSERVATION DIVISION  
P.O. BOX 52000  
OKLAHOMA CITY, OK 73152-2000  
(Rule 165:10-3-1)

API NUMBER: 011 23804

Approval Date: 05/19/2017  
Expiration Date: 11/19/2017

Horizontal Hole Oil & Gas

PERMIT TO DRILL

WELL LOCATION: Sec: 35 Twp: 17N Rge: 10W County: BLAINE  
SPOT LOCATION:  SE  SE  SW  SW FEET FROM QUARTER: FROM SOUTH FROM WEST  
SECTION LINES: 241 1175

Lease Name: RED LAND Well No: 1-35H Well will be 241 feet from nearest unit or lease boundary.  
Operator Name: PRIDE ENERGY COMPANY Telephone: 9185249200 OTC/OCC Number: 19430 0

PRIDE ENERGY COMPANY  
PO BOX 701950  
TULSA, OK 74170-1950

RED LAND FARMS LLC  
2207 HUNTLEIGH  
SPRINGFIELD IL 62704

Formation(s) (Permit Valid for Listed Formations Only):

Name	Depth	Name	Depth
1 MERAMEC	9462	6	
2		7	
3		8	
4		9	
5		10	

Spacing Orders: 95567

Location Exception Orders:

Increased Density Orders:

Pending CD Numbers: 201701992  
201701993

Special Orders:

Total Depth: 14685 Ground Elevation: 1243 **Surface Casing: 1500** Depth to base of Treatable Water-Bearing FM: 70

Under Federal Jurisdiction: No Fresh Water Supply Well Drilled: No Surface Water used to Drill: No

PIT 1 INFORMATION

Approved Method for disposal of Drilling Fluids:

Type of Pit System: CLOSED Closed System Means Steel Pits

Type of Mud System: WATER BASED

Chlorides Max: 8000 Average: 5000

Is depth to top of ground water greater than 10ft below base of pit? N

Within 1 mile of municipal water well? N

Wellhead Protection Area? N

Pit is located in a Hydrologically Sensitive Area.

Category of Pit: C

Liner not required for Category: C

Pit Location is AP/TE DEPOSIT

Pit Location Formation: TERRACE

D. One time land application -- (REQUIRES PERMIT) PERMIT NO: 17-32589  
H. SEE MEMO

This permit does not address the right of entry or settlement of surface damages.  
The duration of this permit is SIX MONTHS, except as otherwise provided by Rule 165: 10-3-1.  
Rule 165: 10-3-4 (c) (7) (e) - The Operator shall give 24 Hours notice by telephone to the appropriate District Office of the Conservation Division as to when Surface Casing will be run.

PIT 2 INFORMATION

Type of Pit System: CLOSED Closed System Means Steel Pits

Type of Mud System: OIL BASED

Chlorides Max: 300000 Average: 20000

Is depth to top of ground water greater than 10ft below base of pit? Y

Within 1 mile of municipal water well? N

Wellhead Protection Area? N

Pit is located in a Hydrologically Sensitive Area.

Category of Pit: C

Liner not required for Category: C

Pit Location is AP/TE DEPOSIT

Pit Location Formation: TERRACE

HORIZONTAL HOLE 1

Sec 35 Twp 17N Rge 10W County BLAINE

Spot Location of End Point: NE NW NW NW

Feet From: NORTH 1/4 Section Line: 50

Feet From: WEST 1/4 Section Line: 380

Depth of Deviation: 9274

Radius of Turn: 363

Direction: 355

Total Length: 4841

Measured Total Depth: 14685

True Vertical Depth: 9462

End Point Location from Lease,  
Unit, or Property Line: 50

Notes:

Category	Description
DEEP SURFACE CASING	5/16/2017 - G71 - APPROVED; NOTIFY OCC FIELD INSPECTOR IMMEDIATELY OF ANY LOSS OF CIRCULATION OR FAILURE TO CIRCULATE CEMENT TO SURFACE ON ANY CONDUCTOR OR SURFACE CASING
HYDRAULIC FRACTURING	5/16/2017 - G71 - OCC 165:10-3-10 REQUIRES: 1) THE CHEMICAL DISCLOSURE OF HYDRAULIC FRACTURING INGREDIENTS FOR ALL WELLS BE REPORTED TO FRACFOCUS USING THE FOLLOWING LINK <a href="http://fracfocus.org/">HTTP://FRACFOCUS.ORG/</a> WITH NOTICE GIVEN 48 HOURS IN ADVANCE OF FRACTURING TO THE LOCAL OCC DISTRICT OFFICE; AND, 2) PRIOR TO COMMENCEMENT OF FRACTURING OPERATIONS FOR HORIZONTAL WELLS, NOTICE ALSO GIVEN FIVE BUSINESS DAYS IN ADVANCE TO OFFSET OPERATORS WITH WELLS COMPLETED IN THE SAME COMMON SOURCE OF SUPPLY WITHIN 1/2 MILE
MEMO	5/16/2017 - G71 - PITS 1 & 2 - CLOSED SYSTEM=STEEL PITS PER OPERATOR REQUEST, PIT 2 - OBM RETURNED TO VENDOR, CUTTINGS PERMITTED PER DISTRICT
PENDING CD - 201701992	5/18/2017 - G60 - (E.O.) 35-17N-10W X95567 MRMC 3 WELLS NO OP. NAMED REC. 5/12/17 (JOHNSON)
PENDING CD - 201701993	5/18/2017 - G60 - (E.O.) 35-17N-10W X95567 MRMC COMPL. INT. NCT 150' FNL, NCT 150' FSL, NCT 300' FWL NO OP. NAMED REC. 5/12/17 (JOHNSON)
SPACING - 95567	5/18/2017 - G60 - (640) 35-17N-10W EXT OTHERS EXT 61186 MRMC EST OTHERS

This permit does not address the right of entry or settlement of surface damages.  
The duration of this permit is SIX MONTHS, except as otherwise provided by Rule 165: 10-3-1.  
Rule 165: 10-3-4 (c) (7) (e) - The Operator shall give 24 Hours notice by telephone to the appropriate District Office of the Conservation Division as to when Surface Casing will be run.

PRIDE ENERGY COMPANY

# Well Location Plat

Operator : PRIDE ENERGY COMPANY 3501123804  
 Lease Name and No. : RED LAND #1-35H  
 Footage : 241' FSL - 1175' FWL GR. ELEVATION : 1243' Good Site? YES  
 Section : 35 Township : 17N Range : 10W I.M.  
 County : Blaine State of Oklahoma  
 Alternate Loc. : N/A  
 Terrain at Loc. : Location fell in a flat, open wheat field.



1"=1000'

GPS DATUM  
 NAD 83  
 OK NORTH ZONE

Surface Hole Loc. :  
 Lat: 35°53'57.55"N  
 Lon: 98°14'29.56"W  
 X: 1896961  
 Y: 327457

Landing Point:  
 Lat: 35°53'59.04"N  
 Lon: 98°14'39.23"W  
 X: 1896166  
 Y: 327609

Bottom Hole Loc. :  
 Lat: 35°54'46.88"N  
 Lon: 98°14'39.11"W  
 X: 1896188  
 Y: 332446

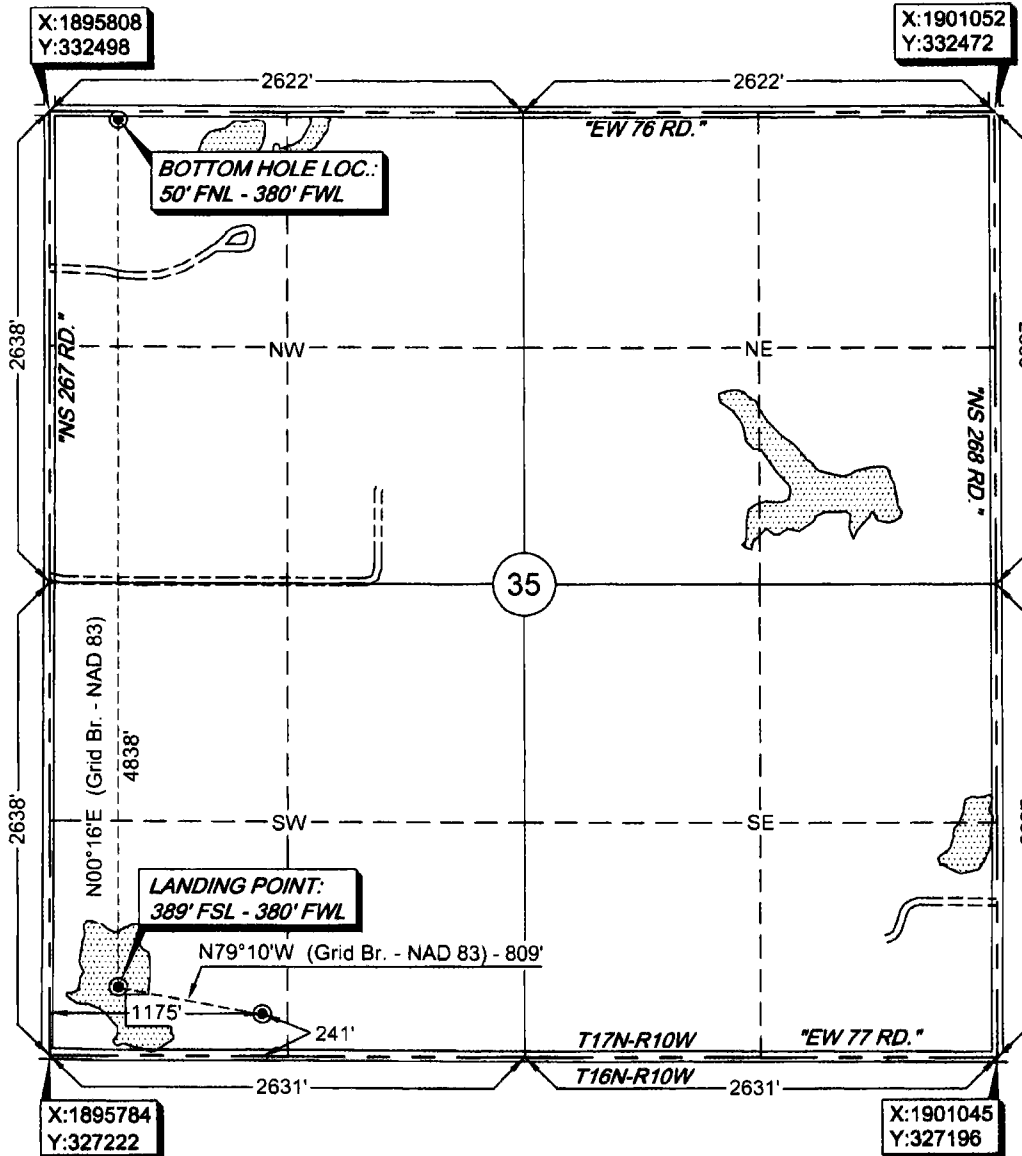

Please note that this location was staked on the ground under the supervision of a Licensed Professional Land Surveyor, but the accuracy of this survey is not guaranteed. Please contact Arkoma Surveying and Mapping promptly if any inconsistency is determined. GPS data is observed from RTK - GPS.  
 NOTE: X and Y data shown hereon for Section Corners may NOT have been surveyed on-the-ground and further does NOT represent a true Boundary Survey. Quarter Section distances may be assumed from a Government Survey Plat or assumed at a proportionate distance from opposing section corners, or occupation thereof, and may not have been measured on-the-ground, and further does not represent a true boundary survey.

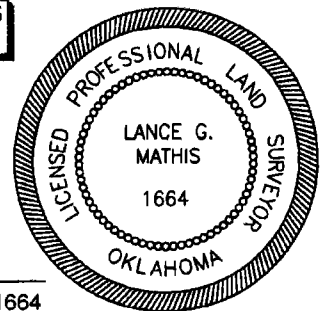

survey and plat by:  
 Arkoma Surveying and Mapping, PLLC  
 P.O. Box 238 Wilburton, OK 74578  
 Ph. 918-465-5711 Fax 918-465-5030  
 Certificate of Authorization No. 5348  
 Expires June 30, 2018

Certification:  
 This is to certify that this Well Location Plat represents the results of a survey made on the ground performed under the supervision of the undersigned.

Invoice #7070-A  
 Date Staked : 04/12/17 By : R.L.  
 Date Drawn : 04/17/17 By : C.S.  
 Revised LP & BHL: 05/08/17 By: P.B.

*Lance G. Mathis* 05/08/17  
 LANCE G. MATHIS OK LPLS 1664