

Oklahoma Corporation Commission
 Oil & Gas Conservation Division
 Post Office Box 52000
 Oklahoma City, Oklahoma 73152-2000
 Rule 165: 10-3-25

Form 1002A

API No.: 35039224960000

Completion Report

Spud Date: January 22, 2017

OTC Prod. Unit No.: 039-218711

Drilling Finished Date: February 26, 2017

1st Prod Date: April 23, 2017

Completion Date: April 23, 2017

Drill Type: HORIZONTAL HOLE

Min Gas Allowable: Yes

Well Name: PUTNAM OSWEGO UNIT 1-14H

Purchaser/Measurer: DCP

Location: CUSTER 14 15N 15W
 SW SW SE SE
 270 FSL 1120 FEL of 1/4 SEC
 Latitude: 35.7694 Longitude: -98.759808
 Derrick Elevation: 0 Ground Elevation: 1772

First Sales Date: 04/26/2017

Operator: BLAKE PRODUCTION COMPANY INC 18119

1601 NW EXPRESSWAY STE 777
 OKLAHOMA CITY, OK 73118-1446

Completion Type	
X	Single Zone
	Multiple Zone
	Commingled

Location Exception
Order No
There are no Location Exception records to display.

Increased Density
Order No
There are no Increased Density records to display.

Casing and Cement							
Type	Size	Weight	Grade	Feet	PSI	SAX	Top of CMT
SURFACE	9 5/8	36	J-55	0		565	SURFACE
INTERMEDIATE	7	26	P-110	10129	5000	455	6584
PRODUCTION	4 1/2	13.8		11518	5000	165	9200

Liner								
Type	Size	Weight	Grade	Length	PSI	SAX	Top Depth	Bottom Depth
There are no Liner records to display.								

Total Depth: 15575

Packer	
Depth	Brand & Type
There are no Packer records to display.	

Plug	
Depth	Plug Type
There are no Plug records to display.	

Initial Test Data

Test Date	Formation	Oil BBL/Day	Oil-Gravity (API)	Gas MCF/Day	Gas-Oil Ratio Cu FT/BBL	Water BBL/Day	Pumpin or Flowing	Initial Shut-In Pressure	Choke Size	Flow Tubing Pressure
Apr 26, 2017	OSWEGO	44	46	53	1204	180	PUMPING			

Completion and Test Data by Producing Formation

Formation Name: OSWEGO

Code: 404OSWG

Class: OIL

Spacing Orders

Order No	Unit Size
70029	UNIT

Perforated Intervals

From	To
10193	11843

Acid Volumes

745 BARRELS NEFE ACID

Fracture Treatments

40,594 BARRELS FRAC FLUID, 368,630 POUNDS PROPPANT

Formation	Top
BIG LIME	9706
OSWEGO	9760

Were open hole logs run? Yes

Date last log run: February 20, 2017

Were unusual drilling circumstances encountered? No

Explanation:

Other Remarks

OCC - THIS WELL IS COMPLETED THROUGH PERFORATIONS FROM 10193' TO 11360' AND ALSO OPEN HOLE FROM BOTTOM OF THE 4 1/2" CASING AT 11518' TO TERMINUS AT 15575'. THIS WELL'S PRODUCTIVE INTERVAL IS WITHIN THE LEGAL LIMITS OF THE UNIT 70029.

Lateral Holes

Sec: 11 TWP: 15N RGE: 15W County: CUSTER

NE NE SW SE

1268 FSL 1150 FWL of 1/4 SEC

Depth of Deviation: 9204 Radius of Turn: 581 Direction: 359 Total Length: 5498

Measured Total Depth: 15575 True Vertical Depth: 9668 End Pt. Location From Release, Unit or Property Line: 1350

FOR COMMISSION USE ONLY

1136850

Status: Accepted

RECEIVED

Form 1002A Rev. 2009

JUN 09 2017

OKLAHOMA CORPORATION COMMISSION

API NO. 3503922496
OTC PROD. UNIT NO. 39218711

PLEASE TYPE OR USE BLACK INK ONLY
NOTE:

Attach copy of original 1002A if recompletion or reentry.

OKLAHOMA CORPORATION COMMISSION
Oil & Gas Conservation Division
Post Office Box 52000
Oklahoma City, Oklahoma 73152-2000
Rule 165:10-3-25

ORIGINAL AMENDED (Reason)

COMPLETION REPORT

TYPE OF DRILLING OPERATION
STRAIGHT HOLE DIRECTIONAL HOLE HORIZONTAL HOLE
SERVICE WELL

SPUD DATE 1/22/2017
DRLG FINISHED DATE 2/26/2017
DATE OF WELL COMPLETION 4/23/2017
1st PROD DATE 4/23/2017
RECOMP DATE

If directional or horizontal, see reverse for bottom hole location.

COUNTY Custer SEC 14 TWP 15N RGE 15W
LEASE NAME Putnam Oswego Unit WELL NO. 1-14
SW 1/4 SW 1/4 SE 1/4 SE 1/4 FSL OF 1/4 SEC 270 PWE OF 1/4 SEC 1120'
ELEVATION Derrick FL Ground 1772 Latitude (if known) 35.7694 Longitude (if known) -98.759808
OPERATOR NAME Blake Production Company, Inc OTC/OCC OPERATOR NO. 18119
ADDRESS 1601 NW Expressway Ste 777
CITY Oklahoma City STATE OK ZIP 73118

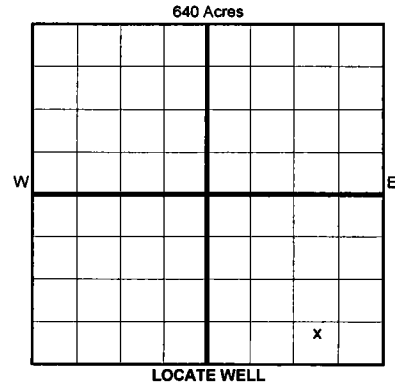

COMPLETION TYPE

SINGLE ZONE
MULTIPLE ZONE
COMMINGLED
LOCATION EXCEPTION ORDER INCREASED DENSITY ORDER NO.

CASING & CEMENT (Form 1002C must be attached)

Table with columns: TYPE, SIZE, WEIGHT, GRADE, FEET, PSI, SAX, TOP OF CMT. Rows include CONDUCTOR, SURFACE, INTERMEDIATE, PRODUCTION, LINER.

PACKER @ BRAND & TYPE PLUG @ TYPE PLUG @ TYPE TOTAL DEPTH 15,575

COMPLETION & TEST DATA BY PRODUCING FORMATION

Table with columns: FORMATION, SPACING & SPACING ORDER NUMBER, CLASS, PERFORATED INTERVALS, ACID/VOLUME, FRACTURE TREATMENT. Includes handwritten notes like 'Oswego' and 'Open hole'.

Min Gas Allowable (165:10-17-7) Gas Purchaser/Measurer DCP
Oil Allowable (165:10-13-3) First Sales Date 4/26/2017

INITIAL TEST DATA

Table with columns: INITIAL TEST DATE, OIL-BBL/DAY, OIL-GRAVITY (API), GAS-MCF/DAY, GAS-OIL RATIO CU FT/BBL, WATER-BBL/DAY, PUMPING OR FLOWING, INITIAL SHUT-IN PRESSURE, CHOKE SIZE, FLOW TUBING PRESSURE.

AS SUBMITTED

A record of the formations drilled through, and pertinent remarks are presented on the reverse. I declare that I have knowledge of the contents of this report and am authorized by my organization to make this report, which was prepared by me or under my supervision and direction, with the data and facts stated herein to be true, correct, and complete to the best of my knowledge and belief.
James Vernon 5/25/2017 405-286-9800
1601 NW Expressway Ste 777 Oklahoma City OK 73118 james.vernon@blakeproduction.com

