

Oklahoma Corporation Commission
Oil & Gas Conservation Division
Post Office Box 52000
Oklahoma City, Oklahoma 73152-2000
Rule 165: 10-3-25

Form 1002A

API No.: 35087210790001

Completion Report

Spud Date: June 19, 1984

OTC Prod. Unit No.: 087-084798

Drilling Finished Date: July 11, 1984

Amended

1st Prod Date: July 29, 1984

Amend Reason: RECOMPLETION

Completion Date: July 19, 1984

Recomplete Date: July 07, 2017

Drill Type: STRAIGHT HOLE

Min Gas Allowable: Yes

Well Name: ADKINS 2-26

Purchaser/Measurer: DCP

Location: MCCLAIN 26 8N 4W
C SW SW
660 FSL 660 FWL of 1/4 SEC
Derrick Elevation: 1198 Ground Elevation: 0

First Sales Date: 07/27/2017

Operator: HUNTINGTON ENERGY LLC 19961

908 NW 71ST ST
OKLAHOMA CITY, OK 73116-7402

Completion Type	
X	Single Zone
	Multiple Zone
	Commingled

Location Exception	
Order No	
666201	

Increased Density	
Order No	
There are no Increased Density records to display.	

Casing and Cement							
Type	Size	Weight	Grade	Feet	PSI	SAX	Top of CMT
SURFACE	8 5/8	24	J-55	878		360	SURFACE
PRODUCTION	5 1/2	17	N-80	10656		800	8364

Liner								
Type	Size	Weight	Grade	Length	PSI	SAX	Top Depth	Bottom Depth
There are no Liner records to display.								

Total Depth: 10656

Packer	
Depth	Brand & Type
There are no Packer records to display.	

Plug	
Depth	Plug Type
10015	CIBP

Initial Test Data

Test Date	Formation	Oil BBL/Day	Oil-Gravity (API)	Gas MCF/Day	Gas-Oil Ratio Cu FT/BBL	Water BBL/Day	Pumpin or Flowing	Initial Shut-In Pressure	Choke Size	Flow Tubing Pressure
Aug 03, 2017	HUNTON	6		20	3333	12	PUMPING			

Completion and Test Data by Producing Formation

Formation Name: HUNTON

Code: 269HNTN

Class: OIL

Spacing Orders

Order No	Unit Size
663165	640

Perforated Intervals

From	To
9850	9940

Acid Volumes

9,000 GALLONS 20% HCL

Fracture Treatments

There are no Fracture Treatments records to display.

Formation	Top
HART	8760
OSBORN	8980
WOODFORD	9500
HUNTON	9620
SYLVAN	9940
VIOLA	10042

Were open hole logs run? No

Date last log run:

Were unusual drilling circumstances encountered? No

Explanation:

Other Remarks

GAS WAS VENTED FROM JULY 12-26, 2017. NOTIFICATION SENT TO VIRGINIA HULLINGER AND GAYLAND DARITY WITH THE OKLAHOMA CORPORATION COMMISSION.

FOR COMMISSION USE ONLY

1137509

Status: Accepted

API NO. 3508721079
 OTC PROD. UNIT NO. 087084798

PLEASE TYPE OR USE BLACK INK ONLY
 NOTE:

Attach copy of original 1002A if recompletion or reentry.

OKLAHOMA CORPORATION COMMISSION
 Oil & Gas Conservation Division
 Post Office Box 52000
 Oklahoma City, Oklahoma 73152-2000

RECEIVED

Form 1002A Rev. 2009

AUG 25 2017

ORIGINAL
 AMENDED (Reason)

Recompletion

Rule 165:10-3-25
 COMPLETION REPORT

OKLAHOMA CORPORATION COMMISSION

TYPE OF DRILLING OPERATION
 STRAIGHT HOLE DIRECTIONAL HOLE HORIZONTAL HOLE
 SERVICE WELL

SPUD DATE 6/19/1984
 DRLG FINISHED DATE 7/11/1984
 DATE OF WELL COMPLETION 7-19-1984
 1st PROD DATE 7-29-84
 RECOMP DATE 7/7/2017
 Longitude (if known)
 OTC/OCC OPERATOR NO. 19961

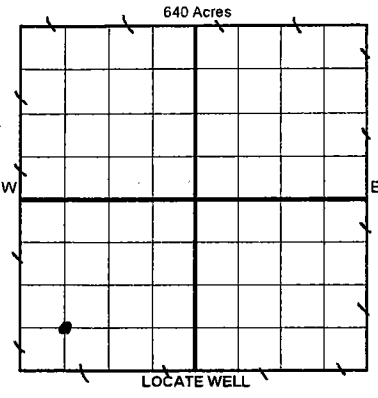

County McClain SEC 26 TWP 8N RGE 4W
 LEASE NAME Adkins WELL NO. 2-26
 1/4 C 1/4 SW 1/4 SW 1/4 FSL OF 1/4 SEC 660 FWL OF 1/4 SEC 660
 ELEVATION Derrick FL 1198 Ground Latitude (if known)
 OPERATOR NAME Huntington Energy, L.L.C. ADDRESS 908 N.W. 71st Street
 CITY Oklahoma City STATE OK ZIP 73116

COMPLETION TYPE
 SINGLE ZONE
 MULTIPLE ZONE Application Date
 COMMINGLED Application Date
 LOCATION EXCEPTION ORDER NO. 666201
 INCREASED DENSITY ORDER NO.

CASING & CEMENT (Form 1002C must be attached)

TYPE	SIZE	WEIGHT	GRADE	FEET	PSI	SAX	TOP OF CMT	
CONDUCTOR								
SURFACE	8 5/8"	24#	J-55	878'		360	Surface	
INTERMEDIATE								
PRODUCTION	5 1/2"	17#	N-80	10,656'		800	8,364'	
LINER								
							TOTAL DEPTH	10,656'

PACKER @ _____ BRAND & TYPE _____ PLUG @ CIBP TYPE 10,015 PLUG @ _____ TYPE _____
 PACKER @ _____ BRAND & TYPE _____ PLUG @ _____ TYPE _____ PLUG @ _____ TYPE _____

COMPLETION & TEST DATA BY PRODUCING FORMATION 169 HNTN

FORMATION	Hunton						No Frac
SPACING & SPACING ORDER NUMBER	663165/640						
CLASS: Oil, Gas, Dry, Inj, Disp, Comm Disp, Svc	Gas Oil	per GOR					
PERFORATED INTERVALS	9850'-9940'						
ACID/VOLUME	9000 gals 20% HCL						
FRACTURE TREATMENT (Fluids/Prop Amounts)							

Min Gas Allowable (165:10-17-7) OR Gas Purchaser/Measurer DCP
 First Sales Date 7/27/2017
 Oil Allowable (165:10-13-3)

INITIAL TEST DATA

INITIAL TEST DATE	8/3/2017				
OIL-BBL/DAY	6				
OIL-GRAVITY (API)					
GAS-MCF/DAY	20				
GAS-OIL RATIO CU FT/BBL	3333				
WATER-BBL/DAY	12				
PUMPING OR FLOWING	pumping				
INITIAL SHUT-IN PRESSURE					
CHOKE SIZE					
FLOW TUBING PRESSURE					

AS SUBMITTED

A record of the formations drilled through, and pertinent remarks are presented on the reverse. I declare that I have knowledge of the contents of this report and am authorized by my organization to make this report, which was prepared by me or under my supervision and direction, with the data and facts stated herein to be true, correct, and complete to the best of my knowledge and belief.

Catherine Smith
 SIGNATURE NAME (PRINT OR TYPE) 8/10/2017 (405) 840-9876
 DATE PHONE NUMBER
 908 N.W. 71st Street Oklahoma City OK 73116
 ADDRESS CITY STATE ZIP csmith@huntingtonenergy.com
 EMAIL ADDRESS

PLEASE TYPE OR USE BLACK INK ONLY

FORMATION RECORD

Give formation names and tops, if available, or descriptions and thickness of formations drilled through. Show intervals cored or drillstem tested.

LEASE NAME Adams

WELL NO. 2-26

NAMES OF FORMATIONS	TOP
Hart	8,760
Osborne	8,980
Woodford	9,500
Hunton	9,620
Sylvan	9,940
Viola	10,042

FOR COMMISSION USE ONLY

ITD on file YES NO

APPROVED _____ DISAPPROVED _____

2) Reject Codes _____

Were open hole logs run? yes no

Date Last log was run open hole-1984

Was CO₂ encountered? yes no at what depths? _____

Was H₂S encountered? yes no at what depths? _____

Were unusual drilling circumstances encountered? yes no
 If yes, briefly explain below _____

Other remarks: Gas was vented from July 12-26, 2017. Notification sent to Virginia Hullinger and Gayland Darity with the Oklahoma Corporation Commission.

640 Acres

If more than three drainholes are proposed, attach a separate sheet indicating the necessary information.

Direction must be stated in degrees azimuth. Please note, the horizontal drainhole and its end point must be located within the boundaries of the lease or spacing unit.

Directional surveys are required for all drainholes and directional wells.

640 Acres

BOTTOM HOLE LOCATION FOR DIRECTIONAL HOLE

SEC	TWP	RGE	COUNTY							
Spot Location				1/4	1/4	1/4	1/4	Feet From 1/4 Sec Lines	FSL	FWL
Measured Total Depth				True Vertical Depth		BHL From Lease, Unit, or Property Line:				

BOTTOM HOLE LOCATION FOR HORIZONTAL HOLE: (LATERALS)

LATERAL #1

SEC	TWP	RGE	COUNTY							
Spot Location				1/4	1/4	1/4	1/4	Feet From 1/4 Sec Lines	FSL	FWL
Depth of Deviation				Radius of Turn		Direction		Total Length		
Measured Total Depth				True Vertical Depth		BHL From Lease, Unit, or Property Line:				

LATERAL #2

SEC	TWP	RGE	COUNTY							
Spot Location				1/4	1/4	1/4	1/4	Feet From 1/4 Sec Lines	FSL	FWL
Depth of Deviation				Radius of Turn		Direction		Total Length		
Measured Total Depth				True Vertical Depth		BHL From Lease, Unit, or Property Line:				

LATERAL #3

SEC	TWP	RGE	COUNTY							
Spot Location				1/4	1/4	1/4	1/4	Feet From 1/4 Sec Lines	FSL	FWL
Depth of Deviation				Radius of Turn		Direction		Total Length		
Measured Total Depth				True Vertical Depth		BHL From Lease, Unit, or Property Line:				