

Oklahoma Corporation Commission
Oil & Gas Conservation Division
Post Office Box 52000
Oklahoma City, Oklahoma 73152-2000
Rule 165: 10-3-25

Form 1002A

API No.: 35019262790000

Completion Report

Spud Date: September 01, 2017

OTC Prod. Unit No.: 019-222463

Drilling Finished Date: October 28, 2017

1st Prod Date: December 22, 2017

Completion Date: December 17, 2017

Drill Type: HORIZONTAL HOLE

Well Name: DOC BROWN 3-30-19XH

Purchaser/Measurer:

Location: CARTER 30 3S 2W
NW NE SE SE
1090 FSL 535 FEL of 1/4 SEC
Derrick Elevation: 0 Ground Elevation: 0

First Sales Date:

Operator: AVALON OPERATING LLC 23929

15 W 6TH ST STE 2300
TULSA, OK 74119-5401

Completion Type	
X	Single Zone
	Multiple Zone
	Commingled

Location Exception	
Order No	
675196	

Increased Density	
Order No	
665646	
668316 NPT	
665645	
668315 NPT	

Casing and Cement							
Type	Size	Weight	Grade	Feet	PSI	SAX	Top of CMT
CONDUCTOR	20			100		10	SURFACE
SURFACE	13 3/8	54.5	J-55	1168	1500	710	SURFACE
INTERMEDIATE	9 5/8	40	P-110	8324	1500	370	6350
PRODUCTION	5 1/2	20	P-110	17160	7000	2440	4535

Liner								
Type	Size	Weight	Grade	Length	PSI	SAX	Top Depth	Bottom Depth
There are no Liner records to display.								

Total Depth: 17130

Packer	
Depth	Brand & Type
There are no Packer records to display.	

Plug	
Depth	Plug Type
There are no Plug records to display.	

Initial Test Data										
Test Date	Formation	Oil BBL/Day	Oil-Gravity (API)	Gas MCF/Day	Gas-Oil Ratio Cu FT/BBL	Water BBL/Day	Pumpin or Flowing	Initial Shut-In Pressure	Choke Size	Flow Tubing Pressure
Dec 25, 2017	WOODFORD	68	36.3	520	7647	406	JET LIFT	1000	64	125

Completion and Test Data by Producing Formation										
Formation Name: WOODFORD				Code: 319WDFD			Class: OIL			
Spacing Orders					Perforated Intervals					
Order No		Unit Size			From			To		
643868		640			9919			17120		
647308		640								
675005		MULTIUNIT								
Acid Volumes					Fracture Treatments					
NONE					220M BARRELS SLICK WATER, 7.7MM POUNDS SAND					

Formation	Top
WOODFORD	8754

Were open hole logs run? No

Date last log run:

Were unusual drilling circumstances encountered? No

Explanation:

Other Remarks
There are no Other Remarks.

Lateral Holes
Sec: 19 TWP: 3S RGE: 2W County: CARTER NW SE SW NW 2305 FNL 681 FWL of 1/4 SEC Depth of Deviation: 7558 Radius of Turn: 401 Direction: 336 Total Length: 8942 Measured Total Depth: 17130 True Vertical Depth: 7959 End Pt. Location From Release, Unit or Property Line: 681

FOR COMMISSION USE ONLY	
Status: Accepted	1140638

API NO. 019-26279
OTC PROD. 019-222463
UNIT NO.

PLEASE TYPE OR USE BLACK INK ONLY
NOTE:

Attach copy of original 1002A
if recompletion or reentry.

OKLAHOMA CORPORATION COMMISSION
Oil & Gas Conservation Division
Post Office Box 52000
Oklahoma City, Oklahoma 73152-2000
Rule 165:10-3-25

RECEIVED

AUG 20 2018

Form 1002A
Rev. 2009

☒ ORIGINAL
☐ AMENDED (Reason)

COMPLETION REPORT

TYPE OF DRILLING OPERATION

☐ STRAIGHT HOLE ☐ DIRECTIONAL HOLE ☒ HORIZONTAL HOLE
☐ SERVICE WELL

If directional or horizontal, see reverse for bottom hole location.

COUNTY	Carter	SEC	30	TWP	03S	RGE	02W
LEASE NAME	Doc Brown			WELL NO.	3-30-19	DATE	12/22/2017
NE 1/4 NE 1/4 SE 1/4 SE 1/4	FSL OF 1/4 SEC	1090	FEL OF 1/4 SEC	535	RECOMP DATE		
ELEVATION	Ground	Latitude (if known)		Longitude (if known)			
OPERATOR NAME	Avalon Operating, LLC			OTC/OCC OPERATOR NO.	23929		
ADDRESS	15 W. 6th Street, Suite 2300						
CITY	Tulsa	STATE	OK	ZIP	74119		

640 Acres									
W									
E									
X									

LOCATE WELL

COMPLETION TYPE

<input checked="" type="checkbox"/> SINGLE ZONE
<input type="checkbox"/> MULTIPLE ZONE
Application Date
COMINGLED
Application Date
LOCATION
EXCEPTION ORDER
INCREASED DENSITY
ORDER NO.

CASING & CEMENT (Form 1002C must be attached)

TYPE	SIZE	WEIGHT	GRADE	FEET	PSI	SAX	TOP OF CMT
CONDUCTOR	20			100		10 Yds	Surf
SURFACE	13 3/8	54.5	J-55	1168	1500	710	Surf
INTERMEDIATE	9 5/8	40	P-110	8,324	1500	370	6,350
PRODUCTION	5 1/2	20	P-110	17160	7000	2440	4535
LINER							

PACKER @ _____ BRAND & TYPE _____ PLUG @ _____ TYPE _____ PLUG @ _____ TYPE _____
PACKER @ _____ BRAND & TYPE _____ PLUG @ _____ TYPE _____ PLUG @ _____ TYPE _____

TOTAL DEPTH 17160

COMPLETION & TEST DATA BY PRODUCING FORMATION

FORMATION	WOODFORD
SPACING & SPACING ORDER NUMBER	32 - 640 - 643868
CLASS: Oil, Gas, Dry, Inj, Disp, Comm Disp, Svc	OIL
PERFORATED INTERVALS	9919-17120 FT
ACID/VOLUME	None
FRACTURE TREATMENT (Fluids/Prop Amounts)	200 MB slick water 7.7 MMLB Sand

Min Gas Allowable (165:10-17-7)

Gas Purchaser/Measurer

OR
Oil Allowable (165:10-13-3)

First Sales Date

INITIAL TEST DATA

INITIAL TEST DATE	12/25/2017
OIL-BBL/DAY	68
OIL-GRAVITY (API)	36.3
GAS-MCF/DAY	520
GAS-OIL RATIO CU FT/BBL	7647
WATER-BBL/DAY	406
PUMPING OR FLOWING	Jet Lift
INITIAL SHUT-IN PRESSURE	1000
CHOKE SIZE	64
FLOW TUBING PRESSURE	125

AS SUBMITTED

A record of the formations drilled through and pertinent remarks are presented on the reverse. I declare that I have knowledge of the contents of this report and am authorized by my organization to make this report which was prepared by me under my supervision and direction, with the data and facts stated herein to be true, correct, and complete to the best of my knowledge and belief.

SIGNATURE	Randall Sullivan	DATE	8/7/2017	PHONE NUMBER	918-523-0600
ADDRESS	15 W. 6th Street, Suite 2300	CITY	Tulsa	STATE	OK
ZIP	74119	EMAIL ADDRESS	risully@avalonoperating.com		

PLEASE TYPE OR USE BLACK INK ONLY

FORMATION RECORD

Give formation names and tops, if available, or descriptions and thickness of formations drilled through. Show intervals cored or drillstem tested.

NAMES OF FORMATIONS	TOP
Woodford @ MD 9449	8,754

LEASE NAME _____ WELL NO. _____

FOR COMMISSION USE ONLY	
ITD on file <input type="checkbox"/> YES <input type="checkbox"/> NO	
APPROVED _____ DISAPPROVED _____	2) Reject Codes

Were open hole logs run?	yes	<input checked="" type="checkbox"/> no
Date Last log was run	_____	
Was CO ₂ encountered?	yes	<input checked="" type="checkbox"/> no at what depths? _____
Was H ₂ S encountered?	yes	<input checked="" type="checkbox"/> no at what depths? _____
Were unusual drilling circumstances encountered?	yes	<input checked="" type="checkbox"/> no
If yes, briefly explain below		

Other remarks:

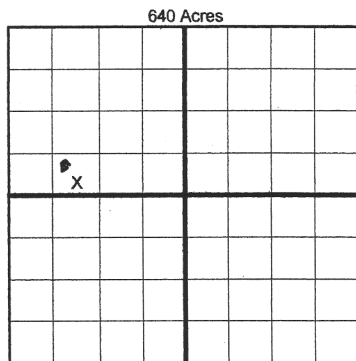

If more than three drainholes are proposed, attach a separate sheet indicating the necessary information.

Direction must be stated in degrees azimuth. Please note, the horizontal drainhole and its end point must be located within the boundaries of the lease or spacing unit.

Directional surveys are required for all drainholes and directional wells.

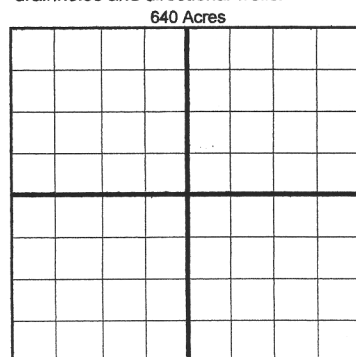

BOTTOM HOLE LOCATION FOR DIRECTIONAL HOLE

SEC	TWP	RGE	COUNTY
Spot Location	1/4	1/4	1/4
Measured Total Depth	True Vertical Depth		Feet From 1/4 Sec Lines FSL FWL
BHL From Lease, Unit, or Property Line:			

BOTTOM HOLE LOCATION FOR HORIZONTAL HOLE: (LATERALS)

LATERAL #1

SEC	TWP	RGE	COUNTY
19	3S	2W	CARTER
Spot Location	SE 1/4 SW 1/4 NW 1/4	Feet From 1/4 Sec Lines	FNL 2305 FWL 681
Depth of Deviation	7558	Radius of Turn	401
Measured Total Depth	17,130	True Vertical Depth	7,959
Direction 336 Total Length 8942			
BHL From Lease, Unit, or Property Line: 681			

LATERAL #2

SEC	TWP	RGE	COUNTY
Spot Location	1/4	1/4	1/4
Depth of Deviation	Radius of Turn		Direction
Measured Total Depth	True Vertical Depth		Total Length
BHL From Lease, Unit, or Property Line:			

LATERAL #3

SEC	TWP	RGE	COUNTY
Spot Location	1/4	1/4	1/4
Depth of Deviation	Radius of Turn		Direction
Measured Total Depth	True Vertical Depth		Total Length
BHL From Lease, Unit, or Property Line:			