

Oklahoma Corporation Commission
Oil & Gas Conservation Division
Post Office Box 52000
Oklahoma City, Oklahoma 73152-2000
Rule 165: 10-3-25

Form 1002A

API No.: 35119214120005

Completion Report

Spud Date: June 15, 1986

OTC Prod. Unit No.:

Drilling Finished Date: June 24, 1986

Amended

1st Prod Date:

Amend Reason: RECOMPLETE

Completion Date: July 10, 1986

Recomplete Date: April 23, 2018

Drill Type: STRAIGHT HOLE

Well Name: STATE 1-16

Purchaser/Measurer:

Location: PAYNE 16 18N 4E
C NE NW SE
2310 FSL 990 FWL of 1/4 SEC
Derrick Elevation: 0 Ground Elevation: 931

First Sales Date:

Operator: CHER OIL COMPANY LTD 7657

7317 S RIPLEY RD
RIPLEY, OK 74062-6227

Completion Type		Location Exception		Increased Density	
X	Single Zone	Order No		Order No	
	Multiple Zone	There are no Location Exception records to display.		There are no Increased Density records to display.	
	Commingled				

Casing and Cement							
Type	Size	Weight	Grade	Feet	PSI	SAX	Top of CMT
SURFACE	8 5/8	24		364		325	SURFACE
PRODUCTION	5 1/2	14	K-55	4600		295	3100

Liner								
Type	Size	Weight	Grade	Length	PSI	SAX	Top Depth	Bottom Depth
There are no Liner records to display.								

Total Depth: 4850

Packer		Plug	
Depth	Brand & Type	Depth	Plug Type
There are no Packer records to display.		4360	5-1/2 HP BRIDGE

Initial Test Data										
Test Date	Formation	Oil BBL/Day	Oil-Gravity (API)	Gas MCF/Day	Gas-Oil Ratio Cu FT/BBL	Water BBL/Day	Pumpin or Flowing	Initial Shut-In Pressure	Choke Size	Flow Tubing Pressure
Apr 27, 2018	BARTLESVILLE	6		35		100	PUMPING			

Completion and Test Data by Producing Formation

Formation Name: BARTLESVILLE

Code: 404BRVL

Class: OIL

Spacing Orders

Order No

Unit Size

There are no Spacing Order records to display.

Perforated Intervals

From

To

3752

3780

Acid Volumes

1,000 GALLONS 10% SME / HCL

Fracture Treatments

30,000 POUNDS 12/20 SAND, 515 BARRELS
SALTWATER

Formation	Top
LAYTON	2300
CHECKERBOARD	2935
CLEVELAND	2970
BIG LIME	3320
PRUE	3424
LOWER SKINNER	3600
PINK LIME	3644
RED FORK	3663
BARTLESVILLE	3766
MISSISSIPPIAN	3915
WOODFORD	4017
SYLVAN	4094
VIOLA	4123
ARBUCKLE	4600

Were open hole logs run? No

Date last log run:

Were unusual drilling circumstances encountered? No

Explanation:

Other Remarks

OCC - FORMERLY STATE SCHOOL LAND 1-16R, STATE 1-16 SWD, STATE SCHOOL LAND 1-16R SWD.

FOR COMMISSION USE ONLY

1139868

Status: Accepted

API NO. 119-21412
OTC PROD.
UNIT NO.

PLEASE TYPE OR USE BLACK INK ONLY
NOTE:

Attach copy of original 1002A
if recompletion or reentry.

OKLAHOMA CORPORATION COMMISSION
Oil & Gas Conservation Division
Post Office Box 52000
Oklahoma City, Oklahoma 73152-2000
Rule 165:10-3-25

RECEIVED

MAY 07 2018

OKLAHOMA CORPORATION
COMMISSION

Form 1002A
Rev. 2009

ORIGINAL
☒ AMENDED (Reason)

recomplete

COMPLETION REPORT

TYPE OF DRILLING OPERATION

☒ STRAIGHT HOLE ☐ DIRECTIONAL HOLE ☐ HORIZONTAL HOLE
☐ SERVICE WELL

If directional or horizontal, see reverse for bottom hole location.

COUNTY	Payne	SEC	16	TWP	18N	RGE	4E
LEASE NAME	State	WELL NO.	1-16				
C 1/4 Ne 1/4 NW 1/4 SE 1/4	FSL OF 1/4 SEC	2310	FWL OF 1/4 SEC	990			
ELEVATION N Derrick	Ground	931	Latitude (if known)				
OPERATOR NAME	Cher Oil Company, Ltd.			OTC/OCC OPERATOR NO.	7657		
ADDRESS	7317 S. Ripley Rd.						
CITY	Ripley	STATE	OK	ZIP	74062		

SPUD DATE 6-15-1986
DRLG FINISHED DATE 6-24-1986
DATE OF WELL COMPLETION 7-10-1986
1st PROD DATE
RECOMP DATE 04/23/2018
Longitude (if known)

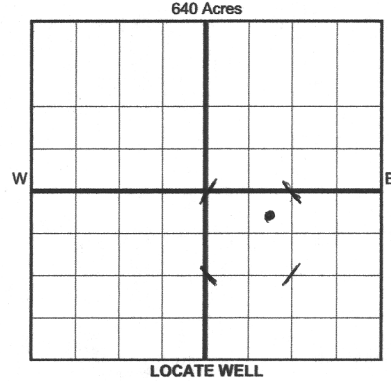

COMPLETION TYPE

☒ SINGLE ZONE
☐ MULTIPLE ZONE
Application Date
☐ COMMINGLED
Application Date
LOCATION
EXCEPTION ORDER
INCREASED DENSITY
ORDER NO.

CASING & CEMENT (Form 1002C must be attached)

TYPE	SIZE	WEIGHT	GRADE	FEET	PSI	SAX	TOP OF CMT
CONDUCTOR							
SURFACE	8 5/8	24		364		325	Surface
INTERMEDIATE							
PRODUCTION	5 1/2	14	K-55	4600		295	3100
LINER							

PACKER @ BRAND & TYPE PLUG @ 5-1/2 hc TYPE bridge PLUG @ 4360' TYPE
PACKER @ BRAND & TYPE PLUG @ TYPE PLUG @ TYPE
TOTAL DEPTH 4850

COMPLETION & TEST DATA BY PRODUCING FORMATION 404 BRVL

FORMATION	Bartlesville					
SPACING & SPACING ORDER NUMBER	none					
CLASS: Oil, Gas, Dry, Inj, Disp, Comm Disp, Svc	oil					
PERFORATED INTERVALS	3752-3780	2 holes per ft				
ACID/VOLUME	1000 gal. 10%	SME/HCL				
FRACTURE TREATMENT (Fluids/Prop Amounts)	30,000 lb 12/20	sand				
	515 bbis saltwater					

Min Gas Allowable (165:10-17-7)

Gas Purchaser/Measurer

First Sales Date

INITIAL TEST DATA

INITIAL TEST DATE	4/27/2018					
OIL-BBL/DAY	6 bbls					
OIL-GRAVITY (API)						
GAS-MCF/DAY	35 mcf					
GAS-OIL RATIO CU FT/BBL						
WATER-BBL/DAY	100 bbls					
PUMPING OR FLOWING	pumping					
INITIAL SHUT-IN PRESSURE						
CHOKE SIZE						
FLOW TUBING PRESSURE						

AS SUBMITTED

A record of the formations drilled through, and pertinent remarks are presented on the reverse. I declare that I have knowledge of the contents of this report and am authorized by my organization to make this report, which was prepared by me or under my supervision and direction, with the data and facts stated herein to be true, correct, and complete to the best of my knowledge and belief.

SIGNATURE Rick Nossaman
7317 S. Ripley Rd. Ripley OK 74062
ADDRESS CITY STATE ZIP
5/4/2018 405-820-4060
DATE PHONE NUMBER
cheroilcompany@gmail.com
EMAIL ADDRESS

FORMATION RECORD

LEASE NAME _____ WELL NO. _____

Were open hole logs run? ☐ yes ☐ no

Date Last log was run _____

Was CO₂ encountered? ☐ yes ☐ no at what depths? _____

Was H₂S encountered? ☐ yes ☐ no at what depths? _____

Were unusual drilling circumstances encountered? ☐ yes ☐ no

If yes, briefly explain below

Other remarks: *Arbuckle*

SEC	TWP	RGE	COUNTY			
Spot Location				Feet From 1/4 Sec Lines	FSL	FWL
1/4	1/4	1/4	1/4			
Depth of Deviation		Radius of Turn	Direction	Total Length		
Measured Total Depth		True Vertical Depth	BHL From Lease, Unit, or Property Line:			

640 Acres