

Oklahoma Corporation Commission  
 Oil & Gas Conservation Division  
 Post Office Box 52000  
 Oklahoma City, Oklahoma 73152-2000  
 Rule 165: 10-3-25

Form 1002A

API No.: 35027215000000

**Completion Report**

Spud Date: December 01, 2019

OTC Prod. Unit No.:

Drilling Finished Date: December 17, 2019

1st Prod Date:

Completion Date: April 17, 2020

**Drill Type: STRAIGHT HOLE**

Min Gas Allowable: Yes

Well Name: CONRADO 1-25

Purchaser/Measurer:

Location: CLEVELAND 25 10N 4W  
 SE NW NE SE  
 599 FNL 857 FEL of 1/4 SEC  
 Latitude: 35.310599 Longitude: -97.567783  
 Derrick Elevation: 1166 Ground Elevation: 1149

First Sales Date:

Operator: GULF EXPLORATION LLC 20983

9701 N BROADWAY EXT  
 OKLAHOMA CITY, OK 73114-6316

Completion Type	
X	Single Zone
	Multiple Zone
	Commingled

Location Exception
Order No
There are no Location Exception records to display.

Increased Density
Order No
There are no Increased Density records to display.

Casing and Cement							
Type	Size	Weight	Grade	Feet	PSI	SAX	Top of CMT
CONDUCTOR	16	44	A-242	40	500	6	SURFACE
SURFACE	8.625	24	J-55	966	1000	380	SURFACE
PRODUCTION	5.50	17	L-80	9715	4000	390	7020

Liner								
Type	Size	Weight	Grade	Length	PSI	SAX	Top Depth	Bottom Depth
There are no Liner records to display.								

**Total Depth: 9750**

Packer	
Depth	Brand & Type
8676	TXT / CRESCENT

Plug	
Depth	Plug Type
9020	CIBP
9165	CIBP
9400	CIBP
9560	CIBP

**Initial Test Data**

Test Date	Formation	Oil BBL/Day	Oil-Gravity (API)	Gas MCF/Day	Gas-Oil Ratio Cu FT/BBL	Water BBL/Day	Pumpin or Flowing	Initial Shut-In Pressure	Choke Size	Flow Tubing Pressure
Jan 21, 2020	ARBUCKLE	2				12	SWABBIN	130	N/A	
Feb 10, 2020	MCLISH	18	37			30	SWABBIN	1900	N/A	
Apr 06, 2020	TULIP CREEK	9	39			171	SWABBIN	2000	N/A	
May 17, 2020	WILCOX	23	38			115	SWABBIN	750	N/A	

**Completion and Test Data by Producing Formation**

Formation Name: ARBUCKLE

Code: 169ABCK

Class: DRY

**Spacing Orders**

Order No	Unit Size
688796	160

**Perforated Intervals**

From	To
9600	9602

**Acid Volumes**

500 GALLONS 15% NEFE

**Fracture Treatments**

NONE

Formation Name: OIL CREEK

Code: 202OLCK

Class: DRY

**Spacing Orders**

Order No	Unit Size
688796	160

**Perforated Intervals**

From	To
9444	9446

**Acid Volumes**

NONE

**Fracture Treatments**

NONE

Formation Name: MCLISH

Code: 202MCLS

Class: DRY

**Spacing Orders**

Order No	Unit Size
698905	160

**Perforated Intervals**

From	To
9176	9248

**Acid Volumes**

2,000 GALLONS 7.5%

**Fracture Treatments**

10,750 GALLONS XLINK, 10,500 POUNDS 20/40 WHITE SAND

Formation Name: TULIP CREEK

Code: 202TPCK

Class: DRY

**Spacing Orders**

Order No	Unit Size
688796	160

**Perforated Intervals**

From	To
9047	9112

**Acid Volumes**

1,500 GALLONS 15%

**Fracture Treatments**

NONE

Formation Name: WILCOX

Code: 202WLCX

Class: OIL

**Spacing Orders**

Order No	Unit Size
698905	160

**Perforated Intervals**

From	To
8738	8740

**Acid Volumes**

500 GALLONS 7.5%
------------------

**Fracture Treatments**

NONE
------

Formation	Top
BASAL PENNSYLVANIAN	7750
HUNTON	7895
VIOLA	8358
WILCOX	8738
TULIP CREEK	9047
MCLISH	9176
OIL CREEK	9444
ARBUCKLE	9750

Were open hole logs run? Yes

Date last log run: December 16, 2019

Were unusual drilling circumstances encountered? No

Explanation:

**Other Remarks**

OCC - OPERATOR REPORTS WAITING ON PIPELINE FOR 1ST SALES.

**FOR COMMISSION USE ONLY**

1145218

Status: Accepted

API NO. 027-21500  
OTC PROD.  
UNIT NO.

PLEASE TYPE OR USE BLACK INK ONLY

NOTE:

Attach copy of original 1002A if recompletion or reentry.

OKLAHOMA CORPORATION COMMISSION  
Oil & Gas Conservation Division  
Post Office Box 52000  
Oklahoma City, Oklahoma 73152-2000  
Rule 165:10-3-25

ORIGINAL  
 AMENDED (Reason)

COMPLETION REPORT

TYPE OF DRILLING OPERATION

STRAIGHT HOLE  DIRECTIONAL HOLE  HORIZONTAL HOLE  
 SERVICE WELL

If directional or horizontal, see reverse for bottom hole location.

COUNTY	CLEVELAND	SEC	25	TWP	10N	RGE	4W	SPUD DATE	12/1/2019	
LEASE NAME	CONRADO			WELL NO.	1-25			DRLG FINISHED DATE	12/17/2019	
SE 1/4 NW 1/4 NE 1/4 SE 1/4	FNL OF 1/4 SEC	599	FEL OF 1/4 SEC	857	DATE OF WELL COMPLETION	4/17/2020			1st PROD DATE	WOPL
ELEVATION Derrick FL	1166	Ground	1149	Latitude (if known)	35.310599			Longitude (if known)	-97.567783	
OPERATOR NAME	GULF EXPLORATION, L.L.C.				OTC/OCC OPERATOR NO.	20983-0				
ADDRESS	9701 N. Broadway Extension									
CITY	Oklahoma City	STATE	OK	ZIP	73114					

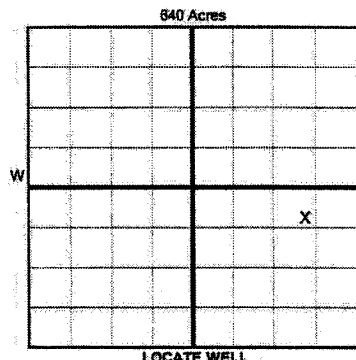

COMPLETION TYPE

<input checked="" type="checkbox"/> SINGLE ZONE
<input type="checkbox"/> MULTIPLE ZONE Application Date
<input type="checkbox"/> COMMINGLED Application Date
LOCATION
EXCEPTION ORDER
INCREASED DENSITY ORDER NO.

CASING & CEMENT (Form 1002C must be attached)

TYPE	SIZE	WEIGHT	GRADE	FEET	PSI	SAX	TOP OF CMT	
CONDUCTOR	16"	44	A242	40	500	6 CuYd	Surface	
SURFACE	8.625"	24	J55	972 966	1000	380	Surface	
INTERMEDIATE								
PRODUCTION	5.50"	17	L80	973 9715	4000	390	7020	
LINER								
							TOTAL DEPTH	9,750

PACKER @ 8,676 BRAND & TYPE TXT/Crescent PLUG @ 9560 TYPE CIBP PLUG @ 9165 TYPE CIBP  
PACKER @ BRAND & TYPE PLUG @ 9400 TYPE CIBP PLUG @ 9020 TYPE CIBP

COMPLETION & TEST DATA BY PRODUCING FORMATION

FORMATION	Arbuckle	Oil Creek	McLish	Tulip Creek	Wilcox
SPACING & SPACING ORDER NUMBER	688796 (160 ac.)	688796 (160 ac.)	688796 (160 ac.)	688796 (160 ac.)	688796 (160 ac.)
CLASS: Oil, Gas, Dry, Inj, Disp, Comm Disp, Svc	Dry	Dry	Oil Dry below plug	Oil Dry below plug	Oil
PERFORATED INTERVALS	9600-9602	9444-9446	9176-9248	9047-9112	8738-8740
ACID VOLUME	500 Gal 15% NeFe	None	2000 Gal 7.5%	1500 Gal 15%	500 Gal 7.5%
FRACTURE TREATMENT (Fluids/Prop Amounts)	None	None	10500# 20/40 White Sand	None	None

*Reported to  
Flare Focus*

Min Gas Allowable OR Oil Allowable (165:10-13-3) Gas Purchaser/Measurer First Sales Data (165:10-17-7)

INITIAL TEST DATA

INITIAL TEST DATE	1/21/2020	None	2/10/2020	4/6/2020	4/17/2020
OIL-BBL/DAY	2		18	9	23
OIL-GRAVITY ( API)	Unknown		37	39	38
GAS-MCF/DAY	None		TSTM	TSTM	TSTM
GAS-OIL RATIO CU FT/BBL	0:2		N/A	N/A	N/A
WATER-BBL/DAY	12		30	171	115
PUMPING OR FLOWING	SWABBING		SWABBING	SWABBING	SWABBING
INITIAL SHUT-IN PRESSURE	130 PSI		1900 PSI	2000 PSI	750 PSI
CHOKE SIZE	N/A		N/A	N/A	N/A
FLOW TUBING PRESSURE	N/A		N/A	N/A	N/A

A record of the formations drilled through and pertinent remarks are presented on the reverse. I declare that I have knowledge of the contents of this report and am authorized by my organization to make this report which was prepared by me or under my supervision and direction, with the data and facts stated herein to be true, correct, and complete to the best of my knowledge and belief.

SIGNATURE: *[Signature]* NAME (PRINT OR TYPE): JJ Simonsen DATE: 5/11/2020 PHONE NUMBER: 405-840-3371  
ADDRESS: 9701 N. Broadway Extension CITY: Oklahoma City STATE: OK ZIP: 73114 EMAIL ADDRESS: jsimonsen@gulfeexploration.com

PLEASE TYPE OR USE BLACK INK ONLY  
FORMATION RECORD

Give formation names and tops, if available, or descriptions and thickness of formations drilled through. Show intervals cored or drillstem tested.

LEASE NAME CONRADO WELL NO. 1-25

NAMES OF FORMATIONS	TOP
Basal Pennsylvanian	7,750
Hunton	7,895
Viola	8,358
Wilcox	8,738
Tulip Creek	9,047
McLish	9,176
Oil Creek	9,444
Arbuckle	9,496
TD	9,750

FOR COMMISSION USE ONLY

ITD on file  YES  NO

APPROVED \_\_\_\_\_ DISAPPROVED \_\_\_\_\_

2) Reject Codes \_\_\_\_\_  
\_\_\_\_\_  
\_\_\_\_\_  
\_\_\_\_\_

Were open hole logs run?  yes  no

Date Last log was run 12/16/2019

Was CO<sub>2</sub> encountered?  yes  no at what depths? \_\_\_\_\_

Was H<sub>2</sub>S encountered?  yes  no at what depths? \_\_\_\_\_

Were unusual drilling circumstances encountered?  yes  no

If yes, briefly explain below \_\_\_\_\_

Other remarks: \_\_\_\_\_  
\_\_\_\_\_  
\_\_\_\_\_  
\_\_\_\_\_  
\_\_\_\_\_

640 Acres

If more than three drainholes are proposed, attach a separate sheet indicating the necessary information.

Direction must be stated in degrees azimuth. Please note, the horizontal drainhole and its end point must be located within the boundaries of the lease or spacing unit.

Directional surveys are required for all drainholes and directional wells.

640 Acres

BOTTOM HOLE LOCATION FOR DIRECTIONAL HOLE

SEC	TWP	RGE	COUNTY	Spot Location		FSL	FWL
				1/4	1/4		
Measured Total Depth		True Vertical Depth		BHL From Lease, Unit, or Property Line:			

BOTTOM HOLE LOCATION FOR HORIZONTAL HOLE: (LATERALS)

LATERAL #1

SEC	TWP	RGE	COUNTY	Spot Location		FSL	FWL
				1/4	1/4		
Depth of Deviation		Radius of Turn	Direction	Total Length			
Measured Total Depth		True Vertical Depth		BHL From Lease, Unit, or Property Line:			

LATERAL #2

SEC	TWP	RGE	COUNTY	Spot Location		FSL	FWL
				1/4	1/4		
Depth of Deviation		Radius of Turn	Direction	Total Length			
Measured Total Depth		True Vertical Depth		BHL From Lease, Unit, or Property Line:			

LATERAL #3

SEC	TWP	RGE	COUNTY	Spot Location		FSL	FWL
				1/4	1/4		
Depth of Deviation		Radius of Turn	Direction	Total Length			
Measured Total Depth		True Vertical Depth		BHL From Lease, Unit, or Property Line:			