

Oklahoma Corporation Commission
Oil & Gas Conservation Division
Post Office Box 52000
Oklahoma City, Oklahoma 73152-2000
Rule 165: 10-3-25

Form 1002A

API No.: 35051220920005

Completion Report

Spud Date: November 02, 1990

OTC Prod. Unit No.: 051-95247-0-0000

Drilling Finished Date: January 26, 1991

Amended

1st Prod Date: March 05, 1992

Amend Reason: RECOMPLETION

Completion Date: April 29, 1991

Recomplete Date: March 17, 2020

Drill Type: STRAIGHT HOLE

Min Gas Allowable: Yes

Well Name: MCCLURE 1-31

Purchaser/Measurer: DCP

Location: GRADY 31 4N 5W
NE SW SW SW
400 FSL 400 FWL of 1/4 SEC
Derrick Elevation: 1279 Ground Elevation: 1255

First Sales Date:

Operator: GULF EXPLORATION LLC 20983

9701 N BROADWAY EXT
OKLAHOMA CITY, OK 73114-6316

Completion Type	
X	Single Zone
	Multiple Zone
	Commingled

Location Exception	
Order No	
350358	

Increased Density	
Order No	
There are no Increased Density records to display.	

Casing and Cement							
Type	Size	Weight	Grade	Feet	PSI	SAX	Top of CMT
CONDUCTOR	20	62.7	A	43		10	SURFACE
SURFACE	9.625	47	N-80	2000		400	SURFACE
PRODUCTION	5.50	17	N-80	10421		360	3900

Liner								
Type	Size	Weight	Grade	Length	PSI	SAX	Top Depth	Bottom Depth
There are no Liner records to display.								

Total Depth: 10421

Packer	
Depth	Brand & Type
5445	OTIS "MH"

Plug	
Depth	Plug Type
6000	CIBP

Initial Test Data

Test Date	Formation	Oil BBL/Day	Oil-Gravity (API)	Gas MCF/Day	Gas-Oil Ratio Cu FT/BBL	Water BBL/Day	Pumpin or Flowing	Initial Shut-In Pressure	Choke Size	Flow Tubing Pressure
Mar 18, 2020	SPRINGER					26	SWABBIN	250		

Completion and Test Data by Producing Formation

Formation Name: SPRINGER

Code: 401SPRG

Class: DRY

Spacing Orders

Order No	Unit Size
NONE	

Perforated Intervals

From	To
5268	5272

Acid Volumes

1,200 GALLONS 7.5% ACID

Fracture Treatments

NONE

Formation	Top
SPRINGER	5000
SPRINGER (DEEP)	10000

Were open hole logs run? Yes

Date last log run: February 05, 1991

Were unusual drilling circumstances encountered? No

Explanation:

Other Remarks

OCC - THIS SPRINGER IS UNSPACED SO THE WELL IS COMPLETED ON A LEASE BASIS. SPACING ON SPRINGER IS FOR DEEP SPRINGER AT 11,250' BY ORDER 123827 AND DOWNTHRUSTED SPRINGER AT A DEPTH OF 12,200' BY ORDER 294593.

FOR COMMISSION USE ONLY

1145219

Status: Accepted

API NO. **05122092-X**
 OTC PROD. UNIT NO. **051-95247**
 NOTE: Attach copy of original 1002A if recompletion or reentry.

OKLAHOMA CORPORATION COMMISSION
 Oil & Gas Conservation Division
 Post Office Box 52000
 Oklahoma City, Oklahoma 73162-2000
 Rule 165:10-3-25

ORIGINAL
 AMENDED (Reason): **RECOMPLETION**

COMPLETION REPORT

TYPE OF DRILLING OPERATION
 STRAIGHT HOLE DIRECTIONAL HOLE HORIZONTAL HOLE
 SERVICE WELL
 If directional or horizontal, see reverse for bottom hole location.

SPUD DATE **11/2/1990**
 DRLG FINISHED DATE **1/26/1991**
 DATE OF WELL COMPLETION **4/29/1991**
 1st PROD DATE **3/5/1992**
 RECOMP DATE **3/17/2020**
 Longitude (if known)

COUNTY **Grady** SEC **31** TWP **04N** RGE **05W**
 LEASE NAME **McCLURE** WELL NO. **1-31**
 NE 1/4 SW 1/4 SW 1/4 SW 1/4 FSL OF 1/4 SEC **400** FWL OF 1/4 SEC **400**
 ELEVATION Derrick FL **1279** Ground **1255** Latitude (if known) Longitude (if known)
 OPERATOR NAME **GULF EXPLORATION, L.L.C.** OTC/OCC OPERATOR NO. **20983-0**
 ADDRESS **9701 N. Broadway Extension**
 CITY **Oklahoma City** STATE **Oklahoma** ZIP **73114**

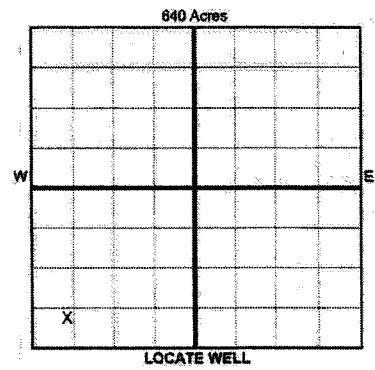

COMPLETION TYPE
 SINGLE ZONE
 MULTIPLE ZONE
 COMMINGLED
 LOCATION EXCEPTION ORDER INCREASED DENSITY ORDER NO.

CASING & CEMENT (Form 1002C must be attached)

TYPE	SIZE	WEIGHT	GRADE	FEET	PSI	SAX	TOP OF CMT
CONDUCTOR	20	62.7#	A	43		10 Syds	Surface
SURFACE	9.625"	47#	N80	2000		400	Surface
INTERMEDIATE							
PRODUCTION	5.50"	17#	N80	10421		360	3900
LINER							

PACKER @ **5,445** BRAND & TYPE **Otis "MH"** PLUG @ **6000** TYPE **CIBP** PLUG @ _____ TYPE _____ TOTAL DEPTH **10,421**
 PACKER @ _____ BRAND & TYPE _____ PLUG @ _____ TYPE _____ PLUG @ _____ TYPE _____

COMPLETION & TEST DATA BY PRODUCING FORMATION **401 SPRG**

FORMATION **Cunningham (Springer)** **No Frac**
 SPACING & SPACING ORDER NUMBER **none - 294593 (160 ac) for Deep Springer at 11250'**
 CLASS: Oil, Gas, Dry, Inj, Disp, Comm Disp, Svc **Dry**
 PERFORATED INTERVALS **5268-5272**
 ACID/VOLUME **1200 Gal 7.5% Acid**
 FRACTURE TREATMENT (Fluids/Prop Amounts) **None**

Min Gas Allowable (165:10-17-7) OR Gas Purchaser/Measurer **DCP**
 Oil Allowable (165:10-13-3) First Sales Date _____

INITIAL TEST DATA

INITIAL TEST DATE	3/18/2020
OIL-BBL/DAY	0
OIL-GRAVITY (API)	N/A
GAS-MCF/DAY	0
GAS-OIL RATIO CU FT/BBL	N/A
WATER-BBL/DAY	26
PUMPING OR FLOWING	Swabbing
INITIAL SHUT-IN PRESSURE	250
CHOKE SIZE	
FLOW TUBING PRESSURE	N/A

A record of the conditions drilled through, and pertinent remarks are presented on the reverse. I declare that I have knowledge of the contents of this report and am authorized by my organization to make this report, which was prepared by me or under my supervision and direction, with the data and facts stated herein to be true, correct, and complete to the best of my knowledge and belief.

JJ Simonsen 5/11/2020 405-840-3371
 SIGNATURE NAME (PRINT OR TYPE) DATE PHONE NUMBER
 9701 N. Broadway Extension Oklahoma City OK 73114
 ADDRESS CITY STATE ZIP EMAIL ADDRESS **jsimonsen@gulfoxploration.com**

PLEASE TYPE OR USE BLACK INK ONLY
FORMATION RECORD

Give formation names and tops, if available, or descriptions and thickness of formations drilled through. Show intervals cored or drillstem tested.

LEASE NAME McCLURE WELL NO. 1-31

NAMES OF FORMATIONS	TOP
Morrow-Springer	5,000
Morrow-Springer (Deep)	10,000
TD	10,421

FOR COMMISSION USE ONLY

ITD on file YES NO

APPROVED _____ DISAPPROVED _____

2) Reject Codes _____

Were open hole logs run? yes no

Date Last log was run 2/5/1991

Was CO₂ encountered? yes no at what depths? _____

Was H₂S encountered? yes no at what depths? _____

Were unusual drilling circumstances encountered? yes no
If yes, briefly explain below

Other remarks:

840 Acres

If more than three drainholes are proposed, attach a separate sheet indicating the necessary information.

Direction must be stated in degrees azimuth. Please note, the horizontal drainhole and its end point must be located within the boundaries of the lease or spacing unit.

Directional surveys are required for all drainholes and directional wells.

840 Acres

BOTTOM HOLE LOCATION FOR DIRECTIONAL HOLE

SEC	TWP	RGE	COUNTY			
Spot Location	1/4	1/4	1/4	Feet From 1/4 Sec Lines	FSL	FWL
Measured Total Depth	True Vertical Depth		BHL From Lease, Unit, or Property Line:			

BOTTOM HOLE LOCATION FOR HORIZONTAL HOLE: (LATERALS)

LATERAL #1

SEC	TWP	RGE	COUNTY			
Spot Location	1/4	1/4	1/4	Feet From 1/4 Sec Lines	FSL	FWL
Depth of Deviation	Radius of Turn		Direction	Total Length		
Measured Total Depth	True Vertical Depth		BHL From Lease, Unit, or Property Line:			

LATERAL #2

SEC	TWP	RGE	COUNTY			
Spot Location	1/4	1/4	1/4	Feet From 1/4 Sec Lines	FSL	FWL
Depth of Deviation	Radius of Turn		Direction	Total Length		
Measured Total Depth	True Vertical Depth		BHL From Lease, Unit, or Property Line:			

LATERAL #3

SEC	TWP	RGE	COUNTY			
Spot Location	1/4	1/4	1/4	Feet From 1/4 Sec Lines	FSL	FWL
Depth of Deviation	Radius of Turn		Direction	Total Length		
Measured Total Depth	True Vertical Depth		BHL From Lease, Unit, or Property Line:			