

Oklahoma Corporation Commission
Oil & Gas Conservation Division
Post Office Box 52000
Oklahoma City, Oklahoma 73152-2000
Rule 165: 10-3-25

Form 1002A

API No.: 35139350630006

Completion Report

Spud Date: May 26, 2005

OTC Prod. Unit No.:

Drilling Finished Date: July 11, 2005

Amended

1st Prod Date:

Amend Reason: TEMPORARILY ABANDONED WELL

Completion Date: July 27, 2005

Recomplete Date: June 23, 2020

Drill Type: STRAIGHT HOLE

Well Name: HOUGH MORROW A UNIT (WELCH 3) 214

Purchaser/Measurer:

Location: TEXAS 13 5N 13E CM
C NW SE
1980 FSL 660 FWL of 1/4 SEC
Latitude: 36.89757 Longitude: -101.60229
Derrick Elevation: 3327 Ground Elevation: 3317

First Sales Date:

Operator: BREITBURN OPERATING LP 23249

1111 BAGBY ST STE 1600
HOUSTON, TX 77002-2547

Completion Type	
X	Single Zone
	Multiple Zone
	Commingled

Location Exception	
Order No	
There are no Location Exception records to display.	

Increased Density	
Order No	
There are no Increased Density records to display.	

Casing and Cement							
Type	Size	Weight	Grade	Feet	PSI	SAX	Top of CMT
CONDUCTOR	13 3/8	48	H-40	518		320	SURFACE
SURFACE	8 5/8	24	H-40	1779		175	SURFACE
PRODUCTION	5 1/2	15.5	J-55	6601		125	1930

Liner								
Type	Size	Weight	Grade	Length	PSI	SAX	Top Depth	Bottom Depth
LINER	4		FJ	636	0	5	5654	6290

Total Depth: 6717

Packer	
Depth	Brand & Type
There are no Packer records to display.	

Plug	
Depth	Plug Type
3017	RBP
3988	CICR

Initial Test Data

Test Date	Formation	Oil BBL/Day	Oil-Gravity (API)	Gas MCF/Day	Gas-Oil Ratio Cu FT/BBL	Water BBL/Day	Pumpin or Flowing	Initial Shut-In Pressure	Choke Size	Flow Tubing Pressure
-----------	-----------	-------------	-------------------	-------------	-------------------------	---------------	-------------------	--------------------------	------------	----------------------

There are no Initial Data records to display.

Completion and Test Data by Producing Formation

Formation Name: MORROW A

Code: 402MRRWA

Class: TA

Spacing Orders

Order No	Unit Size
There are no Spacing Order records to display.	

Perforated Intervals

From	To
6163	6187

Acid Volumes

There are no Acid Volume records to display.
--

Fracture Treatments

There are no Fracture Treatments records to display.
--

Formation	Top
-----------	-----

Were open hole logs run? No

Date last log run:

Were unusual drilling circumstances encountered? No

Explanation:

Other Remarks

CEMENT RETAINER SET AT 3,890', 150 SACKS OF CEMENT SQUEEZED BELOW FROM 3,988' TO 4,510', THEN 25 SACKS @ 3,661' - 3,629'. OCC - UIC PERMIT NUMBER 200500336 TERMINATED JUNE 23, 2020. OCC - ORIGINAL 1002A SHOWS DV TOOL SET IN 5 1/2" CASING AT 2,950' AND CEMENTED WITH 115 SACKS CEMENT. WELL PLUGGED JUNE 21, 1995. 5 1/2" CASING SHOT OFF AT 1,974'. RE-ENTERED MAY 25, 2005 SETTING 4" CASING TO 6,290', CEMENTED WITH 44 SACKS CEMENT. NEW SQUEEZE ON 5 1/2" CASING AT 3,988' USING 150 SACKS CEMENT, THEN SQUEEZED OFF LEAK BETWEEN 3,629' TO 3,661'.

FOR COMMISSION USE ONLY

1145856

Status: Accepted

Submitted
11-20-2020
DKA

Form 1002A
Rev 2020

Oil and Gas Conservation Division
P.O. Box 52000
Oklahoma City, OK 73152-2000
405-522-0577
OCCCentralProcessing@OCC.OK.GOV

ORIGINAL
 AMENDED (Reason) _____ TAG No. _____ Rule 165:10-3-25
COMPLETION REPORT

TYPE OF DRILLING OPERATION
 STRAIGHT HOLE DIRECTIONAL HOLE HORIZONTAL HOLE
 SERVICE WELL
 If directional or horizontal, see reverse for bottom hole location.

COUNTY Texas SEC 13 TWP 5N RGE 13 ECM
 LEASE NAME Hough Morrow A Unit WELL NO 214
 1/4 C 1/4 NW 1/4 SE 1/4 FSL 1980 FWL 660
 ELEVATION 3327 Ground 3317 Latitude 36.89757 Longitude -101.60229
 OPERATOR NAME Bretburn Operating LP DTC/OCC OPERATOR NO 23249
 ADDRESS 1111 Bagby Street Suite 1600
 CITY Houston STATE TX ZIP 77002

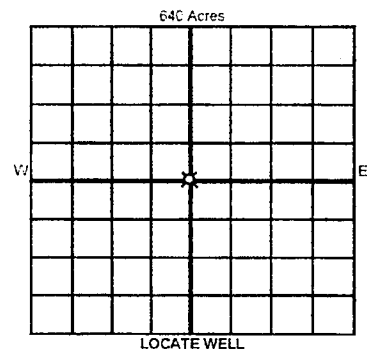

COMPLETION TYPE
 SINGLE ZONE
 MULTIPLE ZONE
 CUMINGLED
 LOCATION EXCEPTION
 MULTIUNIT ORDER NO
 INCREASED DENSITY

CASING & CEMENT (Attach Form 1002C)

TYPE	SIZE	WEIGHT	GRADE	FEET	PSI	SAX	TOP OF CMT
CONDUCTOR	13 3/8	48	H-40	518		320	Surf
SURFACE	8 5/8	24	H-40	1779		175	Surf
INTERMEDIATE							
PRODUCTION	5 1/2	15.5	J-55	6601		125	1930
LINER	4		FJ	5654-6290		5.1	5654

PACKER @ _____ BRAND & TYPE _____ PLUG @ _____ TYPE _____ CCR _____ PLUG @ _____ TYPE _____ TOTAL _____
 PACKER @ _____ BRAND & TYPE _____ PLUG @ _____ TYPE _____ REP _____ PLUG @ _____ TYPE _____ DEPTH 6297 6717 per original 1002A

COMPLETION & TEST DATA BY PRODUCING FORMATION - 402 MRRWA

FORMATION	SPACING & SPACING ORDER NUMBER	CLASS: Oil, Gas, Dry, Inj; Disp, Comm Disp, Svc	PERFORATED INTERVALS	ACID/VOLUME	FRACTURE TREATMENT (Fluids/Prop Amounts)
Morrow A	200500336 → (see remarks)	inj TA	6163-6187		

Min Gas Allowable (165:10-17-7) OR Oil Allowable (165:10-13-3) Purchaser/Measurer _____ First Sales Date _____

INITIAL TEST DATA

INITIAL TEST DATE	OIL-BBL/DAY	OIL-GRAVITY (API)	GAS-MCF/DAY	GAS-OIL RATIO CU FT/BBL	WATER-BBL/DAY	PUMPING OR FLOWING	INITIAL SHUT-IN PRESSURE	CHOKER SIZE	FLOW TUBING PRESSURE

A record of the formations drilled through, and pertinent remarks are presented on the reverse. I declare that I have knowledge of the contents of this report and am authorized by my organization to make this report, which was prepared by me or under my supervision and direction, with the data and facts stated herein to be true, correct, and complete to the best of my knowledge and belief.

SIGNATURE: Austin Trammell NAME (PRINT OR TYPE)
 1111 Bagby Street Suite 1600 Houston TX 77002
 ADDRESS CITY STATE ZIP
 DATE: 11/20/2020 PHONE NUMBER: 713-437-8043
 EMAIL ADDRESS: austin.trammell@mavresources.com

PLEASE TYPE OR USE BLACK INK ONLY
FORMATION RECORD

Give formation names and tops, if available, or descriptions and thickness of formations drilled through. Show intervals cored or drillstem tested.

LEASE NAME _____ WELL NO. _____

NAMES OF FORMATIONS	TOP
(see original 1002A's)	

FOR COMMISSION USE ONLY

ITC on file YES NO

APPROVED _____ DISAPPROVED _____ 2) Reject Codes _____

Were open hole logs run? yes no

Date Last log was run _____

Was CO encountered? yes no at what depths? _____

Was H S encountered? yes no at what depths? _____

Were unusual drilling circumstances encountered? yes no
if yes, briefly explain below: _____

Other remarks: Cement Retainer set at 3890', 150 sacks of cement squeezed below from 3988' to 4510', then 25 sacks @ 3661'-3629'.
 OCC - UIC permit # 200500336 terminated 6-23-2020
 OCC - original 1002A shows DV tool set in 5 1/2" casing at 2950' and cement with 115 sacks cement. Well plugged 6-21-1995 5 1/2" casing shot off at 1974'. Re-entered 5-25-2005 setting 4" casing to 6290 cement with 44 sacks cement. New squeeze on 5 1/2" casing at 3988 using 150 sacks cement then squeezed off leak between 3629' to 3661'.

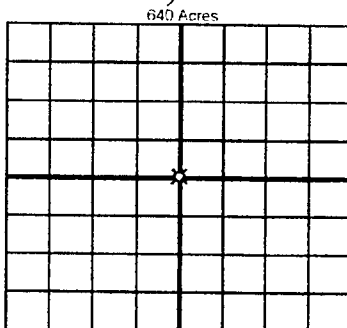

If more than three drainholes are proposed, attach a separate sheet indicating the necessary information

Direction must be stated in degrees azimuth. Please note, the horizontal drainhole and its end point must be located within the boundaries of the lease or spacing unit.

Directional surveys are required for all drainholes and directional wells

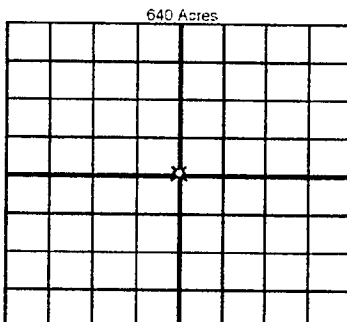

BOTTOM HOLE LOCATION FOR DIRECTIONAL HOLE

SEC	TWP	RGE	COUNTY	Feet From 1/4 Sec Lines		
1/4	1/4	1/4	1/4			
Measured Total Depth		True Vertical Depth		BHL From Lease, Unit, or Property Line:		

BOTTOM HOLE LOCATION FOR HORIZONTAL HOLE: (LATERALS)

LATERAL #1

SEC	TWP	RGE	COUNTY	Feet From 1/4 Sec Lines		
1/4	1/4	1/4	1/4			
Depth of Deviation		Radius of Turn		Direction		Total Length
Measured Total Depth		True Vertical Depth		BHL From Lease, Unit, or Property Line:		

LATERAL #2

SEC	TWP	RGE	COUNTY	Feet From 1/4 Sec Lines		
1/4	1/4	1/4	1/4			
Depth of Deviation		Radius of Turn		Direction		Total Length
Measured Total Depth		True Vertical Depth		BHL From Lease, Unit, or Property Line:		

LATERAL #3

SEC	TWP	RGE	COUNTY	Feet From 1/4 Sec Lines		
1/4	1/4	1/4	1/4			
Depth of Deviation		Radius of Turn		Direction		Total Length
Measured Total Depth		True Vertical Depth		BHL From Lease, Unit, or Property Line:		