

OKLAHOMA CORPORATION COMMISSION  
OIL & GAS CONSERVATION DIVISION  
P.O. BOX 52000  
OKLAHOMA CITY, OK 73152-2000  
(Rule 165:10-3-1)

API NUMBER: 037 29476

Approval Date: 04/27/2021

Expiration Date: 10/27/2022

Straight Hole Oil & Gas

**PERMIT TO DRILL**

WELL LOCATION: Section: 29 Township: 15N Range: 9E County: CREEK

SPOT LOCATION:  SW  NE  SE  NE FEET FROM QUARTER: FROM NORTH FROM EAST  
SECTION LINES: 1658 475

Lease Name: VANORS DOL Well No: 3 Well will be 338 feet from nearest unit or lease boundary.

Operator Name: WFD OIL CORPORATION Telephone: 4057153130 OTC/OCC Number: 17501 0

WFD OIL CORPORATION  
16800 CONIFER LN  
EDMOND, OK 73012-0619

FRANKLIN GENE AND SHARON KAY VANORS DOL  
34140 W 281ST SOUTH  
BRISTOW OK 74010

Formation(s) (Permit Valid for Listed Formations Only):

Name	Code	Depth
1 TRUE LAYTON	405LYTNT	1250
2 SKINNER	404SKNR	2300
3 RED FORK	404RDFK	2500

Spacing Orders: 264812

Location Exception Orders: No Exceptions

Increased Density Orders: No Density Orders

Pending CD Numbers: 202100479

Working interest owners' notified: \*\*\*

Special Orders: No Special Orders

Total Depth: 2550

Ground Elevation: 802

Surface Casing: 390

Depth to base of Treatable Water-Bearing FM: 280

Under Federal Jurisdiction: No  
Fresh Water Supply Well Drilled: No  
Surface Water used to Drill: No

Approved Method for disposal of Drilling Fluids:

A. Evaporation/dewater and backfilling of reserve pit.

**PIT 1 INFORMATION**

Type of Pit System: ON SITE

Type of Mud System: AIR

Is depth to top of ground water greater than 10ft below base of pit? Y

Within 1 mile of municipal water well? N

Wellhead Protection Area? N

Pit is located in a Hydrologically Sensitive Area.

Category of Pit: 4

Liner not required for Category: 4

Pit Location is: BED AQUIFER

Pit Location Formation: BARNSDALL

Mud System Change to Water-Based or Oil-Based Mud Requires an Amended Intent (Form 1000).

**NOTES:**

This permit does not address the right of entry or settlement of surface damages. The duration of this permit is 18 MONTHS, except as otherwise provided by Rule 165: 10-3-1. Rule 165: 10-3-4 (c) (7) (e) - The Operator shall give 24 Hours notice by telephone to the appropriate District Office of the Conservation Division as to when Surface Casing will be run.

Category	Description
HYDRAULIC FRACTURING	<p>[3/17/2021 - GC2] - OCC 165:10-3-10 REQUIRES:</p> <p>1) NOTICE SHALL BE GIVEN AT LEAST 5 BUSINESS DAYS PRIOR TO COMMENCEMENT OF HYDRAULIC FRACTURING OPERATIONS ON A HORIZONTAL WELL TO OPERATORS PRODUCING WELLS WITHIN 1 MILE OF THE COMPLETION INTERVAL OF THE SUBJECT WELL. THE NOTICE TO SUCH OPERATORS SHALL CONTAIN THE INFORMATION IN FORM 6000NOO. IF THE HYDRAULIC FRACTURING OPERATIONS SCHEDULE CHANGES AFTER NOTICE HAS BEEN PROVIDED, RESULTING IN A DELAY OF OPERATIONS OF MORE THAN 5 DAYS FROM THE INITIAL NOTICE, NEW NOTICE IS REQUIRED TO BE GIVEN;</p> <p>2) NOTICE WILL BE GIVEN TO THE OCC CENTRAL OFFICE AND LOCAL DISTRICT OFFICES AT LEAST 48 HOURS PRIOR TO COMMENCEMENT OF HYDRAULIC FRACTURING OPERATIONS. FORM 6000NHF SHALL BE USED AND IS FOUND AT THIS LINK: <a href="http://OCCWEB.COM/OG/OGFORMS.HTML">OCCWEB.COM/OG/OGFORMS.HTML</a>; AND,</p> <p>3) THE CHEMICAL DISCLOSURE OF HYDRAULIC FRACTURING INGREDIENTS FOR ALL WELLS IS TO BE REPORTED TO FRACFOCUS WITHIN 60 DAYS AFTER THE CONCLUSION OF HYDRAULIC FRACTURING OPERATIONS, FOUND AT <a href="http://FRACFOCUS.ORG">FRACFOCUS.ORG</a></p>
PENDING CD - 202100479	<p>[4/27/2021 - G56] - SE4 NE4 29-15N-9E  X264812 SKNR  1 WELL  NO OP NAMED  REC 4/19/2021 (DENTON)</p>
SPACING - 264812	<p>[3/17/2021 - G56] - (40) N2 NW4, NE4 29-15N-9E  EST LYTNT, SKNR, RDFK, OTHERS</p>
SURFACE CASING	<p>[3/17/2021 - GC2] - MIN. 390' PER ORDER 82644</p>

This permit does not address the right of entry or settlement of surface damages. The duration of this permit is 18 MONTHS, except as otherwise provided by Rule 165: 10-3-1. Rule 165: 10-3-4 (c) (7) (e) - The Operator shall give 24 Hours notice by telephone to the appropriate District Office of the Conservation Division as to when Surface Casing will be run.

# WELL LOCATION

VANORS DOL #3  
WFD OIL CORPORATION  
SECTION 29, TOWNSHIP 15N, RANGE 9E, I.M.  
CREEK COUNTY, OKLAHOMA

## LEGEND

- SECTION LINE
- QUARTER SECTION LINE
- 16TH LINE

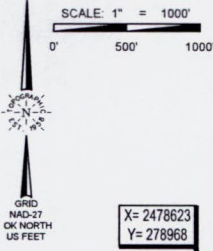

X= 2478623  
Y= 2789668

X= 2481257  
Y= 278993

X= 2483891  
Y= 279016

SURFACE LOCATION  
1658' FNL & 475' FEL  
NAD-27  
X= 2483444  
Y= 277354  
LAT.: 35°45'02.9"N  
LONG.: 96°22'14.6"W  
LAT.: 35.750801° N  
LONG: 96.370731° W  
ELEV.: 871'

SURFACE LOCATION  
1658' FNL & 475' FEL

X= 2478667  
Y= 276312

X= 2483936  
Y= 276369

X= 2483981  
Y= 273722

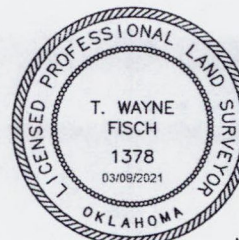

**SURVEYOR'S CERTIFICATE:**  
I, T. WAYNE FISCH, AN OKLAHOMA LICENSED LAND SURVEYOR AND AN AUTHORIZED AGENT OF TOPOGRAPHIC LAND SURVEYORS, DO HEREBY CERTIFY TO THE INFORMATION SHOWN HEREIN.

**TOPOGRAPHIC**  
LOYALTY INNOVATION LEGACY

13800 WIRELESS WAY • OKLAHOMA CITY, OKLAHOMA 73134  
TELEPHONE: (405) 843-4847 OR (800) 654-3219  
CERTIFICATE OF AUTHORIZATION NO. 1292 LS  
WWW.TOPOGRAPHIC.COM

*T. Wayne Fisch*  
T. Wayne Fisch, P.I.S. No. 1378  
Authorized Agent of Topographic Land Surveyors

LEASE NAME & WELL NO. VANORS DOL #3

SECTION 29 TWP 15N RGE 9E MERIDIAN I.M.

COUNTY CREEK STATE OKLAHOMA

DESCRIPTION 1658' FNL & 475' FEL

VANORS DOL #3	REVISION:	
	INT	DATE
DATE: 03/04/2021		
FILE: LO_VANORS DOL_#3		
DRAWN BY: KEU		
SHEET: 1 OF 2		

- NOTES:
1. ORIGINAL DOCUMENT SIZE: 8.5" X 14"
  2. ALL BEARINGS SHOWN HEREON ARE GRID ACCORDING TO THE RESULTS OF STATIC GPS OBSERVATIONS PROCESSED THROUGH OPUS ON THE CONTROL POINT OCCUPIED WHILE MEASURING SAID LINES. OPUS RESULTS ARE CORRELATED TO OKLAHOMA, NORTH ZONE, NAD 27 - HORIZONTAL AND THE NATIONAL GEODETIC VERTICAL DATUM OF 1929.
  3. CERTIFICATION IS MADE ONLY TO THE LOCATION OF THIS EASEMENT LOCATION, IN RELATION TO THE EVIDENCE FOUND DURING A FIELD SURVEY, MADE ON THE GROUND, UNDER MY SUPERVISION, AND USING DOCUMENTATION PROVIDED BY WFD OIL CORPORATION. ONLY UTILITIES/EASEMENTS THAT WERE VISIBLE ON THE DATE OF THIS SURVEY, WITHIN ADJOINING THIS EASEMENT LOCATION, HAVE BEEN LOCATED AS SHOWN HEREON OF WHICH I HAVE KNOWLEDGE. THIS CERTIFICATION IS LIMITED TO THOSE PERSONS OR ENTITIES SHOWN ON THE FACE OF THIS PLAT AND IS NON-TRANSFERABLE, AND MADE FOR THIS TRANSACTION ONLY.
  4. THE INFORMATION SHOWN HEREIN IS FOR CONSTRUCTION PURPOSES ONLY