

Oklahoma Corporation Commission
Oil & Gas Conservation Division
Post Office Box 52000
Oklahoma City, Oklahoma 73152-2000
Rule 165: 10-3-25

Form 1002A

API No.: 35109224940001

Completion Report

Spud Date: May 11, 2021

OTC Prod. Unit No.: 109-227292-0-0000

Drilling Finished Date: May 29, 2021

1st Prod Date: July 03, 2021

Completion Date: June 13, 2021

Drill Type: HORIZONTAL HOLE

Min Gas Allowable: Yes

Well Name: WINTERFELL 1304 09-33 5BH

Purchaser/Measurer: SUPERIOR PIPELINE

Location: OKLAHOMA 9 13N 4W
SW SW SW NE
2448 FNL 2395 FEL of 1/4 SEC
Latitude: 35.6168516 Longitude: -97.6285112
Derrick Elevation: 1150 Ground Elevation: 1132

First Sales Date: 08/02/2021

Operator: REVOLUTION RESOURCES LLC 24162

14301 CALIBER DR STE 110
OKLAHOMA CITY, OK 73134-1016

Completion Type	
X	Single Zone
	Multiple Zone
	Commingled

Location Exception
Order No
There are no Location Exception records to display.

Increased Density
Order No
There are no Increased Density records to display.

Casing and Cement							
Type	Size	Weight	Grade	Feet	PSI	SAX	Top of CMT
CONDUCTOR	20	94	J-55	98			SURFACE
SURFACE	9.625	36	J-55	926		300	SURFACE
PRODUCTION	7	29	P-110	7580		225	3994

Liner								
Type	Size	Weight	Grade	Length	PSI	SAX	Top Depth	Bottom Depth
LINER	4.5	13.5	P-110	8111	0	0	7492	15603

Total Depth: 15641

Packer	
Depth	Brand & Type
There are no Packer records to display.	

Plug	
Depth	Plug Type
There are no Plug records to display.	

Initial Test Data

Test Date	Formation	Oil BBL/Day	Oil-Gravity (API)	Gas MCF/Day	Gas-Oil Ratio Cu FT/BBL	Water BBL/Day	Pumpin or Flowing	Initial Shut-In Pressure	Choke Size	Flow Tubing Pressure
Jul 08, 2021	HUNTON	614	40	850	1385	376	PUMPING			

Completion and Test Data by Producing Formation

Formation Name: HUNTON

Code: 269HNTN

Class: OIL

Spacing Orders

Order No	Unit Size
20212	UNIT

Perforated Intervals

From	To
There are no Perf. Intervals records to display.	

Acid Volumes

231,000 GALLONS ACID, 69,376 BARRELS WATER
--

Fracture Treatments

There are no Fracture Treatments records to display.
--

Formation	Top
OSWEGO	6602
BARTLESVILLE	6993
WOODFORD	6752
HUNTON	6754

Were open hole logs run? No

Date last log run:

Were unusual drilling circumstances encountered? No

Explanation:

Other Remarks

THIS WELL IS AN OPEN HOLE COMPLETION FROM THE BOTTOM OF THE 7" CASING AT 7,580' TO TOTAL DEPTH AT 15,641'. THE 4-1/2" LINER IS NOT CEMENTED.
OCC - FORMERLY PERMITTED AS TYRION 1304 09-21 5BH.

Lateral Holes

Sec: 33 TWP: 14N RGE: 4W County: OKLAHOMA

SW SW NE SE

1561 FSL 1101 FEL of 1/4 SEC

Depth of Deviation: 6356 Radius of Turn: 1285 Direction: 358 Total Length: 9413

Measured Total Depth: 15641 True Vertical Depth: 6740 End Pt. Location From Release, Unit or Property Line: 2550

FOR COMMISSION USE ONLY

1146785

Status: Accepted

API NO. 109-22494
 OTC PROD. UNIT NO. 109-227292-0-0000

(PLEASE TYPE OR USE BLACK INK ONLY)

OKLAHOMA CORPORATION COMMISSION
 Oil & Gas Conservation Division
 Post Office Box 52000
 Oklahoma City, Oklahoma 73152-2000
 Rule 165:10-3-25

Form 1002A
 Rev. 2009

ORIGINAL
 AMENDED (Reason) _____

COMPLETION REPORT

TYPE OF DRILLING OPERATION
 STRAIGHT HOLE DIRECTIONAL HOLE HORIZONTAL HOLE
 SERVICE WELL

SPUD DATE 5/11/2021
 DRLG FINISHED DATE 5/29/2021
 DATE OF WELL COMPLETION 6/13/2021
 1st PROD DATE 7/3/2021

If directional or horizontal, see reverse for bottom hole location.

COUNTY OKLAHOMA SEC 09 TWP 13N RGE 4W
 LEASE NAME WINTERFELL 1304 09-33
 SW 1/4 SW 1/4 SW 1/4 NE 1/4 FSL OF 192' FWL OF 245'
 ELEVATION 1150' Ground 1132' Latitude 35.6168516 Longitude -97.6285112
 OPERATOR NAME REVOLUTION RESOURCES LLC OTC/OCC OPERATOR NO. 24162
 ADDRESS 14301 CALIBER DR SUITE 110
 CITY OKLAHOMA CITY STATE OK ZIP 73134

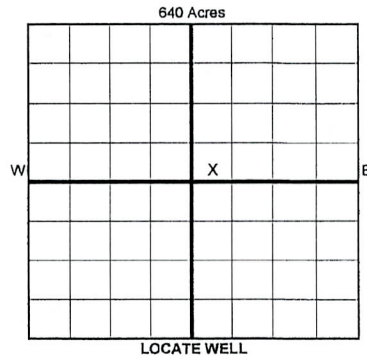

COMPLETION TYPE
 SINGLE ZONE
 MULTIPLE ZONE
 COMMINGLED
 LOCATION EXCEPTION
 ORDER NO.
 INCREASED DENSITY
 ORDER NO.

CASING & CEMENT (Form 1002C must be attached)

TYPE	SIZE	WEIGHT	GRADE	FEET	PSI	SAX	TOP OF CMT	
CONDUCTOR	20	94	J-55	98'			SURF	
SURFACE	9.625	36	J-55	926'		300	SURF	
INTERMEDIATE	7	29	P-110	7580'		225	3994 CALC	
PRODUCTION								
LINER	4.5	13.5	P-110	7492'-15603'	OPEN	HOLE	NA	
							TOTAL DEPTH	15641'

PACKER @ _____ BRAND & TYPE _____ PLUG @ _____ TYPE _____ PLUG @ _____ TYPE _____
 PACKER @ _____ BRAND & TYPE _____ PLUG @ _____ TYPE _____ PLUG @ _____ TYPE _____

COMPLETION & TEST DATA BY PRODUCING FORMATION *369HNTN*

FORMATION	HUNTON				
SPACING & SPACING ORDER NUMBER	20212 (unit)				
CLASS: Oil, Gas, Dry, Inj, Disp, Comm Disp, Svc	OIL				
PERFORATED INTERVALS	OPENHOLE				
	COMPLETION				
ACID/VOLUME	231,000 GAL	ACID			
	69,376 BBL	WATER			
FRACTURE TREATMENT (Fluids/Prop Amounts)					

RECEIVED
 AUG 11 2021

OKLAHOMA CORPORATION
 COMMISSION

Min Gas Allowable (165:10-17-7) OR Oil Allowable (165:10-13-3)
 Gas Purchaser/Measurer Superior Pipeline
 First Sales Date 8/2/2021

INITIAL TEST DATA

INITIAL TEST DATE	7/8/2021			
OIL-BBL/DAY	614			
OIL-GRAVITY (API)	40			
GAS-MCF/DAY	850			
GAS-OIL RATIO CU FT/BBL	1385			
WATER-BBL/DAY	376			
PUMPING OR FLOWING	PUMPING			
INITIAL SHUT-IN PRESSURE				
CHOKE SIZE				
FLOW TUBING PRESSURE				

A record of the formations drilled through, and pertinent remarks are presented on the reverse. I declare that I have knowledge of the contents of this report and am authorized by my organization to make this report, which was prepared by me or under my supervision and direction, with the data and facts stated herein to be true, correct, and complete to the best of my knowledge and belief.

SIGNATURE: *Justin Lundquist* NAME (PRINT OR TYPE) JUSTIN LUNDQUIST DATE 8/6/2021 PHONE NUMBER 405-256-4393
 ADDRESS 14301 Caliber Dr. Suite 110 CITY Oklahoma City STATE OK ZIP 73134 EMAIL ADDRESS JustinL@revolutionresources.com

