

Oklahoma Corporation Commission
 Oil & Gas Conservation Division
 Post Office Box 52000
 Oklahoma City, Oklahoma 73152-2000
 Rule 165: 10-3-25

Form 1002A

API No.: 35029214000001

Completion Report

Spud Date: November 17, 2020

OTC Prod. Unit No.: 029-227146-0-0000

Drilling Finished Date: December 13, 2020

1st Prod Date: March 10, 2021

Completion Date: February 26, 2021

Drill Type: HORIZONTAL HOLE

Well Name: LDC 2-23/26H

Purchaser/Measurer: SOUTHWEST ENERGY LP

Location: COAL 23 2N 9E
 NE SW NE NW
 698 FNL 1684 FWL of 1/4 SEC
 Latitude: 34.63418457 Longitude: -96.33102558
 Derrick Elevation: 796 Ground Elevation: 773

First Sales Date: 03/10/2021

Operator: CANYON CREEK ENERGY ARKOMA LLC 24379

2431 E 61ST ST STE 400
 TULSA, OK 74136-1237

Completion Type	
X	Single Zone
	Multiple Zone
	Commingled

Location Exception	
Order No	
720668	

Increased Density	
Order No	
716045	
716046	

Casing and Cement							
Type	Size	Weight	Grade	Feet	PSI	SAX	Top of CMT
CONDUCTOR	20	94	H-40	40			
SURFACE	9 5/8	36	J-55	500		190	SURFACE
PRODUCTION	5 1/2	20	P-110	13058		1245	1686

Liner								
Type	Size	Weight	Grade	Length	PSI	SAX	Top Depth	Bottom Depth
There are no Liner records to display.								

Total Depth: 13077

Packer	
Depth	Brand & Type
There are no Packer records to display.	

Plug	
Depth	Plug Type
There are no Plug records to display.	

Initial Test Data

Test Date	Formation	Oil BBL/Day	Oil-Gravity (API)	Gas MCF/Day	Gas-Oil Ratio Cu FT/BBL	Water BBL/Day	Pumpin or Flowing	Initial Shut-In Pressure	Choke Size	Flow Tubing Pressure
Mar 11, 2021	WOODFORD	14	45	1326	94714	5441	FLOWING	700	64/64	280

Completion and Test Data by Producing Formation

Formation Name: WOODFORD

Code: 319WDFD

Class: GAS

Spacing Orders

Order No	Unit Size
660619	640
661468	640
720667	MULTIUNIT

Perforated Intervals

From	To
7375	12935

Acid Volumes

NONE

Fracture Treatments

262,822 BARRELS FLUID, 14,306,731 POUNDS PROPPANT

Formation	Top
WOODFORD	6851

Were open hole logs run? No

Date last log run:

Were unusual drilling circumstances encountered? No

Explanation:

Other Remarks

There are no Other Remarks.

Lateral Holes

Sec: 26 TWP: 2N RGE: 9E County: COAL

SE NW NW SE

2229 FSL 2211 FEL of 1/4 SEC

Depth of Deviation: 6199 Radius of Turn: 839 Direction: 178 Total Length: 5560

Measured Total Depth: 13077 True Vertical Depth: 6211 End Pt. Location From Release, Unit or Property Line: 2211

FOR COMMISSION USE ONLY

1146951

Status: Accepted

frac: ✓

GTC

- scan 1002C
surveys

346348407
- 96.3362558

Form 1002A
Rev. 2009

API NO. 029 21400
OTC PROD. UNIT NO. 029-227146

PLEASE TYPE OR USE BLACK INK ONLY
NOTE:

Attach copy of original 1002A
if recompletion or reentry.

OKLAHOMA CORPORATION COMMISSION
Oil & Gas Conservation Division
Post Office Box 52000
Oklahoma City, Oklahoma 73152-2000
Rule 165-10-3-25
COMPLETION REPORT

ORIGINAL
 AMENDED (Reason)

TYPE OF DRILLING OPERATION
 STRAIGHT HOLE DIRECTIONAL HOLE HORIZONTAL HOLE
 SERVICE WELL

SPUD DATE 11/17/2020
DRLG FINISHED DATE 12/13/2020
DATE OF WELL COMPLETION 2/26/2021

COUNTY Coal SEC 23 TWP 2N RGE 9E

WELL NO. 2-23/2020 H
1st PROD DATE 3/10/2021

LEASE NAME LDC
NE 1/4 SW 1/4 NE 1/4 NW 1/4 FNL OF 1/4 SEC 698 FWL OF 1/4 SEC 1684

RECOMP DATE
ELEVATION Derrick FL 796 Ground 773
Latitude (if known) 34.383004N
Longitude (if known) -96.1951692W

OPERATOR NAME Canyon Creek Energy Arkoma, LLC
ADDRESS 615 E. 4th Street

OTC/OCC OPERATOR NO. 24379-0

CITY Tulsa STATE OK ZIP 74120

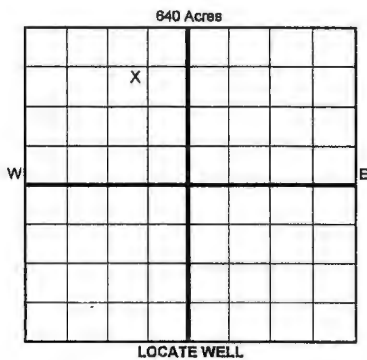

COMPLETION TYPE
 SINGLE ZONE
 MULTIPLE ZONE
Application Date
 COMMINGLED
Application Date
LOCATION EXCEPTION ORDER 720668
INCREASED DENSITY ORDER NO. 716045/716046

CASING & CEMENT (Form 1002C must be attached)

TYPE	SIZE	WEIGHT	GRADE	FEET	PSI	SAX	TOP OF CMT	
CONDUCTOR	20"	94#	H-40	40				
SURFACE	9 5/8"	36#	J55	1000 500		190	Surface	
INTERMEDIATE								
PRODUCTION	5 1/2"	20#	P110	43,060		1245	4,688 1686	
LINER				13058				
							TOTAL DEPTH	13,077

PACKER @ BRAND & TYPE PLUG @ TYPE PLUG @ TYPE
PACKER @ BRAND & TYPE PLUG @ TYPE PLUG @ TYPE

COMPLETION & TEST DATA BY PRODUCING FORMATION

FORMATION	Woodford			
SPACING & SPACING ORDER NUMBER	661468/660619	640/640	720667	MULTIUNIT
CLASS: Oil, Gas, Dry, Inj, Disp, Comm Disp, Svc	Gas			
PERFORATED INTERVALS	7375-12935			
ACID/VOLUME				
FRACTURE TREATMENT (Fluids/Prop Amounts)	262,822 bbls	Fluid		
	14,306,731 #s	lbs Proppant		

Min Gas Allowable (165:10-17-7) Gas Purchaser/Measurer Southwest Energy LP
OR Oil Allowable (165:10-13-3) First Sales Date 3/10/2021

INITIAL TEST DATA			
INITIAL TEST DATE	3/11/2021		
OIL-BBL/DAY	14		
OIL-GRAVITY (API)	45		
GAS-MCF/DAY	1,326		
GAS-OIL RATIO CU FT/BBL	94,714		
WATER-BBL/DAY	5,441		
PUMPING OR FLOWING	Flowing		
INITIAL SHUT-IN PRESSURE	700		
CHOKE SIZE	F0 64/64		
FLOW TUBING PRESSURE	280		

RECEIVED

SEP 30 2021

OKLAHOMA CORPORATION COMMISSION

A record of the formations drilled through, and pertinent remarks are presented on the reverse. I declare that I have knowledge of the contents of this report and am authorized by my organization to make this report, which was prepared by me or under my supervision and direction, with the data and facts stated herein to be true, correct, and complete to the best of my knowledge and belief.
C. Daniel Jacobs
SIGNATURE NAME (PRINT OR TYPE) DATE PHONE NUMBER
615 E. 4th Street Tulsa OK 74120 9/28/2021 (918) 561-6737
ADDRESS CITY STATE ZIP EMAIL ADDRESS djacobs@cceok.com

PLEASE TYPE OR USE BLACK INK ONLY
FORMATION RECORD

Give formation names and tops, if available, or descriptions and thickness of formations drilled through. Show intervals cored or drillstem tested.

NAMES OF FORMATIONS	TOP
Woodford	6,851

LEASE NAME LDC WELL NO. 2-23/26H

FOR COMMISSION USE ONLY	
ITD on file <input checked="" type="checkbox"/> YES <input type="checkbox"/> NO	
APPROVED _____ DISAPPROVED _____	2) Reject Codes

Were open hole logs run? ___ yes no

Date Last log was run _____

Was CO₂ encountered? ___ yes no at what depths? _____

Was H₂S encountered? ___ yes no at what depths? _____

Were unusual drilling circumstances encountered? ___ yes no
If yes, briefly explain below _____

Other remarks: _____

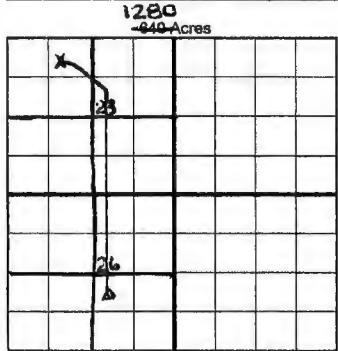

If more than three drainholes are proposed, attach a separate sheet indicating the necessary information.

Direction must be stated in degrees azimuth. Please note, the horizontal drainhole and its end point must be located within the boundaries of the lease or spacing unit.

Directional surveys are required for all drainholes and directional wells.

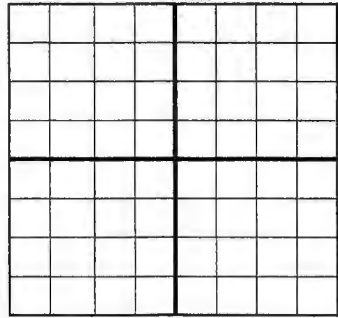

BOTTOM HOLE LOCATION FOR DIRECTIONAL HOLE

SEC	TWP	RGE	COUNTY
Spot Location			
1/4	1/4	1/4	1/4
Measured Total Depth		True Vertical Depth	BHL From Lease, Unit, or Property Line:

BOTTOM HOLE LOCATION FOR HORIZONTAL HOLE: (LATERALS)

LATERAL #1

SEC	TWP	RGE	COUNTY	Coal
26	2N	9E		
Spot Location				FEL
SE 1/4	NW 1/4	NW 1/4	SE 1/4	
Depth of Deviation 6,199		Radius of Turn 839-940	Direction 178-180	FSL 2229 BHL 2211
Measured Total Depth 13,077		True Vertical Depth 6,211	Total Length 5560 - 5,932	
				2229' FSL, 2211' FEL

LATERAL #2

SEC	TWP	RGE	COUNTY
Spot Location			
1/4	1/4	1/4	1/4
Depth of Deviation		Radius of Turn	Direction
Measured Total Depth		True Vertical Depth	BHL From Lease, Unit, or Property Line:

LATERAL #3

SEC	TWP	RGE	COUNTY
Spot Location			
1/4	1/4	1/4	1/4
Depth of Deviation		Radius of Turn	Direction
Measured Total Depth		True Vertical Depth	BHL From Lease, Unit, or Property Line: