

Oklahoma Corporation Commission
 Oil & Gas Conservation Division
 Post Office Box 52000
 Oklahoma City, Oklahoma 73152-2000
 Rule 165: 10-3-25

Form 1002A

API No.: 35029213990001

Completion Report

Spud Date: November 18, 2020

OTC Prod. Unit No.: 029-227148-0-0000

Drilling Finished Date: December 28, 2020

1st Prod Date: March 10, 2021

Completion Date: February 26, 2021

Drill Type: HORIZONTAL HOLE

Well Name: LDC 3-23/26H

Purchaser/Measurer: SOUTHWEST ENERGY LP

Location: COAL 23 2N 9E
 NE SW NE NW
 695 FNL 1669 FWL of 1/4 SEC
 Latitude: 34.63419177 Longitude: -96.33107466
 Derrick Elevation: 795 Ground Elevation: 772

First Sales Date: 03/10/2021

Operator: CANYON CREEK ENERGY ARKOMA LLC 24379

2431 E 61ST ST STE 400
 TULSA, OK 74136-1237

Completion Type	
X	Single Zone
	Multiple Zone
	Commingled

Location Exception	
Order No	
720670	

Increased Density	
Order No	
716045	
716046	

Casing and Cement							
Type	Size	Weight	Grade	Feet	PSI	SAX	Top of CMT
CONDUCTOR	20	94	H-40	40			
SURFACE	9 5/8	36	J-55	499		190	SURFACE
PRODUCTION	5 1/2	20	P-110	14090		1400	4694

Liner								
Type	Size	Weight	Grade	Length	PSI	SAX	Top Depth	Bottom Depth
There are no Liner records to display.								

Total Depth: 14093

Packer	
Depth	Brand & Type
There are no Packer records to display.	

Plug	
Depth	Plug Type
There are no Plug records to display.	

Initial Test Data

Test Date	Formation	Oil BBL/Day	Oil-Gravity (API)	Gas MCF/Day	Gas-Oil Ratio Cu FT/BBL	Water BBL/Day	Pumpin or Flowing	Initial Shut-In Pressure	Choke Size	Flow Tubing Pressure
Mar 11, 2021	WOODFORD	18	45	1328	73777	4837	FLOWING	700	64/64	280

Completion and Test Data by Producing Formation

Formation Name: WOODFORD

Code: 319WDFD

Class: GAS

Spacing Orders

Order No	Unit Size
660619	640
661468	640
720669	MULTIUNIT

Perforated Intervals

From	To
6675	13940

Acid Volumes

NONE

Fracture Treatments

289,418 BARRELS FLUID, 15,606,489 POUNDS PROPPANT

Formation	Top
WOODFORD	6480

Were open hole logs run? No

Date last log run:

Were unusual drilling circumstances encountered? No

Explanation:

Other Remarks

There are no Other Remarks.

Lateral Holes

Sec: 26 TWP: 2N RGE: 9E County: COAL

NE NW SE SW

1191 FSL 1716 FWL of 1/4 SEC

Depth of Deviation: 5731 Radius of Turn: 698 Direction: 180 Total Length: 7265

Measured Total Depth: 14093 True Vertical Depth: 6086 End Pt. Location From Release, Unit or Property Line: 1191

FOR COMMISSION USE ONLY

1146950

Status: Accepted

frac: v

G76

34.63419177
-96.33167466

API NO. 029 21399
OTC PROD. UNIT NO. 026-227148

PLEASE TYPE OR USE BLACK INK ONLY
NOTE:

Attach copy of original 1002A if recompletion or reentry.

OKLAHOMA CORPORATION COMMISSION
Oil & Gas Conservation Division
Post Office Box 52000
Oklahoma City, Oklahoma 73152-2000
Rule 165:10-3-25

ORIGINAL
 AMENDED (Reason)

COMPLETION REPORT

TYPE OF DRILLING OPERATION
 STRAIGHT HOLE DIRECTIONAL HOLE HORIZONTAL HOLE

SPUD DATE 11/18/2020

DRLG FINISHED DATE 12/28/2020

DATE OF WELL COMPLETION 2/26/2021

COUNTY Coal SEC 23 TWP 2N RGE 9E

1st PROD DATE 3/10/2021

LEASE NAME LDC

RECOMP DATE

NE 1/4 SW 1/4 NE 1/4 NW 1/4 FNL OF 1/4 SEC 695 FWL OF 1/4 SEC 1669

Longitude (if known) -96.195187W

ELEVATION Derrick FL 795 Ground 772 Latitude (if known) 34.383086N

OPERATOR NAME Canyon Creek Energy Arkoma- LLC

OTC/OCC OPERATOR NO. 24379-0

ADDRESS 615 E. 4th Street

CITY Tulsa STATE OK ZIP 74120

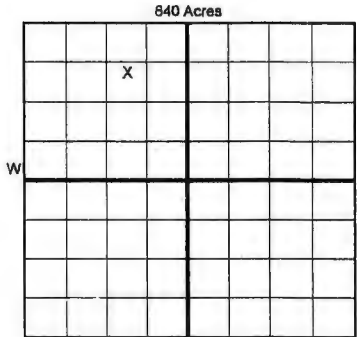

COMPLETION TYPE

SINGLE ZONE
 MULTIPLE ZONE
Application Date
 COMMINGLED
Application Date
LOCATION 720670
EXCEPTION ORDER
INCREASED DENSITY ORDER NO. 716045/716046

CASING & CEMENT (Form 1002C must be attached)

TYPE	SIZE	WEIGHT	GRADE	FEET	PSI	SAX	TOP OF CMT	
CONDUCTOR	20"	94#	H-40	40				
SURFACE	9 5/8"	36#	J55	-1000 499		190	Surface	
INTERMEDIATE								
PRODUCTION	5 1/2"	20#	P110	14090		1400	4674	
LINER								
							TOTAL DEPTH	14,093

PACKER @ BRAND & TYPE PLUG @ TYPE PLUG @ TYPE
PACKER @ BRAND & TYPE PLUG @ TYPE PLUG @ TYPE

COMPLETION & TEST DATA BY PRODUCING FORMATION

FORMATION	Woodford				
SPACING & SPACING ORDER NUMBER	661468/660619	640/640	720669	Multinut	
CLASS: Oil, Gas, Dry, Inj, Disp, Comm Disp, Svc	Gas				
PERFORATED INTERVALS	6675-13940				
ACID/VOLUME					
FRACTURE TREATMENT (Fluids/Prop Amounts)	289,418 bbls Fluid				
	15,606,489 #s lbs Proppant				

Min Gas Allowable (165:10-17) OR Oil Allowable (165:10-13) Gas Purchaser/Measurer Southwest Energy LP First Sales Date 3/10/2021

INITIAL TEST DATA

INITIAL TEST DATE	3/11/2021			
OIL-BBL/DAY	18			
OIL-GRAVITY (API)	45			
GAS-MCF/DAY	1,328			
GAS-OIL RATIO CU FT/BBL	73,777			
WATER-BBL/DAY	4,837			
PUMPING OR FLOWING	Flowing			
INITIAL SHUT-IN PRESSURE	700			
CHOKE SIZE	FO	64/64		
FLOW TUBING PRESSURE	280			

RECEIVED
SEP 30 2021
OKLAHOMA CORPORATION COMMISSION

A record of the formations drilled through, and pertinent remarks are presented on the reverse. I declare that I have knowledge of the contents of this report and am authorized by my organization to make this report, which was prepared by me or under my supervision and direction, with the data and facts stated herein to be true, correct, and complete to the best of my knowledge and belief.

C. Daniel Jacobs
SIGNATURE NAME (PRINT OR TYPE) DATE 9/28/2021 PHONE NUMBER (918) 561-6737
2431 E 61st St #400 ADDRESS CITY Tulsa STATE OK ZIP 74136 EMAIL ADDRESS djacobs@cceok.com

PLEASE TYPE OR USE BLACK INK ONLY
FORMATION RECORD

Give formation names and tops, if available, or descriptions and thickness of formations drilled through. Show intervals cored or drillstem tested.

LEASE NAME LDC WELL NO. 3-23/26H

NAMES OF FORMATIONS	TOP
Woodford	6,480

FOR COMMISSION USE ONLY

ITD on file YES NO

APPROVED _____ DISAPPROVED _____

2) Reject Codes _____

Were open hole logs run? ___ yes no

Date Last log was run _____

Was CO₂ encountered? ___ yes no at what depths? _____

Was H₂S encountered? ___ yes no at what depths? _____

Were unusual drilling circumstances encountered? ___ yes no
If yes, briefly explain below _____

Other remarks: _____

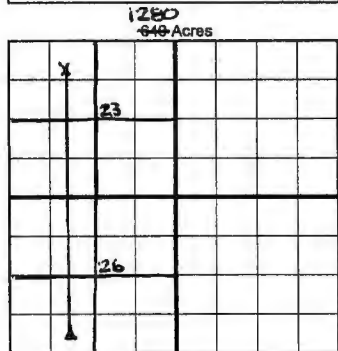

If more than three drainholes are proposed, attach a separate sheet indicating the necessary information.

Direction must be stated in degrees azimuth. Please note, the horizontal drainhole and its end point must be located within the boundaries of the lease or spacing unit.

Directional surveys are required for all drainholes and directional wells.

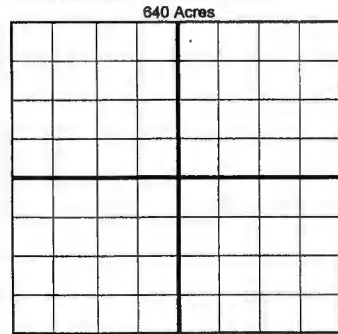

BOTTOM HOLE LOCATION FOR DIRECTIONAL HOLE

SEC	TWP	RGE	COUNTY						
Spot Location				1/4	1/4	1/4	Feet From 1/4 Sec Lines	FSL	FWL
Measured Total Depth				True Vertical Depth		BHL From Lease, Unit, or Property Line:			

BOTTOM HOLE LOCATION FOR HORIZONTAL HOLE: (LATERALS)

LATERAL #1

SEC	TWP	RGE	COUNTY							
26	2N	9E	Coal							
Spot Location				NE 1/4	NW 1/4	SE 1/4	SW 1/4	Feet From 1/4 Sec Lines	FSL 1191	FWL 1716
Depth of Deviation				5,731		Radius of Turn	180	Total Length	7265	7,422
Measured Total Depth				14,093		True Vertical Depth	6,086		1191' FSL, 1716' FWL	

LATERAL #2

SEC	TWP	RGE	COUNTY						
Spot Location				1/4	1/4	1/4	Feet From 1/4 Sec Lines	FSL	FWL
Depth of Deviation				Radius of Turn		Direction		Total Length	
Measured Total Depth				True Vertical Depth		BHL From Lease, Unit, or Property Line:			

LATERAL #3

SEC	TWP	RGE	COUNTY						
Spot Location				1/4	1/4	1/4	Feet From 1/4 Sec Lines	FSL	FWL
Depth of Deviation				Radius of Turn		Direction		Total Length	
Measured Total Depth				True Vertical Depth		BHL From Lease, Unit, or Property Line:			