

Oklahoma Corporation Commission  
 Oil & Gas Conservation Division  
 Post Office Box 52000  
 Oklahoma City, Oklahoma 73152-2000  
 Rule 165: 10-3-25

Form 1002A

API No.: 35109223600002

**Completion Report**

Spud Date: September 15, 2011

OTC Prod. Unit No.: 109-227402-0-0000

Drilling Finished Date: October 03, 2011

**Amended**

1st Prod Date: February 26, 2012

Amend Reason: OCC CORRECTION: PUN

Completion Date: February 24, 2012

Recomplete Date: June 25, 2020

**Drill Type: DIRECTIONAL HOLE**

Min Gas Allowable: Yes

Well Name: ARROWHEAD 20-1

Purchaser/Measurer: SUPERIOR PIPELINE

Location: OKLAHOMA 20 14N 4W  
 SW SW SW NE  
 150 FSL 135 FWL of 1/4 SEC  
 Latitude: 35.6750122 Longitude: -97.6462046  
 Derrick Elevation: 1138 Ground Elevation: 1124

First Sales Date: 06/30/2020

Operator: REVOLUTION RESOURCES LLC 24162

14301 CALIBER DR STE 110  
 OKLAHOMA CITY, OK 73134-1016

Completion Type	
X	Single Zone
	Multiple Zone
	Commingled

Location Exception	
Order No	
There are no Location Exception records to display.	

Increased Density	
Order No	
There are no Increased Density records to display.	

Casing and Cement							
Type	Size	Weight	Grade	Feet	PSI	SAX	Top of CMT
SURFACE	8 5/8	24	J-55	750		400	SURFACE
PRODUCTION	5 1/2	17	L-80	7400		295	4450

Liner								
Type	Size	Weight	Grade	Length	PSI	SAX	Top Depth	Bottom Depth
There are no Liner records to display.								

**Total Depth: 7400**

Packer	
Depth	Brand & Type
There are no Packer records to display.	

Plug	
Depth	Plug Type
6670	CIBP
6747	CIBP
6910	CIBP

Initial Test Data

Test Date	Formation	Oil BBL/Day	Oil-Gravity (API)	Gas MCF/Day	Gas-Oil Ratio Cu FT/BBL	Water BBL/Day	Pumpin or Flowing	Initial Shut-In Pressure	Choke Size	Flow Tubing Pressure
Jul 14, 2020	BARTLESVILLE	1	40	20	20000	20	PUMPING			
Jul 26, 2020	PRUE-OSWEGO	1	40	25	25000	20	PUMPING			
Sep 11, 2020	OSWEGO	0.5	40	10	20000	10	PUMPING			

**Completion and Test Data by Producing Formation**

Formation Name: BARTLESVILLE

Code: 404BRVL

Class: DRY

**Spacing Orders**

Order No	Unit Size
NONE	

**Perforated Intervals**

From	To
6824	6842

**Acid Volumes**

7,182 GALLONS ACID, 167 BARRELS WATER
---------------------------------------

**Fracture Treatments**

NONE
------

Formation Name: PRUE

Code: 404PRUE

Class: DRY

**Spacing Orders**

Order No	Unit Size
NONE	

**Perforated Intervals**

From	To
6690	6692

**Acid Volumes**

7,182 GALLONS ACID, 167 BARRELS WATER STIMULATION ON BOTH PRUE AND OSWEGO PERFORATIONS
--

**Fracture Treatments**

NONE
------

Formation Name: OSWEGO

Code: 404OSWG

Class: GAS

**Spacing Orders**

Order No	Unit Size
NONE	

**Perforated Intervals**

From	To
6610	6630

**Acid Volumes**

2000 GALS ACID AND 118 BBLs WATER RESTIMULATE OSWEGO AFTER PRUE PLUGGED OFF.
--

**Fracture Treatments**

NONE
------

Formation Name: PRUE - OSWEGO

Code:

Class: GAS

Formation	Top
OSWEGO	6600
PRUE	6686
BARTLESVILLE	6822
WOODFORD	6924
HUNTON	6958

Were open hole logs run? Yes

Date last log run: October 01, 2011

Were unusual drilling circumstances encountered? No

Explanation:

**Other Remarks**

SET CIBP AT 6,910' AND PLUG BACK HUNTON. PERFORATE / STIMULATE BARTLESVILLE AND TEST. SET CIBP AT 6,750' AND PLUG BACK BARTLESVILLE. PERFORATE / STIMULATE / PRODUCE PRUE AND OSWEGO. SET CIBP AT 6,670' AND PLUG BACK PRUE. ACIDIZE OSWEGO. PUT ON PRODUCTION.

**Bottom Holes**

Sec: 20 TWP: 14N RGE: 4W County: OKLAHOMA

SE SW NW SE

1324 FSL 367 FWL of 1/4 SEC

Depth of Deviation: 0 Radius of Turn: 0 Direction: 0 Total Length: 0

Measured Total Depth: 7400 True Vertical Depth: 7200 End Pt. Location From Release, Unit or Property Line: 1324

**FOR COMMISSION USE ONLY**

1147024

Status: Accepted

API NO. 109-22360X  
OTC PROD. UNIT NO. 24162

(PLEASE TYPE OR USE BLACK INK ONLY)

OKLAHOMA CORPORATION COMMISSION  
Oil & Gas Conservation Division  
Post Office Box 52000  
Oklahoma City, Oklahoma 73152-2000  
Rule 165:10-3-25

A: 227402

I

ORIGINAL  
 AMENDED (Reason) Recomplete

COMPLETION REPORT

TYPE OF DRILLING OPERATION  
 STRAIGHT HOLE  DIRECTIONAL HOLE  HORIZONTAL HOLE  
 SERVICE WELL

SPUD DATE 9/15/2011  
DRLG FINISHED DATE 10/3/2011  
DATE OF WELL COMPLETION 2/24/2012  
1st PROD DATE 2/26/2012

Per original 1002A

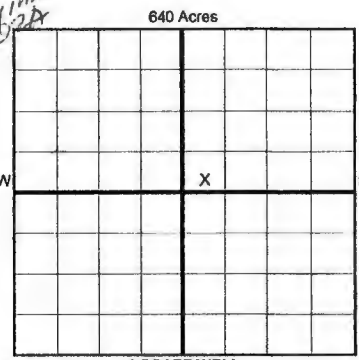

County OKLAHOMA SEC 20 TWP 14N RGE 4W  
LEASE NAME ARROWHEAD  
WELL NO. 20-1  
SW 1/4 SW 1/4 SW 1/4 NE 1/4 FSL OF 1/4 SEC 150' FWL OF 1/4 SEC 135'  
ELEVATION Ground 1124' Latitude (if known) 35.6750122 Longitude (if known) -97.6462046  
OPERATOR NAME REVOLUTION RESOURCES LLC OTC/OCC OPERATOR NO. 24162  
ADDRESS 14301 CALIBER DR SUITE 110  
CITY OKLAHOMA CITY STATE OK ZIP 73134

COMPLETION TYPE  
 SINGLE ZONE 6/17/2020  
 MULTIPLE ZONE  
Application Date  
COMINGLED  
Application Date  
LOCATION EXCEPTION  
ORDER NO.  
INCREASED DENSITY  
ORDER NO.

TYPE	SIZE	WEIGHT	GRADE	FEET	PSI	SAX	TOP OF CMT
CONDUCTOR							
SURFACE	8 5/8	24	J-55	750'		400	SURF
INTERMEDIATE	5 1/2	17	L-80	7400'		295	4450'
PRODUCTION							
LINER							
							7400'

PACKER @ \_\_\_\_\_ BRAND & TYPE \_\_\_\_\_ PLUG @ 6910' TYPE CIBP PLUG @ 6670' TYPE CIBP TOTAL DEPTH 7400'  
PACKER @ \_\_\_\_\_ BRAND & TYPE \_\_\_\_\_ PLUG @ 6747' TYPE CIBP PLUG @ \_\_\_\_\_ TYPE \_\_\_\_\_

FORMATION	BARTLESVILLE	PRUE	OSWEGO	
SPACING & SPACING ORDER NUMBER	PLUGGED BACK	PLUGGED BACK	PRODUCING	none
CLASS: Oil, Gas, Dry, Inj. Disp, Comm Disp, Svc	Dry below plug	Dry below plug	Gas	per 60R
PERFORATED INTERVALS	6824'-6842'	6690'-6692'	6610'-6630'	
ACID/VOLUME				
FRACTURE TREATMENT (Fluids/Prop Amounts)	7182 GAL ACID 167 BBLs WTR	7182 GAL ACID 167 BBLs WTR	2000 GAL ACID 118 BBLs WTR	

RECEIVED  
SEP 18 2020  
Oklahoma Corporation  
Commission

Min Gas Allowable OR  Oil Allowable (165:10-17-7)  
Gas Purchaser/Measurer Superior Pipeline  
First Sale Date 6/30/2020

INITIAL TEST DATA	7/14/2020	7/26/2020	9/11/2020
INITIAL TEST DATE	7/14/2020	7/26/2020	9/11/2020
OIL-BBL/DAY	1	1	.5
OIL-GRAVITY ( API)	40	40	40
GAS-MCF/DAY	20	25	10
GAS-OIL RATIO CU FT/BBL	20000	25000	10000 20000
WATER-BBL/DAY	20	20	10
PUMPING OR FLOWING	PUMPING	PUMPING	PUMPING
INITIAL SHUT-IN PRESSURE			
CHOKE SIZE			
FLOW TUBING PRESSURE			

A record of the formations drilled through, and pertinent remarks are presented on the reverse. I declare that I have knowledge of the contents of this report and am authorized by my organization to make this report, which was prepared by me or under my supervision and direction, with the data and facts stated herein to be true, correct, and complete to the best of my knowledge and belief.

SIGNATURE: Justin Lundquist NAME (PRINT OR TYPE) JUSTIN LUNDQUIST  
ADDRESS: 14301 Caliber Dr. Suite 110 CITY: Oklahoma City STATE: OK ZIP: 73134  
DATE: 9/15/2020 PHONE NUMBER: 405-256-4393  
EMAIL ADDRESS: JustinL@revolutionresources.com