

Oklahoma Corporation Commission  
Oil & Gas Conservation Division  
Post Office Box 52000  
Oklahoma City, Oklahoma 73152-2000  
Rule 165: 10-3-25

Form 1002A

API No.: 35073268070000

**Completion Report**

Spud Date: January 17, 2022

OTC Prod. Unit No.: 073-227697-0-1692

Drilling Finished Date: January 29, 2022

1st Prod Date: February 11, 2022

Completion Date: February 07, 2022

**Drill Type: HORIZONTAL HOLE**

Well Name: LINCOLN NORTH UNIT 44-5HO

Purchaser/Measurer:

Location: KINGFISHER 28 18N 5W  
SE SE SE SW  
187 FSL 2431 FWL of 1/4 SEC  
Latitude: 36.00066 Longitude: -97.738488  
Derrick Elevation: 0 Ground Elevation: 1128

First Sales Date:

Operator: HINKLE OIL & GAS INC 21639

5600 N MAY AVE STE 295  
OKLAHOMA CITY, OK 73112-4275

Completion Type	
X	Single Zone
	Multiple Zone
	Commingled

Location Exception	
Order No	
There are no Location Exception records to display.	

Increased Density	
Order No	
There are no Increased Density records to display.	

Casing and Cement							
Type	Size	Weight	Grade	Feet	PSI	SAX	Top of CMT
CONDUCTOR	20			90			SURFACE
SURFACE	9 5/8	36	LTC	340		125	SURFACE
PRODUCTION	7	26	P-110	6541		225	2483

Liner								
Type	Size	Weight	Grade	Length	PSI	SAX	Top Depth	Bottom Depth
LINER	4 1/2	13.5	P-110	5288	0	460	6383	11671

**Total Depth: 11717**

Packer	
Depth	Brand & Type
There are no Packer records to display.	

Plug	
Depth	Plug Type
There are no Plug records to display.	

Initial Test Data

Test Date	Formation	Oil BBL/Day	Oil-Gravity (API)	Gas MCF/Day	Gas-Oil Ratio Cu FT/BBL	Water BBL/Day	Pumpin or Flowing	Initial Shut-In Pressure	Choke Size	Flow Tubing Pressure
Feb 14, 2022	OSWEGO	106	43.9	165	1557	2227	PUMPING		OPEN	

**Completion and Test Data by Producing Formation**

Formation Name: OSWEGO

Code: 404OSWG

Class: OIL

**Spacing Orders**

Order No	Unit Size
119269	UNIT

**Perforated Intervals**

From	To
6560	11520

**Acid Volumes**

282,072 GALLONS 15% HCL, 58,013 BARRELS SLICK WATER

**Fracture Treatments**

There are no Fracture Treatments records to display.

Formation	Top
OSWEGO	6069

Were open hole logs run? No

Date last log run:

Were unusual drilling circumstances encountered? No

Explanation:

**Other Remarks**

There are no Other Remarks.

**Lateral Holes**

Sec: 33 TWP: 18N RGE: 5W County: KINGFISHER

SE SE SE SW

1 FSL 2590 FWL of 1/4 SEC

Depth of Deviation: 5464 Radius of Turn: 1208 Direction: 181 Total Length: 5045

Measured Total Depth: 11717 True Vertical Depth: 6268 End Pt. Location From Release, Unit or Property Line: 1

**FOR COMMISSION USE ONLY**

1147619

Status: Accepted

API NO. 35-073-26807  
 OTC PROD. UNIT NO. 073-227697  
 -0-1692

Oil and Gas Conservation Division  
 P.O. Box 52000  
 Oklahoma City, OK 73152-2000  
 405-521-2331  
 OCCCentralProcessing@OCC.OK.GOV



**OKLAHOMA**  
 Corporation  
 Commission

Form 1002A  
 Rev. 2021

ORIGINAL  
 AMENDED (Reason) \_\_\_\_\_

Rule 165:10-3-25

COMPLETION REPORT

TYPE OF DRILLING OPERATION  
 STRAIGHT HOLE  DIRECTIONAL HOLE  HORIZONTAL HOLE  
 SERVICE WELL

SPUD DATE 1/17/2022  
 DRLG FINISHED DATE 1/29/2022  
 DATE OF WELL COMPLETION 2/7/2022  
 1st PROD DATE 2/11/2022  
 RECOMP DATE \_\_\_\_\_  
 ELEVATION Derrick FL Ground 1128' Latitude 36.00066 Longitude -97.738488  
 OPERATOR NAME Hinkle Oil & Gas, Inc. OTC / OCC OPERATOR NO. 21639  
 ADDRESS 5600 N. May Avenue, Suite 29  
 CITY Oklahoma City STATE OK ZIP 73112

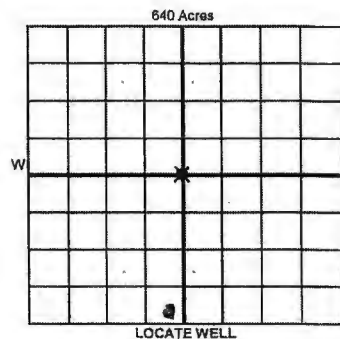

If directional or horizontal, see reverse for bottom hole location.

COUNTY Kingfisher SEC 28 TWP 18N RGE 05W  
 LEASE NAME Lincoln North Unit WELL NO. 44-5HO  
 SE 1/4 SE 1/4 SE 1/4 SW 1/4 FSL 187' FWL 2431'  
 OPERATOR NAME Hinkle Oil & Gas, Inc.  
 ADDRESS 5600 N. May Avenue, Suite 29  
 CITY Oklahoma City STATE OK ZIP 73112

COMPLETION TYPE  
 SINGLE ZONE  
 MULTIPLE ZONE  
 COMMINGLED  
 LOCATION EXCEPTION ORDER NO.  
 MULTIUNIT ORDER NO.  
 INCREASED DENSITY ORDER NO.

CASING & CEMENT (Attach Form 1002C)

TYPE	SIZE	WEIGHT	GRADE	FEET	PSI	SAX	TOP OF CMT
CONDUCTOR	20"			90'			Surface
SURFACE	9 5/8"	36#	LTC	340'		125	Surface
INTERMEDIATE	7"	26#	P110	6541'		225	4050' - 2483'
PRODUCTION							
LINER	4 1/2"	13.5#	P110	6383'-11,671'		460	6383'

PACKER @ \_\_\_\_\_ BRAND & TYPE \_\_\_\_\_ PLUG @ \_\_\_\_\_ TYPE \_\_\_\_\_ PLUG @ \_\_\_\_\_ TYPE \_\_\_\_\_ TOTAL DEPTH 11,717'

COMPLETION & TEST DATA BY PRODUCING FORMATION

FORMATION	Oswego				No Frac
SPACING & SPACING ORDER NUMBER	119269 (unit)				
CLASS: Oil, Gas, Dry, Inj, Disp, Comm Disp, Svc	Oil				
PERFORATED INTERVALS	6560'-11,520'				
ACID/VOLUME					
FRACTURE TREATMENT (Fluids/Prop Amounts)	282072 Gal. 15% HCL 58013 Bbl. Slick Wtr				

RECEIVED  
 FEB 18 2022

OKLAHOMA CORPORATION  
 COMMISSION

Min Gas Allowable (165:10-17-7)  
 OR  
 Oil Allowable (165:10-13-3)

Purchaser/Measurer \_\_\_\_\_  
 First Sales Data \_\_\_\_\_

INITIAL TEST DATA

INITIAL TEST DATE	2/14/2022			
OIL-BBL/DAY	106			
OIL-GRAVITY (API)	43.9			
GAS-MCF/DAY	165			
GAS-OIL RATIO CU FT/BBL	1557			
WATER-BBL/DAY	2227			
PUMPING OR FLOWING	Pumping			
INITIAL SHUT-IN PRESSURE	N/A			
CHOKE SIZE	Open			
FLOW TUBING PRESSURE	N/A			

A record of the formations drilled through, and pertinent remarks are presented on the reverse. I declare that I have knowledge of the contents of this report and am authorized by my organization to make this report, which was prepared by me or under my supervision and direction, with the data and facts stated herein to be true, correct, and complete to the best of my knowledge and belief.

*B. Hinkle*  
 SIGNATURE Bruce A. Hinkle NAME (PRINT OR TYPE) 2/17/2022 405-848-0924 DATE PHONE NUMBER  
 5600 N. May Avenue, Suite 295 Oklahoma City OK 73112 ADDRESS CITY STATE ZIP  
 Laurahinkle@hoagi.com EMAIL ADDRESS

PLEASE TYPE OR USE BLACK INK ONLY  
FORMATION RECORD

Give formation names and tops, if available, or descriptions and thickness of formations drilled through. Show intervals cored or drillstem tested.

LEASE NAME Lincoln North Unit WELL NO. 44-5HO

NAMES OF FORMATIONS	TVD	TOP
Oswego		6069'

FOR COMMISSION USE ONLY

ITD on file  YES  NO

APPROVED \_\_\_\_\_ DISAPPROVED \_\_\_\_\_ 2) Reject Codes \_\_\_\_\_

\_\_\_\_\_

\_\_\_\_\_

\_\_\_\_\_

Were open hole logs run?  yes  no

Date Last log was run \_\_\_\_\_

Was CO<sub>2</sub> encountered?  yes  no at what depths? \_\_\_\_\_

Was H<sub>2</sub>S encountered?  yes  no at what depths? \_\_\_\_\_

Were unusual drilling circumstances encountered?  yes  no  
If yes, briefly explain below \_\_\_\_\_

Other remarks: \_\_\_\_\_

\_\_\_\_\_

\_\_\_\_\_

\_\_\_\_\_

\_\_\_\_\_

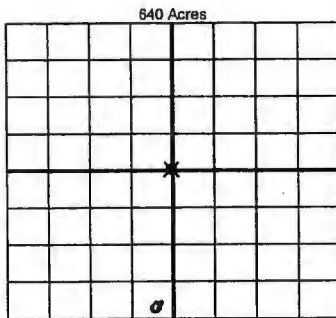

If more than three drainholes are proposed, attach a separate sheet indicating the necessary information.

Direction must be stated in degrees azimuth. Please note, the horizontal drainhole and its end point must be located within the boundaries of the lease or spacing unit.

Directional surveys are required for all drainholes and directional wells

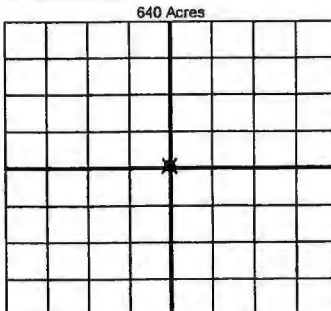

BOTTOM HOLE LOCATION FOR DIRECTIONAL HOLE

SEC	TWP	RGE	COUNTY	Feet From 1/4 Sec Lines		
				1/4	1/4	1/4
Measured Total Depth		True Vertical Depth		BHL From Lease, Unit, or Property Line:		

BOTTOM HOLE LOCATION FOR HORIZONTAL HOLE: (LATERALS)

LATERAL #1

SEC	TWP	RGE	COUNTY	Feet From 1/4 Sec Lines			FSL	FWL
33	18N	05W	Kingfisher	1/4	1/4	1/4	1'	2590'
Depth of Deviation		Radius of Turn		Direction		Total Length		
5464'		1208'		121 South		5045'		
Measured Total Depth		True Vertical Depth		BHL From Lease, Unit, or Property Line:			1'	
11,717'		6268'						

LATERAL #2

SEC	TWP	RGE	COUNTY	Feet From 1/4 Sec Lines			Total Length
				1/4	1/4	1/4	
Depth of Deviation		Radius of Turn		Direction		Total Length	
Measured Total Depth		True Vertical Depth		BHL From Lease, Unit, or Property Line:			

LATERAL #3

SEC	TWP	RGE	COUNTY	Feet From 1/4 Sec Lines			Total Length
				1/4	1/4	1/4	
Depth of Deviation		Radius of Turn		Direction		Total Length	
Measured Total Depth		True Vertical Depth		BHL From Lease, Unit, or Property Line:			