

Oklahoma Corporation Commission  
Oil & Gas Conservation Division  
Post Office Box 52000  
Oklahoma City, Oklahoma 73152-2000  
Rule 165: 10-3-25

Form 1002A

API No.: 35073267990000

**Completion Report**

Spud Date: December 31, 2021

OTC Prod. Unit No.: 073-227650-0-1692

Drilling Finished Date: January 15, 2022

1st Prod Date: January 30, 2022

Completion Date: January 24, 2022

**Drill Type: HORIZONTAL HOLE**

Well Name: LINCOLN NORTH UNIT 42-4HO

Purchaser/Measurer:

Location: KINGFISHER 29 18N 5W  
SE SW SE SE  
234 FSL 890 FEL of 1/4 SEC  
Latitude: 36.000699 Longitude: -97.749716  
Derrick Elevation: 0 Ground Elevation: 1152

First Sales Date:

Operator: HINKLE OIL & GAS INC 21639

5600 N MAY AVE STE 295  
OKLAHOMA CITY, OK 73112-4275

Completion Type	
X	Single Zone
	Multiple Zone
	Commingled

Location Exception	
Order No	
There are no Location Exception records to display.	

Increased Density	
Order No	
There are no Increased Density records to display.	

Casing and Cement							
Type	Size	Weight	Grade	Feet	PSI	SAX	Top of CMT
CONDUCTOR	20			90			SURFACE
SURFACE	9 5/8	36	LTC	320		125	SURFACE
PRODUCTION	7	26	P-110	6655		225	2540

Liner								
Type	Size	Weight	Grade	Length	PSI	SAX	Top Depth	Bottom Depth
LINER	4 1/2	13.5	P-110	5207	0	560	6486	11693

**Total Depth: 11710**

Packer	
Depth	Brand & Type
There are no Packer records to display.	

Plug	
Depth	Plug Type
There are no Plug records to display.	

Initial Test Data

Test Date	Formation	Oil BBL/Day	Oil-Gravity (API)	Gas MCF/Day	Gas-Oil Ratio Cu FT/BBL	Water BBL/Day	Pumpin or Flowing	Initial Shut-In Pressure	Choke Size	Flow Tubing Pressure
Feb 09, 2022	OSWEGO	241	43.8	94	390	1254	PUMPING		OPEN	

**Completion and Test Data by Producing Formation**

Formation Name: OSWEGO

Code: 404OSWG

Class: OIL

**Spacing Orders**

Order No	Unit Size
119269	UNIT

**Perforated Intervals**

From	To
6650	11549

**Acid Volumes**

204,372 GALLONS 15% HCL, 57,766 BARRELS SLICK WATER

**Fracture Treatments**

There are no Fracture Treatments records to display.

Formation	Top
OSWEGO	6135

Were open hole logs run? No

Date last log run:

Were unusual drilling circumstances encountered? No

Explanation:

**Other Remarks**

There are no Other Remarks.

**Lateral Holes**

Sec: 32 TWP: 18N RGE: 5W County: KINGFISHER

SE SE SW SE

1 FSL 1420 FEL of 1/4 SEC

Depth of Deviation: 5584 Radius of Turn: 1214 Direction: 180 Total Length: 4912

Measured Total Depth: 11710 True Vertical Depth: 6348 End Pt. Location From Release, Unit or Property Line: 1

**FOR COMMISSION USE ONLY**

1147620

Status: Accepted



PLEASE TYPE OR USE BLACK INK ONLY  
FORMATION RECORD

Give formation names and tops, if available, or descriptions and thickness of formations drilled through. Show intervals cored or drillstem tested.

LEASE NAME Lincoln North Unit WELL NO. 42-4HO

NAMES OF FORMATIONS	TOP
Oswego	TVD 6135'

FOR COMMISSION USE ONLY

ITD on file  YES  NO

APPROVED \_\_\_\_\_ DISAPPROVED \_\_\_\_\_ 2) Reject Codes \_\_\_\_\_

\_\_\_\_\_

\_\_\_\_\_

\_\_\_\_\_

Were open hole logs run?  yes  no

Date Last log was run \_\_\_\_\_

Was CO<sub>2</sub> encountered?  yes  no at what depths? \_\_\_\_\_

Was H<sub>2</sub>S encountered?  yes  no at what depths? \_\_\_\_\_

Were unusual drilling circumstances encountered?  yes  no  
If yes, briefly explain below.

Other remarks:

\_\_\_\_\_

\_\_\_\_\_

\_\_\_\_\_

\_\_\_\_\_

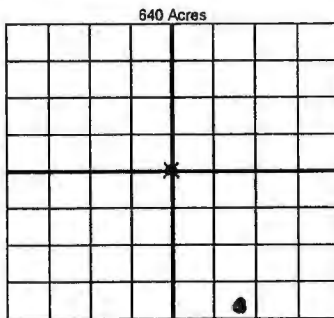

If more than three drainholes are proposed, attach a separate sheet indicating the necessary information.

Direction must be stated in degrees azimuth. Please note, the horizontal drainhole and its end point must be located within the boundaries of the lease or spacing unit.

Directional surveys are required for all drainholes and directional wells

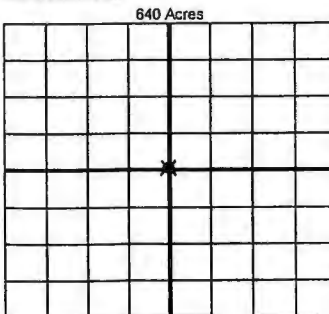

BOTTOM HOLE LOCATION FOR DIRECTIONAL HOLE

SEC	TWP	RGE	COUNTY
1/4	1/4	1/4	1/4
Measured Total Depth	True Vertical Depth	Feet From 1/4 Sec Lines	
		BHL From Lease, Unit, or Property Line:	

BOTTOM HOLE LOCATION FOR HORIZONTAL HOLE: (LATERALS)

LATERAL #1

SEC	TWP	RGE	COUNTY
32	18N	05W	Kingfisher
SE 1/4	SE 1/4	SW 1/4	SE 1/4
Depth of Deviation	5584'	Radius of Turn	1214'
Measured Total Depth	11,710'	True Vertical Depth	6348'
		Direction	180 South
		Feet From 1/4 Sec Lines	FSL 1'
		Total Length	4912'
		BHL From Lease, Unit, or Property Line: 1'	

LATERAL #2

SEC	TWP	RGE	COUNTY
1/4	1/4	1/4	1/4
Depth of Deviation	Radius of Turn	Direction	Total Length
Measured Total Depth	True Vertical Depth	BHL From Lease, Unit, or Property Line:	

LATERAL #3

SEC	TWP	RGE	COUNTY
1/4	1/4	1/4	1/4
Depth of Deviation	Radius of Turn	Direction	Total Length
Measured Total Depth	True Vertical Depth	BHL From Lease, Unit, or Property Line:	