

Oklahoma Corporation Commission
Oil & Gas Conservation Division
Post Office Box 52000
Oklahoma City, Oklahoma 73152-2000
Rule 165: 10-3-25

Form 1002A

API No.: 35073267980000

Completion Report

Spud Date: January 04, 2022

OTC Prod. Unit No.: 073-227645-0-1692

Drilling Finished Date: January 13, 2022

1st Prod Date: February 07, 2022

Completion Date: January 25, 2022

Drill Type: HORIZONTAL HOLE

Well Name: LINCOLN NORTH UNIT 128-2HO

Purchaser/Measurer:

Location: KINGFISHER 12 17N 6W
SE SW SE SW
200 FSL 1752 FWL of 1/4 SEC
Latitude: 35.95666 Longitude: -97.794093
Derrick Elevation: 0 Ground Elevation: 1075

First Sales Date:

Operator: HINKLE OIL & GAS INC 21639

5600 N MAY AVE STE 295
OKLAHOMA CITY, OK 73112-4275

Completion Type	
X	Single Zone
	Multiple Zone
	Commingled

Location Exception	
Order No	
There are no Location Exception records to display.	

Increased Density	
Order No	
There are no Increased Density records to display.	

Casing and Cement							
Type	Size	Weight	Grade	Feet	PSI	SAX	Top of CMT
CONDUCTOR	20			90			SURFACE
SURFACE	9 5/8	36	LTC	291		120	SURFACE
PRODUCTION	7	26	P-110	6749		225	2637

Liner								
Type	Size	Weight	Grade	Length	PSI	SAX	Top Depth	Bottom Depth
LINER	4 1/2	11.6	P-110	5124	0	450	6511	11635

Total Depth: 11650

Packer	
Depth	Brand & Type
There are no Packer records to display.	

Plug	
Depth	Plug Type
There are no Plug records to display.	

Initial Test Data

Test Date	Formation	Oil BBL/Day	Oil-Gravity (API)	Gas MCF/Day	Gas-Oil Ratio Cu FT/BBL	Water BBL/Day	Pumpin or Flowing	Initial Shut-In Pressure	Choke Size	Flow Tubing Pressure
Feb 10, 2022	OSWEGO	481	44.4	417	867	2130	PUMPING		OPEN	

Completion and Test Data by Producing Formation

Formation Name: OSWEGO

Code: 404OSWG

Class: OIL

Spacing Orders

Order No	Unit Size
119269	UNIT

Perforated Intervals

From	To
6780	11463

Acid Volumes

200,256 GALLONS 15% HCL, 57,927 BARRELS SLICK WATER

Fracture Treatments

There are no Fracture Treatments records to display.

Formation	Top
OSWEGO	6260

Were open hole logs run? No

Date last log run:

Were unusual drilling circumstances encountered? No

Explanation:

Other Remarks

There are no Other Remarks.

Lateral Holes

Sec: 13 TWP: 17N RGE: 6W County: KINGFISHER

SW SW SE SW

180 FSL 1480 FWL of 1/4 SEC

Depth of Deviation: 5596 Radius of Turn: 1287 Direction: 181 Total Length: 4767

Measured Total Depth: 11650 True Vertical Depth: 6436 End Pt. Location From Release, Unit or Property Line: 180

FOR COMMISSION USE ONLY

Status: Accepted

1147621

API NO. 35-073-26798
 OTC PROD. UNIT NO. **073-227645**
 -0-1692

Oil and Gas Conservation Division
 P.O. Box 52000
 Oklahoma City, OK 73152-2000
 405-521-2331
 DCCCcentralProcessing@OCC.OK.GOV



OKLAHOMA
 Corporation
 Commission

Form 1002A
 Rev. 2021

ORIGINAL
 AMENDED (Reason) _____

Rule 165:10-3-25

COMPLETION REPORT

TYPE OF DRILLING OPERATION
 STRAIGHT HOLE DIRECTIONAL HOLE HORIZONTAL HOLE
 SERVICE WELL
 If directional or horizontal, see reverse for bottom hole location.

SPUD DATE 1/04/2022
 DRLG FINISHED DATE 1/13/2022

COUNTY Kingfisher SEC 12 TWP 17N RGE 06W
 LEASE NAME Lincoln North Unit WELL NO. 128-2HO 1st PROD DATE 2/7/2022
 SE 1/4 SW 1/4 SE 1/4 SW 1/4 **200** FWL **2396** RECOMP DATE
 ELEVATION Ground 1075' **1752** Latitude 35.95666 Longitude -97.794093
 OPERATOR NAME Hinkle Oil & Gas, Inc. OTC / OCC OPERATOR NO. 21639
 ADDRESS 5600 N. May Avenue, Suite 295
 CITY Oklahoma City STATE OK ZIP 73112

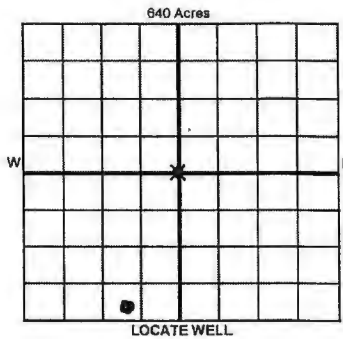

Per Laura Hinkle

COMPLETION TYPE

<input checked="" type="radio"/> SINGLE ZONE
<input type="radio"/> MULTIPLE ZONE
Application Date
<input type="radio"/> COMMINGLED
Application Date
LOCATION EXCEPTION ORDER NO.
MULTIUNIT ORDER NO.
INCREASED DENSITY ORDER NO.

CASING & CEMENT (Attach Form 1002C)

TYPE	SIZE	WEIGHT	GRADE	FEET	PSI	SAX	TOP OF CMT
CONDUCTOR	20"			90'			Surface
SURFACE	9 5/8"	36#	LTC	291'		130 125	Surface
INTERMEDIATE	7"	26#	P110	6749'		225	4096 2637
PRODUCTION							
LINER	4 1/2"	11.6#	P110	6511'-11,635'		450	6511'

PACKER @ _____ BRAND & TYPE _____ PLUG @ _____ TYPE _____ PLUG @ _____ TYPE _____ TOTAL DEPTH 11,650'

COMPLETION & TEST DATA BY PRODUCING FORMATION **4040 SWG**

FORMATION	Oswego				No Frac
SPACING & SPACING ORDER NUMBER	119269 (unit)				
CLASS: Oil, Gas, Dry, Inf, Disp, Comm Disp, Svc	Oil				
PERFORATED INTERVALS	6780'-11,463'				RECEIVED FEB 18 2022
ACID/VOLUME					OKLAHOMA CORPORATION COMMISSION
FRACTURE TREATMENT (Fluids/Prop Amounts)	200256 Gal. 15% HCL 57927 Bbl. Slick Wtr.				

Min Gas Allowable (165:10-17-7) OR Oil Allowable (165:10-13-3) Purchaser/Measurer _____ First Sales Date _____

INITIAL TEST DATA

INITIAL TEST DATE	2/10/2022				
OIL-BBL/DAY	481				
OIL-GRAVITY (API)	44.4				
GAS-MCF/DAY	417				
GAS-OIL RATIO CU FT/BBL	867				
WATER-BBL/DAY	2130				
PUMPING OR FLOWING	Pumping				
INITIAL SHUT-IN PRESSURE	N/A				
CHOKE SIZE	Open				
FLOW TUBING PRESSURE	N/A				

A record of the formations drilled through, and pertinent remarks are presented on the reverse. I declare that I have knowledge of the contents of this report and am authorized by my organization to make this report, which was prepared by me or under my supervision and direction, with the data and facts stated herein to be true, correct, and complete to the best of my knowledge and belief.

B. Hinkle SIGNATURE Bruce A. Hinkle NAME (PRINT OR TYPE) 2/17/2022 DATE 405-848-0924 PHONE NUMBER
 5600 N. May Avenue, Suite 295 Oklahoma City OK 73112 ADDRESS CITY STATE ZIP
 Laura.hinkle@hoagi.com EMAIL ADDRESS

PLEASE TYPE OR USE BLACK INK ONLY
FORMATION RECORD

Give formation names and tops, if available, or descriptions and thickness of formations drilled through. Show intervals cored or drillstem tested.

LEASE NAME Lincoln North Unit WELL NO. 128-2HO

NAMES OF FORMATIONS	TVD	TOP
Oswego		6260'

FOR COMMISSION USE ONLY

ITD on file YES NO

APPROVED _____ DISAPPROVED _____ 2) Reject Codes _____

Were open hole logs run? yes no

Date Last log was run _____

Was CO₂ encountered? yes no at what depths? _____

Was H₂S encountered? yes no at what depths? _____

Were unusual drilling circumstances encountered? yes no
If yes, briefly explain below _____

Other remarks: _____

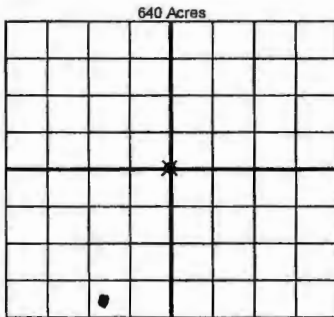

If more than three drainholes are proposed, attach a separate sheet indicating the necessary information.

Direction must be stated in degrees azimuth. Please note, the horizontal drainhole and its end point must be located within the boundaries of the lease or spacing unit.

Directional surveys are required for all drainholes and directional wells

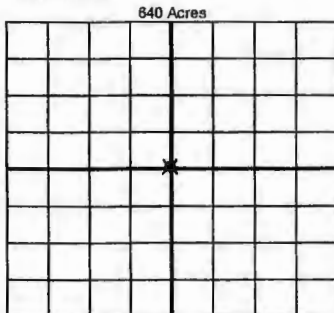

BOTTOM HOLE LOCATION FOR DIRECTIONAL HOLE

SEC	TWP	RGE	COUNTY
1/4	1/4	1/4	1/4
Measured Total Depth	True Vertical Depth	BHL From Lease, Unit, or Property Line:	

BOTTOM HOLE LOCATION FOR HORIZONTAL HOLE: (LATERALS)

LATERAL #1

SEC	TWP	RGE	COUNTY
13	17N	06W	Kingfisher
SE 1/4	SE 1/4	SE 1/4	SW 1/4
Depth of Deviation	5596'	Radius of Turn	1287'
Measured Total Depth	11,650'	True Vertical Depth	6436'
Direction	181° South		Total Length
BHL From Lease, Unit, or Property Line:			180'
			FWL 1480'

LATERAL #2

SEC	TWP	RGE	COUNTY
1/4	1/4	1/4	1/4
Depth of Deviation	Radius of Turn	Direction	Total Length
Measured Total Depth	True Vertical Depth	BHL From Lease, Unit, or Property Line:	

LATERAL #3

SEC	TWP	RGE	COUNTY
1/4	1/4	1/4	1/4
Depth of Deviation	Radius of Turn	Direction	Total Length
Measured Total Depth	True Vertical Depth	BHL From Lease, Unit, or Property Line:	