

Oklahoma Corporation Commission
Oil & Gas Conservation Division
Post Office Box 52000
Oklahoma City, Oklahoma 73152-2000
Rule 165: 10-3-25

Form 1002A

API No.: 35073267820000

Completion Report

Spud Date: February 25, 2022

OTC Prod. Unit No.: 073-227737-0-0424

Drilling Finished Date: March 06, 2022

1st Prod Date: March 26, 2022

Completion Date: March 15, 2022

Drill Type: HORIZONTAL HOLE

Min Gas Allowable: Yes

Well Name: LINCOLN SOUTHEAST OSWEGO UNIT 57-3HO

Purchaser/Measurer:

Location: KINGFISHER 20 17N 5W
SE SE SE SE
207 FSL 238 FEL of 1/4 SEC
Latitude: 35.927418 Longitude: -97.748574
Derrick Elevation: 0 Ground Elevation: 988

First Sales Date:

Operator: HINKLE OIL & GAS INC 21639

5600 N MAY AVE STE 295
OKLAHOMA CITY, OK 73112-4275

Completion Type	
X	Single Zone
	Multiple Zone
	Commingled

Location Exception	
Order No	
There are no Location Exception records to display.	

Increased Density	
Order No	
There are no Increased Density records to display.	

Casing and Cement							
Type	Size	Weight	Grade	Feet	PSI	SAX	Top of CMT
CONDUCTOR	20			90			SURFACE
SURFACE	9 5/8	40	J-55	333		125	SURFACE
PRODUCTION	7	26	P-110	6613		225	3858

Liner								
Type	Size	Weight	Grade	Length	PSI	SAX	Top Depth	Bottom Depth
LINER	4 1/2	11.6	P-110	5310	0	460	6367	11677

Total Depth: 11684

Packer	
Depth	Brand & Type
There are no Packer records to display.	

Plug	
Depth	Plug Type
There are no Plug records to display.	

Initial Test Data

Test Date	Formation	Oil BBL/Day	Oil-Gravity (API)	Gas MCF/Day	Gas-Oil Ratio Cu FT/BBL	Water BBL/Day	Pumpin or Flowing	Initial Shut-In Pressure	Choke Size	Flow Tubing Pressure
Apr 06, 2022	OSWEGO	519	42.7	528	1017	2437	PUMPING		OPEN	

Completion and Test Data by Producing Formation

Formation Name: OSWEGO

Code: 404OSWG

Class: OIL

Spacing Orders

Order No	Unit Size
52793	UNIT

Perforated Intervals

From	To
6590	11475

Acid Volumes

There are no Acid Volume records to display.

Fracture Treatments

194,250 GALLONS HCL, 58,659 BARRELS SLICK WATER

Formation	Top
OSWEGO	6101

Were open hole logs run? No

Date last log run:

Were unusual drilling circumstances encountered? No

Explanation:

Other Remarks

There are no Other Remarks.

Lateral Holes

Sec: 21 TWP: 17N RGE: 5W County: KINGFISHER

NW NW NW NW

1 FNL 70 FWL of 1/4 SEC

Depth of Deviation: 5502 Radius of Turn: 1293 Direction: 358 Total Length: 4889

Measured Total Depth: 11684 True Vertical Depth: 6229 End Pt. Location From Release, Unit or Property Line: 1

FOR COMMISSION USE ONLY

1148051

Status: Accepted

API NO. 35-073-26782

Oil and Gas Conservation Division
P.O. Box 52000
Oklahoma City, OK 73152-2000
405-521-2331
OCCentralProcessing@OCC.OK.GOV



OKLAHOMA
Corporation
Commission

Form 1002A
Rev. 2021

ORIGINAL
 AMENDED (Reason) _____

Rule 165:10-3-25

COMPLETION REPORT

TYPE OF DRILLING OPERATION

STRAIGHT HOLE DIRECTIONAL HOLE HORIZONTAL HOLE

SPUD DATE 2/25/2022
DRLG FINISHED DATE 3/06/2022

If directional or horizontal, see reverse for bottom hole location.

COUNTY Kingfisher SEC 20 TWP 17N RGE 05W

DATE OF WELL COMPLETION 3/15/2022

LEASE NAME Lincoln Southeast Oswego Unit

WELL NO. 57-3HO 1st PROD DATE 3/26/2022

SE 1/4 SE 1/4 SE 1/4 SE 1/4 FSL 207' FEL 238'

RECOMP DATE

ELEVATION Derrick FL Ground 988'

Latitude 35.927393 Longitude -97.748167

OPERATOR NAME Hinkle Oil & Gas, Inc.

OTC / OCC OPERATOR NO. 21639

ADDRESS 5600 N. May Avenue, Suite 295

CITY Oklahoma City STATE OK ZIP 73112

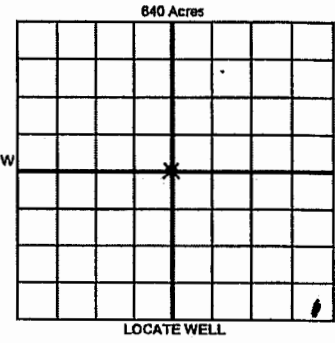

COMPLETION TYPE

SINGLE ZONE
 MULTIPLE ZONE
 COMMINGLED
LOCATION EXCEPTION ORDER NO.
MULTIUNIT ORDER NO.
INCREASED DENSITY ORDER NO.

CASING & CEMENT (Attach Form 1002C)

TYPE	SIZE	WEIGHT	GRADE	FEET	PSI	SAX	TOP OF CMT
CONDUCTOR	20"			90'			Surface
SURFACE	9 5/8"	40#	J55	333'		125	Surface
INTERMEDIATE	7"	26#	P110	6613'		225	3858'
PRODUCTION							
LINER	4 1/2"	11.6#	P110	6367'-11,677'		460	6367'

PACKER @ _____ BRAND & TYPE _____ PLUG @ _____ TYPE _____ PLUG @ _____ TYPE _____ TOTAL DEPTH 11,684'

COMPLETION & TEST DATA BY PRODUCING FORMATION *4040 SWG*

FORMATION	Oswego						
SPACING & SPACING ORDER NUMBER	52793 (unit)						<i>Reported 76 Free Pools</i>
CLASS: Oil, Gas, Dry, Inj, Disp, Comm Disp, Svc	Oil						
PERFORATED INTERVALS	6590'-11,475'						RECEIVED APR 25 2022 OKLAHOMA CORPORATION COMMISSION
ACID/VOLUME							
FRACTURE TREATMENT (Fluids/Prop Amounts)	194250 Gal. HCL 58659 Bbl. Slick Water						

Min Gas Allowable (165:10-17-7) OR Oil Allowable (165:10-13-3) Purchaser/Measurer _____ First Sales Date _____

INITIAL TEST DATA

INITIAL TEST DATE	4/06/2022				
OIL-BBL/DAY	519				
OIL-GRAVITY (API)	42.7				
GAS-MCF/DAY	528				
GAS-OIL RATIO CU FT/BBL	1017				
WATER-BBL/DAY	2437				
PUMPING OR FLOWING	Pumping				
INITIAL SHUT-IN PRESSURE	N/A				
CHOKE SIZE	Open				
FLOW TUBING PRESSURE	N/A				

A record of the formations drilled through, and pertinent remarks are presented on the reverse. I declare that I have knowledge of the contents of this report and am authorized by my organization to make this report, which was prepared by me or under my supervision and direction, with the data and facts stated herein to be true, correct, and complete to the best of my knowledge and belief.

<i>B. Hinkle</i> SIGNATURE	Bruce A. Hinkle NAME (PRINT OR TYPE)	4/21/2022 DATE	405-848-0924 PHONE NUMBER
5600 N. May Avenue, Suite 295 ADDRESS	Oklahoma City OK 73112 CITY STATE ZIP	Laurahinkle@hoagtl.com EMAIL ADDRESS	

PLEASE TYPE OR USE BLACK INK ONLY
FORMATION RECORD

Give formation names and tops, if available, or descriptions and thickness of formations drilled through. Show intervals cored or drillstem tested.

LEASE NAME Lincoln Southeast Oswego Unit WELL NO. 57-3HO

NAMES OF FORMATIONS	TOP
Oswego	6101'

FOR COMMISSION USE ONLY

ITD on file YES NO

APPROVED _____ DISAPPROVED _____

2) Reject Codes _____

Were open hole logs run? yes no

Date Last log was run _____

Was CO₂ encountered? yes no at what depths? _____

Was H₂S encountered? yes no at what depths? _____

Were unusual drilling circumstances encountered? yes no
If yes, briefly explain below _____

Other remarks: _____

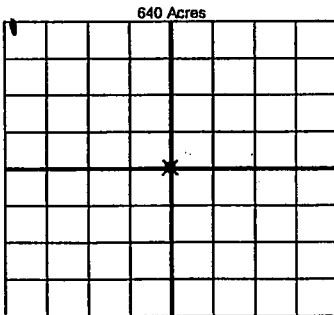

If more than three drainholes are proposed, attach a separate sheet indicating the necessary information.

Direction must be stated in degrees azimuth. Please note, the horizontal drainhole and its end point must be located within the boundaries of the lease or spacing unit.

Directional surveys are required for all drainholes and directional wells

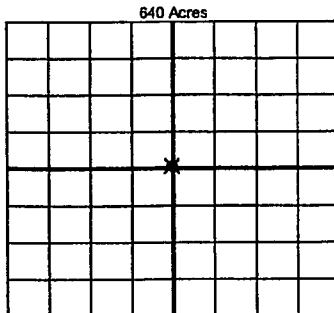

BOTTOM HOLE LOCATION FOR DIRECTIONAL HOLE

SEC	TWP	RGE	COUNTY	Feet From 1/4 Sec Lines		
	1/4	1/4	1/4	1/4		
Measured Total Depth		True Vertical Depth		BHL From Lease, Unit, or Property Line:		

BOTTOM HOLE LOCATION FOR HORIZONTAL HOLE: (LATERALS)

LATERAL #1

SEC	TWP	RGE	COUNTY	Kingfisher					
21	17N	05W		NW 1/4	NW 1/4	NW 1/4	Feet From 1/4 Sec Lines	FNL 1'	FWL 70'
Depth of Deviation		Radius of Turn		Direction		Total Length			
5502'		1293'		350 North		4889'			
Measured Total Depth		True Vertical Depth		BHL From Lease, Unit, or Property Line:					
11,684'		6229'		1'					

LATERAL #2

SEC	TWP	RGE	COUNTY	Feet From 1/4 Sec Lines					
	1/4	1/4	1/4	1/4					
Depth of Deviation		Radius of Turn		Direction		Total Length			
Measured Total Depth		True Vertical Depth		BHL From Lease, Unit, or Property Line:					

LATERAL #3

SEC	TWP	RGE	COUNTY	Feet From 1/4 Sec Lines					
	1/4	1/4	1/4	1/4					
Depth of Deviation		Radius of Turn		Direction		Total Length			
Measured Total Depth		True Vertical Depth		BHL From Lease, Unit, or Property Line:					