

Oklahoma Corporation Commission
Oil & Gas Conservation Division
Post Office Box 52000
Oklahoma City, Oklahoma 73152-2000
Rule 165: 10-3-25

Form 1002A

API No.: 35073268190000

Completion Report

Spud Date: March 24, 2022

OTC Prod. Unit No.: 073-227821-0-0424

Drilling Finished Date: April 07, 2022

1st Prod Date: April 22, 2022

Completion Date: April 20, 2022

Drill Type: HORIZONTAL HOLE

Min Gas Allowable: Yes

Well Name: LINCOLN SOUTHEAST OSWEGO UNIT 25-4HO

Purchaser/Measurer:

Location: KINGFISHER 18 17N 5W
NW NW NW NE
201 FNL 2457 FEL of 1/4 SEC
Latitude: 35.955417 Longitude: -97.773092
Derrick Elevation: 0 Ground Elevation: 1102

First Sales Date:

Operator: HINKLE OIL & GAS INC 21639

5600 N MAY AVE STE 295
OKLAHOMA CITY, OK 73112-4275

Completion Type	
X	Single Zone
	Multiple Zone
	Commingled

Location Exception
Order No
There are no Location Exception records to display.

Increased Density
Order No
There are no Increased Density records to display.

Casing and Cement							
Type	Size	Weight	Grade	Feet	PSI	SAX	Top of CMT
CONDUCTOR	20			90			SURFACE
SURFACE	9 5/8	40	J-55	333		165	SURFACE
PRODUCTION	7	26	P-110	6861		215	2453

Liner								
Type	Size	Weight	Grade	Length	PSI	SAX	Top Depth	Bottom Depth
LINER	4 1/2	11.6	P-110	5892	0	515	6587	12479

Total Depth: 12494

Packer	
Depth	Brand & Type
There are no Packer records to display.	

Plug	
Depth	Plug Type
There are no Plug records to display.	

Initial Test Data

Test Date	Formation	Oil BBL/Day	Oil-Gravity (API)	Gas MCF/Day	Gas-Oil Ratio Cu FT/BBL	Water BBL/Day	Pumpin or Flowing	Initial Shut-In Pressure	Choke Size	Flow Tubing Pressure
Apr 30, 2022	OSWEGO	635	44.1	536	844	2011	PUMPING		OPEN	

Completion and Test Data by Producing Formation

Formation Name: OSWEGO

Code: 404OSWG

Class: OIL

Spacing Orders

Order No	Unit Size
52793	UNIT

Perforated Intervals

From	To
6870	12053

Acid Volumes

204,750 GALLONS 15% HCL, 61,729 BARRELS SLICK WATER

Fracture Treatments

There are no Fracture Treatments records to display.

Formation	Top
OSWEGO	6232

Were open hole logs run? No

Date last log run:

Were unusual drilling circumstances encountered? No

Explanation:

Other Remarks

There are no Other Remarks.

Lateral Holes

Sec: 18 TWP: 17N RGE: 5W County: KINGFISHER

SE SE SW SE

1 FSL 1560 FEL of 1/4 SEC

Depth of Deviation: 5697 Radius of Turn: 1308 Direction: 179 Total Length: 5489

Measured Total Depth: 12494 True Vertical Depth: 6410 End Pt. Location From Release, Unit or Property Line: 1

FOR COMMISSION USE ONLY

1148134

Status: Accepted

API NO. 35-073-26819
 OTC PROD UNIT NO. 073-227821
 -0-0424

Oil and Gas Conservation Division
 P.O. Box 52000
 Oklahoma City, OK 73152-2000
 405-521-2331
 OCCCentralProcessing@OCC.OK.GOV



OKLAHOMA
 Corporation
 Commission

Form 1002A
 Rev. 2021

ORIGINAL AMENDED (Reason) _____

Rule 165:10-3-25

COMPLETION REPORT

TYPE OF DRILLING OPERATION
 STRAIGHT HOLE DIRECTIONAL HOLE HORIZONTAL HOLE
 SERVICE WELL
 If directional or horizontal, see reverse for bottom hole location.

SPUD DATE 3/24/2022
 DRLG FINISHED DATE 4/07/2022
 DATE OF WELL COMPLETION 4/20/2022
 1st PROD DATE 4/22/2022
 RECOMP DATE _____

COUNTY Kingfisher SEC 18 TWP 17N RGE 05W
 LEASE NAME Lincoln Southeast Oswego Unit WELL NO. 25-4HO
 NW 1/4 NW 1/4 NW 1/4 NE 1/4 (FNL) 201' (FEL) 2457'
 ELEVATION Ground 1102' Latitude 35.955417 Longitude -97.773092
 OPERATOR NAME Hinkle Oil & Gas, Inc. OTC / OCC OPERATOR NO. 21639
 ADDRESS 5600 N. May Avenue, Suite 295
 CITY Oklahoma City STATE OK ZIP 73112

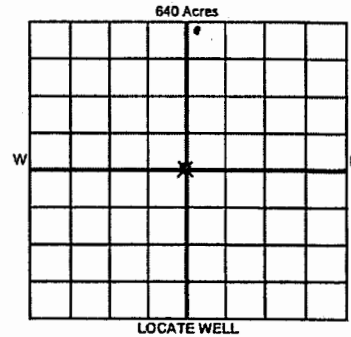

COMPLETION TYPE
 SINGLE ZONE
 MULTIPLE ZONE
 COMMINGLED
 LOCATION EXCEPTION ORDER NO. _____
 MULTIUNIT ORDER NO. _____
 INCREASED DENSITY ORDER NO. _____

CASING & CEMENT (Attach Form 1002C)							
TYPE	SIZE	WEIGHT	GRADE	FEET	PSI	SAX	TOP OF CMT
CONDUCTOR	20"			90'			Surface
SURFACE	9 5/8"	40#	J55	333'		165	Surface
INTERMEDIATE	7"	26#	P110	6861'		215	2453'
PRODUCTION							
LINER	4 1/2"	11.6#	P110	6587'-12,479'		515	6687'

PACKER @ _____ BRAND & TYPE _____ PLUG @ _____ TYPE _____ PLUG @ _____ TYPE _____ TOTAL DEPTH 12,494'

COMPLETION & TEST DATA BY PRODUCING FORMATION 404 OSWEG

FORMATION	<u>Oswego</u>						<u>No Frac</u>
SPACING & SPACING ORDER NUMBER	<u>52793 (unit)</u>						
CLASS: Oil, Gas, Dry, Int, Disp, Comm Disp, Svc	<u>Oil</u>						
PERFORATED INTERVALS	<u>6870'-12,053'</u>						
ACID VOLUME							
FRACTURE TREATMENT (Fluids/Prop Amounts)	<u>204750 Gal. 15% HCL 61729 Bbl. Slick Water</u>						

RECEIVED
 MAY 09 2022
 OKLAHOMA CORPORATION COMMISSION

Min Gas Allowable (165:10-17-7) OR Oil Allowable (165:10-13-3)

Purchaser/Measurer _____
 First Sale Date _____

INITIAL TEST DATA	
INITIAL TEST DATE	<u>4/30/2022</u>
OIL-BBL/DAY	<u>635</u>
OIL-GRAVITY (API)	<u>44.1</u>
GAS-MCF/DAY	<u>536</u>
GAS-OIL RATIO CU FT/BBL	<u>844</u>
WATER-BBL/DAY	<u>2011</u>
PUMPING OR FLOWING	<u>Pumping</u>
INITIAL SHUT-IN PRESSURE	<u>N/A</u>
CHOKE SIZE	<u>Open</u>
FLOW TUBING PRESSURE	<u>N/A</u>

A record of the formations drilled through, and pertinent remarks are presented on the reverse. I declare that I have knowledge of the contents of this report and am authorized by my organization to make this report, which was prepared by me or under my supervision and direction, with the data and facts stated herein to be true, correct, and complete to the best of my knowledge and belief.

B. Hinkle SIGNATURE NAME (PRINT OR TYPE) Bruce A. Hinkle DATE 5/06/2022 PHONE NUMBER 405-848-0924
5600 N. May Avenue, Suite 295 ADDRESS CITY Oklahoma City STATE OK ZIP 73112 EMAIL ADDRESS Laurahinkle@hoagi.com

PLEASE TYPE OR USE BLACK INK ONLY
FORMATION RECORD

Give formation names and tops, if available, or descriptions and thickness of formations drilled through. Show intervals cored or drillstem tested.

LEASE NAME Lincoln Southeast Oswego Unit WELL NO. 25-4HO

NAMES OF FORMATIONS	TOP
Oswego TVD	6232'

FOR COMMISSION USE ONLY

ITD on file YES NO

APPROVED _____ DISAPPROVED _____

2) Reject Codes _____

Were open hole logs run? yes no

Date Last log was run _____

Was CO₂ encountered? yes no at what depths? _____

Was H₂S encountered? yes no at what depths? _____

Were unusual drilling circumstances encountered? yes no
If yes, briefly explain below.

Other remarks: _____

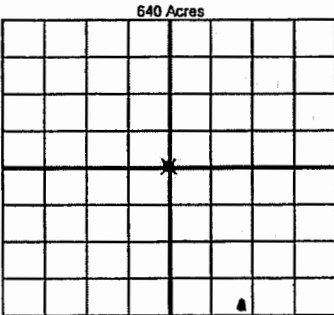

If more than three drainholes are proposed, attach a separate sheet indicating the necessary information.

Direction must be stated in degrees azimuth. Please note, the horizontal drainhole and its end point must be located within the boundaries of the lease or spacing unit.

Directional surveys are required for all drainholes and directional wells

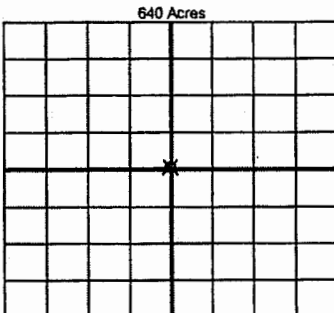

BOTTOM HOLE LOCATION FOR DIRECTIONAL HOLE

SEC	TWP	RGE	COUNTY
1/4	1/4	1/4	1/4
Feet From 1/4 Sec Lines			
Measured Total Depth		True Vertical Depth	
BHL From Lease, Unit, or Property Line:			

BOTTOM HOLE LOCATION FOR HORIZONTAL HOLE: (LATERALS)

LATERAL #1

SEC	TWP	RGE	COUNTY
18	17N	05W	Kingfisher
SE 1/4	SE 1/4	SW 1/4	SE 1/4
Feet From 1/4 Sec Lines			
Depth of Deviation		Radius of Turn	Direction
5697'		1308'	179 South
Measured Total Depth		True Vertical Depth	
12,494'		6410'	
BHL From Lease, Unit, or Property Line:			
1'			

LATERAL #2

SEC	TWP	RGE	COUNTY
1/4	1/4	1/4	1/4
Feet From 1/4 Sec Lines			
Depth of Deviation		Radius of Turn	Direction
Measured Total Depth		True Vertical Depth	
BHL From Lease, Unit, or Property Line:			

LATERAL #3

SEC	TWP	RGE	COUNTY
1/4	1/4	1/4	1/4
Feet From 1/4 Sec Lines			
Depth of Deviation		Radius of Turn	Direction
Measured Total Depth		True Vertical Depth	
BHL From Lease, Unit, or Property Line:			