

Oklahoma Corporation Commission
Oil & Gas Conservation Division
Post Office Box 52000
Oklahoma City, Oklahoma 73152-2000
Rule 165: 10-3-25

Form 1002A

API No.: 35073267870000

Completion Report

Spud Date: December 01, 2021

OTC Prod. Unit No.: 073-227561-0-0424

Drilling Finished Date: December 13, 2021

1st Prod Date: December 26, 2021

Completion Date: December 20, 2021

Drill Type: HORIZONTAL HOLE

Min Gas Allowable: Yes

Well Name: LINCOLN SOUTHEAST OSWEGO UNIT 49-3HO

Purchaser/Measurer:

Location: KINGFISHER 17 17N 5W
NW SW SW SW
484 FSL 182 FWL of 1/4 SEC
Latitude: 35.942732 Longitude: -97.764147
Derrick Elevation: 0 Ground Elevation: 1067

First Sales Date:

Operator: HINKLE OIL & GAS INC 21639

5600 N MAY AVE STE 295
OKLAHOMA CITY, OK 73112-4275

Completion Type		Location Exception		Increased Density	
X	Single Zone	Order No		Order No	
	Multiple Zone	There are no Location Exception records to display.		There are no Increased Density records to display.	
	Commingled				

Casing and Cement							
Type	Size	Weight	Grade	Feet	PSI	SAX	Top of CMT
CONDUCTOR	20			80			SURFACE
SURFACE	9 5/8	36	LTC	339		125	SURFACE
PRODUCTION	7	26	P-110	6677		225	4093

Liner								
Type	Size	Weight	Grade	Length	PSI	SAX	Top Depth	Bottom Depth
LINER	4 1/2	13.5	P-110	5427	0	460	6398	11825

Total Depth: 11840

Packer	
Depth	Brand & Type
There are no Packer records to display.	

Plug	
Depth	Plug Type
There are no Plug records to display.	

Initial Test Data

Test Date	Formation	Oil BBL/Day	Oil-Gravity (API)	Gas MCF/Day	Gas-Oil Ratio Cu FT/BBL	Water BBL/Day	Pumpin or Flowing	Initial Shut-In Pressure	Choke Size	Flow Tubing Pressure
Jan 02, 2021	OSWEGO	778	44	589	757	2055	PUMPING		OPEN	

Completion and Test Data by Producing Formation

Formation Name: OSWEGO

Code: 404OSWG

Class: OIL

Spacing Orders

Order No	Unit Size
52793	UNIT

Perforated Intervals

From	To
6951	11670

Acid Volumes

193,704 GALLONS 15% HCL, 58,118 BARRELS SLICK WATER

Fracture Treatments

There are no Fracture Treatments records to display.

Formation	Top
OSWEGO	6225

Were open hole logs run? No

Date last log run:

Were unusual drilling circumstances encountered? No

Explanation:

Other Remarks

There are no Other Remarks.

Lateral Holes

Sec: 20 TWP: 17N RGE: 5W County: KINGFISHER

SW SW SW SW

1 FSL 160 FWL of 1/4 SEC

Depth of Deviation: 5526 Radius of Turn: 1308 Direction: 177 Total Length: 5006

Measured Total Depth: 11840 True Vertical Depth: 6394 End Pt. Location From Release, Unit or Property Line: 1

FOR COMMISSION USE ONLY

Status: Accepted

1148181

API NO. 35-073-26787
OTC PROD UNIT NO. 073-227561
-D-0424

Oil and Gas Conservation Division
P.O. Box 52000
Oklahoma City, OK 73152-2000
405-521-2331
OCCCentralProcessing@OCC.OK.GOV



OKLAHOMA
Corporation
Commission

Form 1002A
Rev. 2021

8 ORIGINAL
8 AMENDED (Reason)

Rule 165:10-3-25

COMPLETION REPORT

TYPE OF DRILLING OPERATION

☐ STRAIGHT HOLE ☐ DIRECTIONAL HOLE ☒ HORIZONTAL HOLE
☐ SERVICE WELL

If directional or horizontal, see reverse for bottom hole location.

COUNTY Kingfisher SEC 17 TWP 17N RGE 05W

LEASE NAME Lincoln Southeast Oswego Unit WELL NO. 49-3HO

NW 1/4 SW 1/4 SW 1/4 SW 1/4 FBL 484' FWL 182'

ELEVATION Ground 1067' Latitude 35.942732 Longitude -97.764147

OPERATOR NAME Hinkle Oil & Gas, Inc. OTC / OCC OPERATOR NO. 21639

ADDRESS 5600 N. May Avenue, Suite 295

CITY Oklahoma City STATE OK ZIP 73112

SPUD DATE 12/1/2021

DRLG FINISHED DATE 12/13/2021

DATE OF WELL COMPLETION 12/20/2021

1st PROD DATE 12/26/2021

RECOMP DATE

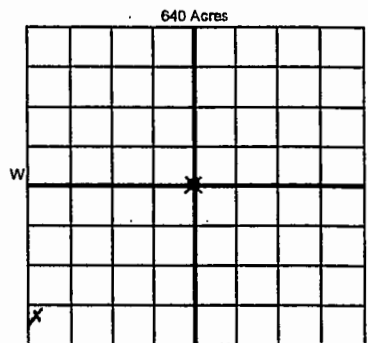

LOCATE WELL

COMPLETION TYPE

<input checked="" type="radio"/> SINGLE ZONE	
<input type="radio"/> MULTIPLE ZONE	
<input type="radio"/> COMMINGLED	
LOCATION EXCEPTION ORDER NO.	
MULTIUNIT ORDER NO.	
INCREASED DENSITY ORDER NO.	

CASING & CEMENT (Attach Form 1002C)

TYPE	SIZE	WEIGHT	GRADE	FEET	PSI	SAX	TOP OF CMT
CONDUCTOR	20"			80'			Surface
SURFACE	9 5/8"	36#	LTC	339'		125	Surface
INTERMEDIATE	7"	26#	P110	6677'		225	4093'
PRODUCTION							
LINER	4 1/2"	13.5#	P110	6398'-11,825'		460	6398'

PACKER @ BRAND & TYPE

PLUG @ TYPE

PLUG @ TYPE

TOTAL DEPTH 11,840'

COMPLETION & TEST DATA BY PRODUCING FORMATION

FORMATION	Oswego						
SPACING & SPACING ORDER NUMBER	52793 (unit)						
CLASS: Oil, Gas, Dry, Inj, Disp, Comm Disp, Svc	Oil						
PERFORATED INTERVALS	6951'-11,670'						
ACID/VOLUME							
FRACTURE TREATMENT (Fluids/Prop Amounts)	193704 Gal. 15% HCl 58118 Bbls. Slick Water						

RECEIVED

JAN 31 2022

OKLAHOMA CORPORATION
COMMISSION

Reported
to FracFocus

☒ Min Gas Allowable (165:10-17-7)
OR
☐ Oil Allowable (165:10-13-3)

Purchaser/Mesurer
First Sales Date

INITIAL TEST DATA

INITIAL TEST DATE	1/2/2021					
OIL-BBL/DAY	778					
OIL-GRAVITY (API)	44.0					
GAS-MCF/DAY	589					
GAS-OIL RATIO CU FT/BBL	757					
WATER-BBL/DAY	2055					
PUMPING OR FLOWING	Pumping					
INITIAL SHUT-IN PRESSURE	N/A					
CHOKE SIZE	Open					
FLOW TUBING PRESSURE	N/A					

A record of the formations drilled through, and pertinent remarks are presented on the reverse. I declare that I have knowledge of the contents of this report and am authorized by my organization to make this report, which was prepared by me or under my supervision and direction, with the data and facts stated herein to be true, correct, and complete to the best of my knowledge and belief.

B. Hinkle
SIGNATURE

Bruce A. Hinkle
NAME (PRINT OR TYPE)

1/27/2022 405-848-0924
DATE PHONE NUMBER

5600 N. May Avenue, Suite 295 Oklahoma City OK 73112
ADDRESS CITY STATE ZIP

Laurahinkle@hoagi.com
EMAIL ADDRESS

PLEASE TYPE OR USE BLACK INK ONLY
FORMATION RECORD

Give formation names and tops, if available, or descriptions and thickness of formations drilled through. Show intervals cored or drilled stem tested.

NAMES OF FORMATIONS	TOP
Oswego TVD	6225'

LEASE NAME Lincoln Southeast Oswego Unit WELL NO. 49-3HO

FOR COMMISSION USE ONLY	
ITD on file <input type="checkbox"/> YES <input type="checkbox"/> NO	
APPROVED _____	DISAPPROVED _____
2) Reject Codes	

Were open hole logs run?	<input type="radio"/> yes <input checked="" type="radio"/> no
Date Last log was run	_____
Was CO ₂ encountered?	<input type="radio"/> yes <input checked="" type="radio"/> no at what depths? _____
Was H ₂ S encountered?	<input type="radio"/> yes <input checked="" type="radio"/> no at what depths? _____
Were unusual drilling circumstances encountered?	<input type="radio"/> yes <input checked="" type="radio"/> no
If yes, briefly explain below	

Other remarks:

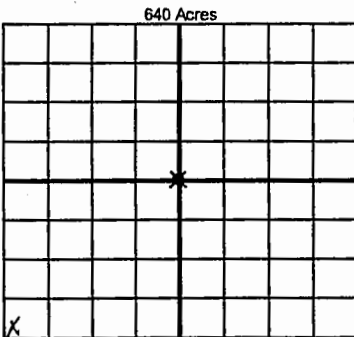

If more than three drainholes are proposed, attach a separate sheet indicating the necessary information.

Direction must be stated in degrees azimuth. Please note, the horizontal drainhole and its end point must be located within the boundaries of the lease or spacing unit.

Directional surveys are required for all drainholes and directional wells

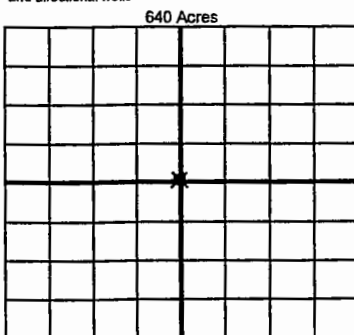

BOTTOM HOLE LOCATION FOR DIRECTIONAL HOLE

SEC	TWP	RGE	COUNTY
1/4	1/4	1/4	1/4
Measured Total Depth		True Vertical Depth	BHL From Lease, Unit, or Property Line:

BOTTOM HOLE LOCATION FOR HORIZONTAL HOLE: (LATERALS)

LATERAL #1				Kingfisher			
SEC	TWP	RGE	COUNTY				
20	17N	05W		SW 1/4	SW 1/4	SW 1/4	SW 1/4
Depth of Deviation		Radius of Turn		Feet From 1/4 Sec Lines		FSL	1'
5526'		1308		177 South		Total Length	5006'
Measured Total Depth		True Vertical Depth		BHL From Lease, Unit, or Property Line:		1'	
11,840'		6394'					

LATERAL #2			
SEC	TWP	RGE	COUNTY
1/4	1/4	1/4	1/4
Depth of Deviation		Radius of Turn	Direction
Measured Total Depth		True Vertical Depth	Total Length
			BHL From Lease, Unit, or Property Line:

LATERAL #3			
SEC	TWP	RGE	COUNTY
1/4	1/4	1/4	1/4
Depth of Deviation		Radius of Turn	Direction
Measured Total Depth		True Vertical Depth	Total Length
			BHL From Lease, Unit, or Property Line: