

Oklahoma Corporation Commission  
Oil & Gas Conservation Division  
Post Office Box 52000  
Oklahoma City, Oklahoma 73152-2000  
Rule 165: 10-3-25

Form 1002A

API No.: 35073267890000

**Completion Report**

Spud Date: December 11, 2021

OTC Prod. Unit No.: 073-227568-0-0424

Drilling Finished Date: December 21, 2021

1st Prod Date: January 06, 2022

Completion Date: December 27, 2021

**Drill Type:** HORIZONTAL HOLE

Min Gas Allowable: Yes

Well Name: LINCOLN SOUTHEAST OSWEGO UNIT 59-1HO

Purchaser/Measurer:

Location: KINGFISHER 20 17N 5W  
SE SE SW SE  
185 FSL 1445 FEL of 1/4 SEC  
Latitude: 35.927313 Longitude: -97.752574  
Derrick Elevation: 0 Ground Elevation: 987

First Sales Date:

Operator: HINKLE OIL & GAS INC 21639

5600 N MAY AVE STE 295  
OKLAHOMA CITY, OK 73112-4275

Completion Type		Location Exception		Increased Density	
X	Single Zone	Order No		Order No	
	Multiple Zone	There are no Location Exception records to display.		There are no Increased Density records to display.	
	Commingled				

Casing and Cement							
Type	Size	Weight	Grade	Feet	PSI	SAX	Top of CMT
CONDUCTOR	20			90			SURFACE
SURFACE	9 5/8	36	LTC	322		125	SURFACE
PRODUCTION	7	26	P-110	6725		225	4092

Liner								
Type	Size	Weight	Grade	Length	PSI	SAX	Top Depth	Bottom Depth
LINER	4 1/2	13.5	P-110	4957	0	460	6491	11448

**Total Depth: 11454**

Packer		Plug	
Depth	Brand & Type	Depth	Plug Type
There are no Packer records to display.		There are no Plug records to display.	

Initial Test Data
-------------------

Test Date	Formation	Oil BBL/Day	Oil-Gravity (API)	Gas MCF/Day	Gas-Oil Ratio Cu FT/BBL	Water BBL/Day	Pumpin or Flowing	Initial Shut-In Pressure	Choke Size	Flow Tubing Pressure
Jan 14, 2022	OSWEGO	417	44	336	806	2038	PUMPING		OPEN	

#### Completion and Test Data by Producing Formation

Formation Name: OSWEGO

Code: 404OSWG

Class: OIL

#### Spacing Orders

Order No	Unit Size
52793	UNIT

#### Perforated Intervals

From	To
6780	11270

#### Acid Volumes

191,814 GALLONS 15% HCL, 58,576 BARRELS SLICK WATER

#### Fracture Treatments

There are no Fracture Treatments records to display.

Formation	Top
OSWEGO	6152

Were open hole logs run? No

Date last log run:

Were unusual drilling circumstances encountered? No

Explanation:

#### Other Remarks

There are no Other Remarks.

#### Lateral Holes

Sec: 20 TWP: 17N RGE: 5W County: KINGFISHER

NW NW NW NE

1 FNL 2510 FEL of 1/4 SEC

Depth of Deviation: 5640 Radius of Turn: 1364 Direction: 360 Total Length: 4450

Measured Total Depth: 11454 True Vertical Depth: 6271 End Pt. Location From Release, Unit or Property Line: 1

#### FOR COMMISSION USE ONLY

Status: Accepted

1148183

API NO. 35-073-26789

OTC PROD UNIT NO. 073-227568  
-0-0424Oil and Gas Conservation Division  
P.O. Box 52000  
Oklahoma City, OK 73152-2000  
405-521-2331  
OCCCentralProcessing@OCC.OK.GOVOKLAHOMA  
Corporation  
Commission

Form 1002A

Rev. 2021

ORIGINAL  
AMENDED (Reason)

Rule 165:10-3-25

## COMPLETION REPORT

## TYPE OF DRILLING OPERATION

☐ STRAIGHT HOLE ☐ DIRECTIONAL HOLE ☒ HORIZONTAL HOLE  
SERVICE WELL

If directional or horizontal, see reverse for bottom hole location.

COUNTY	Kingfisher	SEC	20	TWP	17N	RGE	05W	SPUD DATE	12/10/2021
LEASE NAME	Lincoln Southeast Oswego Unit	WELL NO.	59-1HO	DRLG FINISHED DATE	12/21/2021	DATE OF WELL COMPLETION	12/27/2021	1st PROD DATE	1/6/2022
SE 1/4 SE 1/4 SW 1/4 SE 1/4	FSL	185'	(FEL)	1445'	RECOMP DATE				
ELEVATION	Ground	987'	Latitude	35.927350	Longitude	-97.755832			
OPERATOR NAME	Hinkle Oil & Gas, Inc.	OTC / OCC OPERATOR NO.	21639						
ADDRESS	5600 N. May Avenue, Suite 29								
CITY	Oklahoma City	STATE	OK	ZIP	73112				

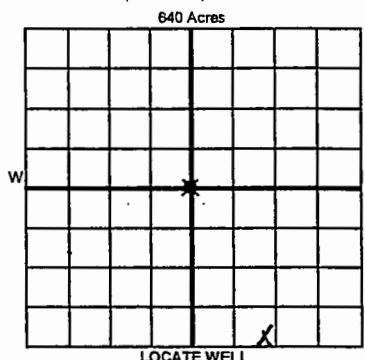

## COMPLETION TYPE

<input checked="" type="radio"/> SINGLE ZONE	
<input type="radio"/> MULTIPLE ZONE	
Application Date	
<input type="radio"/> COMMINGLED	
Application Date	
LOCATION EXCEPTION ORDER NO.	
MULTIUNIT ORDER NO.	
INCREASED DENSITY ORDER NO.	

## CASING &amp; CEMENT (Attach Form 1002C)

TYPE	SIZE	WEIGHT	GRADE	FEET	PSI	SAX	TOP OF CMT
CONDUCTOR	20"			90'			Surface
SURFACE	9 5/8"	36#	LTC	322'		125	Surface
INTERMEDIATE	7"	26#	P110	6725'		225	4092
PRODUCTION							
LINER	4 1/2"	13.5#	P110	6491'-11,448'		460	6491'

PACKER @ \_\_\_\_\_ BRAND & TYPE \_\_\_\_\_ PLUG @ \_\_\_\_\_ TYPE \_\_\_\_\_ PLUG @ \_\_\_\_\_ TYPE \_\_\_\_\_ TOTAL DEPTH 11,454'

PACKER @ \_\_\_\_\_ BRAND & TYPE \_\_\_\_\_ PLUG @ \_\_\_\_\_ TYPE \_\_\_\_\_ PLUG @ \_\_\_\_\_ TYPE \_\_\_\_\_

## COMPLETION &amp; TEST DATA BY PRODUCING FORMATION

FORMATION	Oswego						Reported to Fair Focus
SPACING & SPACING ORDER NUMBER	52793 (unit)						
CLASS: Oil, Gas, Dry, Inj, Disp, Comm Disp, Svc	Oil						
PERFORATED INTERVALS	6780'-11,270'						RECEIVED JAN 31 2022
ACID/VOLUME							OKLAHOMA CORPORATION COMMISSION
FRACTURE TREATMENT (Fluids/Prop Amounts)	191814 Gal. 15% HCl 58576 Bbl. Slick Water						

☒ Min Gas Allowable (165:10-17-7)

OR

☐ Oil Allowable (165:10-13-3)

Purchaser/Measurer

First Sales Date

## INITIAL TEST DATA

INITIAL TEST DATE	1/14/2022					
OIL-BBL/DAY	417					
OIL-GRAVITY (API)	44.0					
GAS-MCF/DAY	336					
GAS-OIL RATIO CU FT/BBL	806					
WATER-BBL/DAY	2038					
PUMPING OR FLOWING	Pumping					
INITIAL SHUT-IN PRESSURE	N/A					
CHOKE SIZE	Open					
FLOW TUBING PRESSURE	N/A					

A record of the formations drilled through, and pertinent remarks are presented on the reverse. I declare that I have knowledge of the contents of this report and am authorized by my organization to make this report, which was prepared by me or under my supervision and direction, with the data and facts stated herein to be true, correct, and complete to the best of my knowledge and belief.

Bruce A. Hinkle

1/27/2022 405-848-0924

SIGNATURE

NAME (PRINT OR TYPE)

DATE

PHONE NUMBER

5600 N. May Avenue, Suite 295

Oklahoma City

OK

73112

Laurahinkle@hoagi.com

ADDRESS

CITY

STATE

ZIP

EMAIL ADDRESS

PLEASE TYPE OR USE BLACK INK ONLY

FORMATION RECORD

Give formation names and tops, if available, or descriptions and thickness of formations drilled through. Show intervals cored or drillstem tested.

NAMES OF FORMATIONS	TOP
Oswego	TVD 6152'

LEASE NAME Lincoln Southeast Oswego Unit WELL NO. 59-1HO

FOR COMMISSION USE ONLY	
ITD on file <input type="checkbox"/> YES <input type="checkbox"/> NO	
APPROVED _____ DISAPPROVED _____	2) Reject Codes

Were open hole logs run?	<input type="radio"/> yes <input checked="" type="radio"/> no
Date Last log was run	_____
Was CO <sub>2</sub> encountered?	<input type="radio"/> yes <input checked="" type="radio"/> no at what depths? _____
Was H <sub>2</sub> S encountered?	<input type="radio"/> yes <input checked="" type="radio"/> no at what depths? _____
Were unusual drilling circumstances encountered?	<input type="radio"/> yes <input checked="" type="radio"/> no
If yes, briefly explain below	

Other remarks: \_\_\_\_\_

\_\_\_\_\_

\_\_\_\_\_

\_\_\_\_\_

\_\_\_\_\_

\_\_\_\_\_

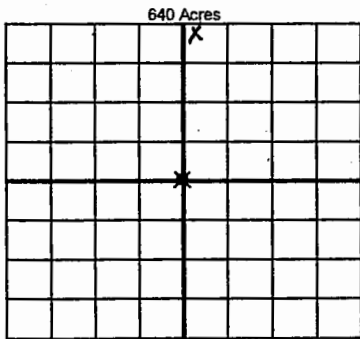

If more than three drainholes are proposed, attach a separate sheet indicating the necessary information.

Direction must be stated in degrees azimuth. Please note, the horizontal drainhole and its end point must be located within the boundaries of the lease or spacing unit.

Directional surveys are required for all drainholes and directional wells

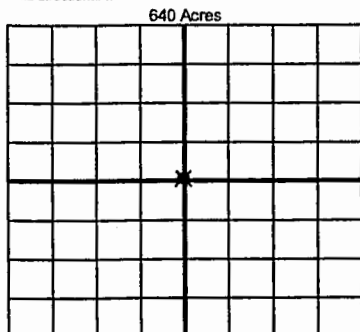

BOTTOM HOLE LOCATION FOR DIRECTIONAL HOLE

SEC	TWP	RGE	COUNTY
1/4	1/4	1/4	1/4
Measured Total Depth		True Vertical Depth	BHL From Lease, Unit, or Property Line:

BOTTOM HOLE LOCATION FOR HORIZONTAL HOLE: (LATERALS)

LATERAL #1			
SEC	TWP	RGE	COUNTY
20	17N	05W	Kingfisher
NW 1/4	NW 1/4	NW 1/4	NE 1/4
Depth of Deviation 5640'		Radius of Turn 1364'	Direction 360 North
Measured Total Depth 11,454'		True Vertical Depth 6271'	Total Length 4450'
		BHL From Lease, Unit, or Property Line: 1'	

LATERAL #2			
SEC	TWP	RGE	COUNTY
1/4	1/4	1/4	1/4
Depth of Deviation		Radius of Turn	Direction
Measured Total Depth		True Vertical Depth	Total Length
		BHL From Lease, Unit, or Property Line:	

LATERAL #3			
SEC	TWP	RGE	COUNTY
1/4	1/4	1/4	1/4
Depth of Deviation		Radius of Turn	Direction
Measured Total Depth		True Vertical Depth	Total Length
		BHL From Lease, Unit, or Property Line:	